

- ACTIVE OIL WELL
- ABANDONED OIL WELL
- ACTIVE GAS WELL
- ABANDONED GAS WELL
- ★ ACTIVE OIL & GAS WELL
- ★ ABANDONED OIL & GAS WELL
- ⊕ DEPT. MARK
- NO RECORD

- COUNTY LINES
- TOWNSHIP LINES
- BOROUGH LINES
- 980 COAL CONTOUR
- CROP LINES - SEAM BEING MINED
- - - CROP LINES - SEAM NOT BEING MINED

Ridgway 2
41°25'
78°35'

78°30'
Caledonia 1
41°25'

RIDGWAY 3

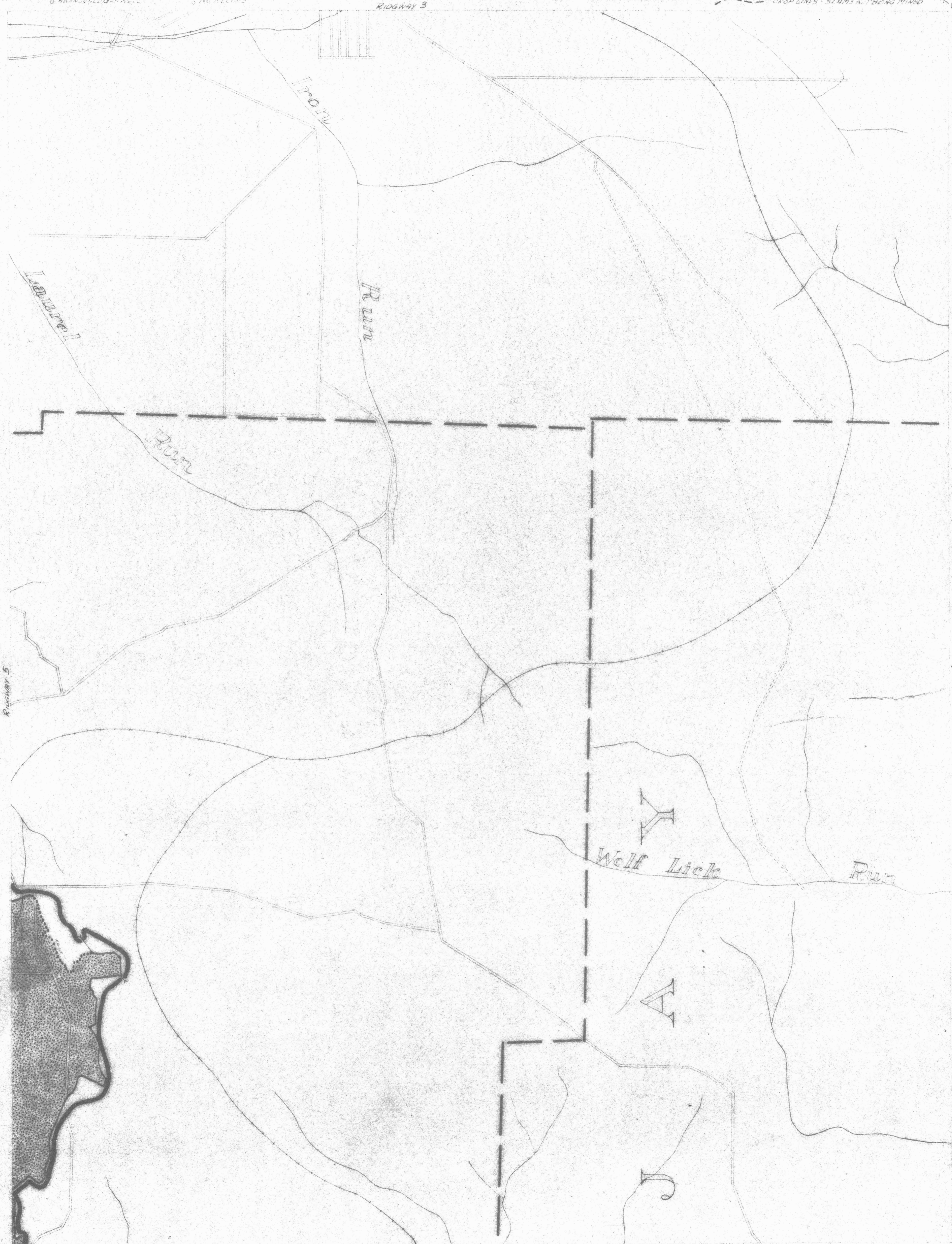

Ridgway 5

Caledonia 4

RIDGWAY 9

Ridgway 8
41°20'
78°35'

41°20'
Caledonia 7
78°30'

- Y DRIFT OPENING
- Z SLOPE OPENING
- SHAFTS
- BASE-LE PILLAR

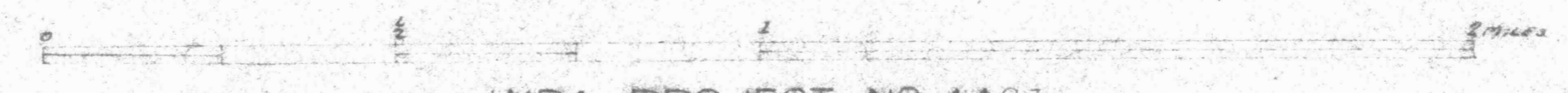

W.P.A. PROJECT NO. 4483

RIDGWAY SHEET No. 6
Lower Kiffanning seam 1K.