

- ACTIVE OIL WELL
- ABANDONED OIL WELL
- \* ACTIVE GAS WELL
- \* ABANDONED GAS WELL
- \* ACTIVE OIL & GAS WELL
- \* ABANDONED OIL & GAS WELL
- ◇ DRY HOLE
- NO RECORD

- COUNTY LINES
- TOWNSHIP LINES
- BOROUGH LINES
- COAL CONTOURS
- CROP LINES - SEAMS BEING MINED
- CROP LINES - SEAMS NOT BEING MINED

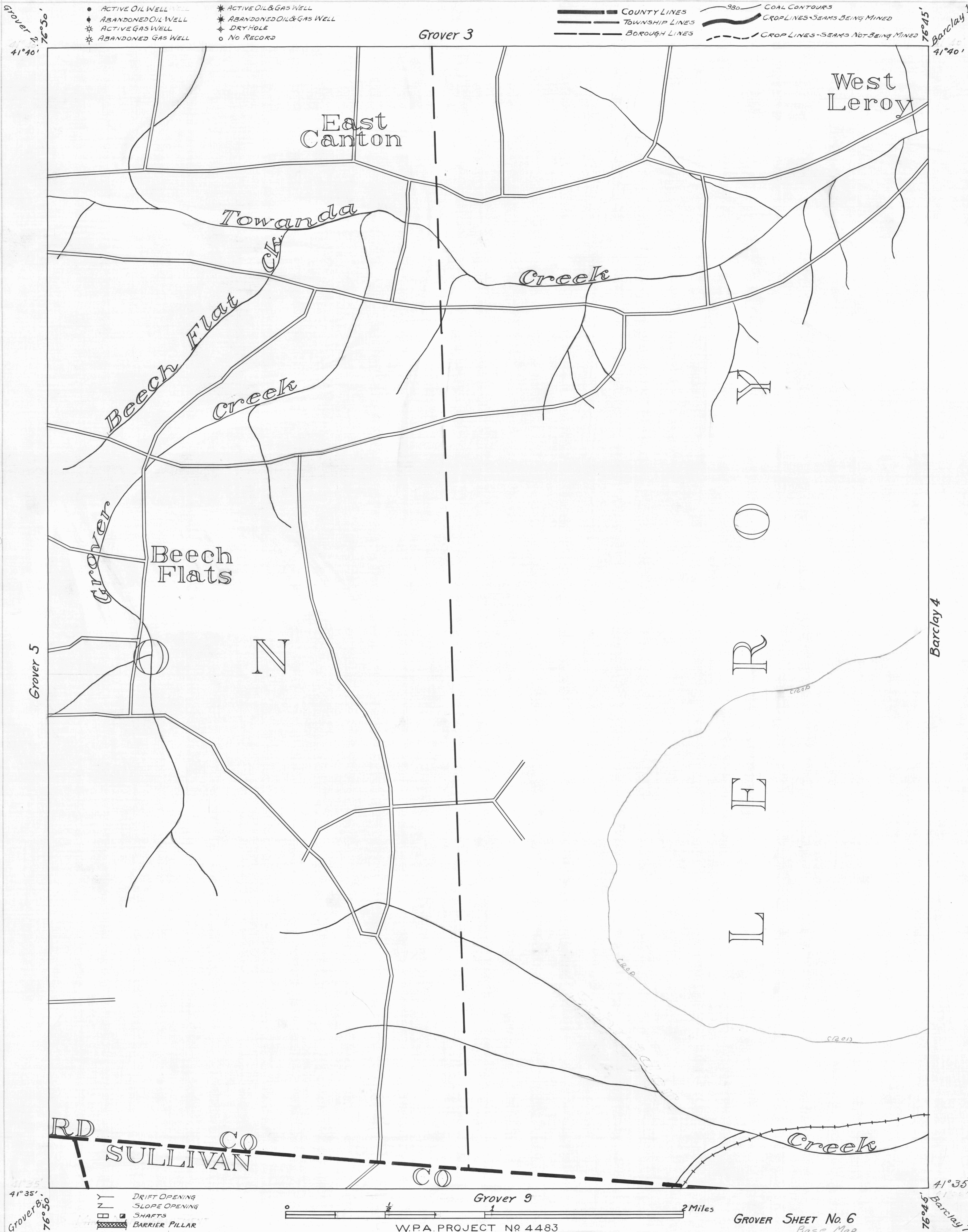

- Y DRIFT OPENING
- Z SLOPE OPENING
- SHAFTS
- ▣ BARRIER PILLAR

Grover 2 76°50' 41°40'

Grover 5

Grover 8 76°50' 41°35'

76°45' 41°40'

Barclay 1

Barclay 4

76°45' 41°35'

Barclay 7