

- ACTIVE OIL WELL
- ◐ ABANDONED OIL WELL
- ✱ ACTIVE GAS WELL
- ✱ ABANDONED GAS WELL

- ✱ ACTIVE OIL & GAS WELL
- ✱ ABANDONED OIL & GAS WELL
- ◇ DRY HOLE
- NO RECORD

- COUNTY LINES
- TOWNSHIP LINES
- BOROUGH LINES

- 980 COAL CONTOURS
- GROPLINES-SEAMS BEING MINED
- - - GROPLINES-SEAMS NOT BEING MINED

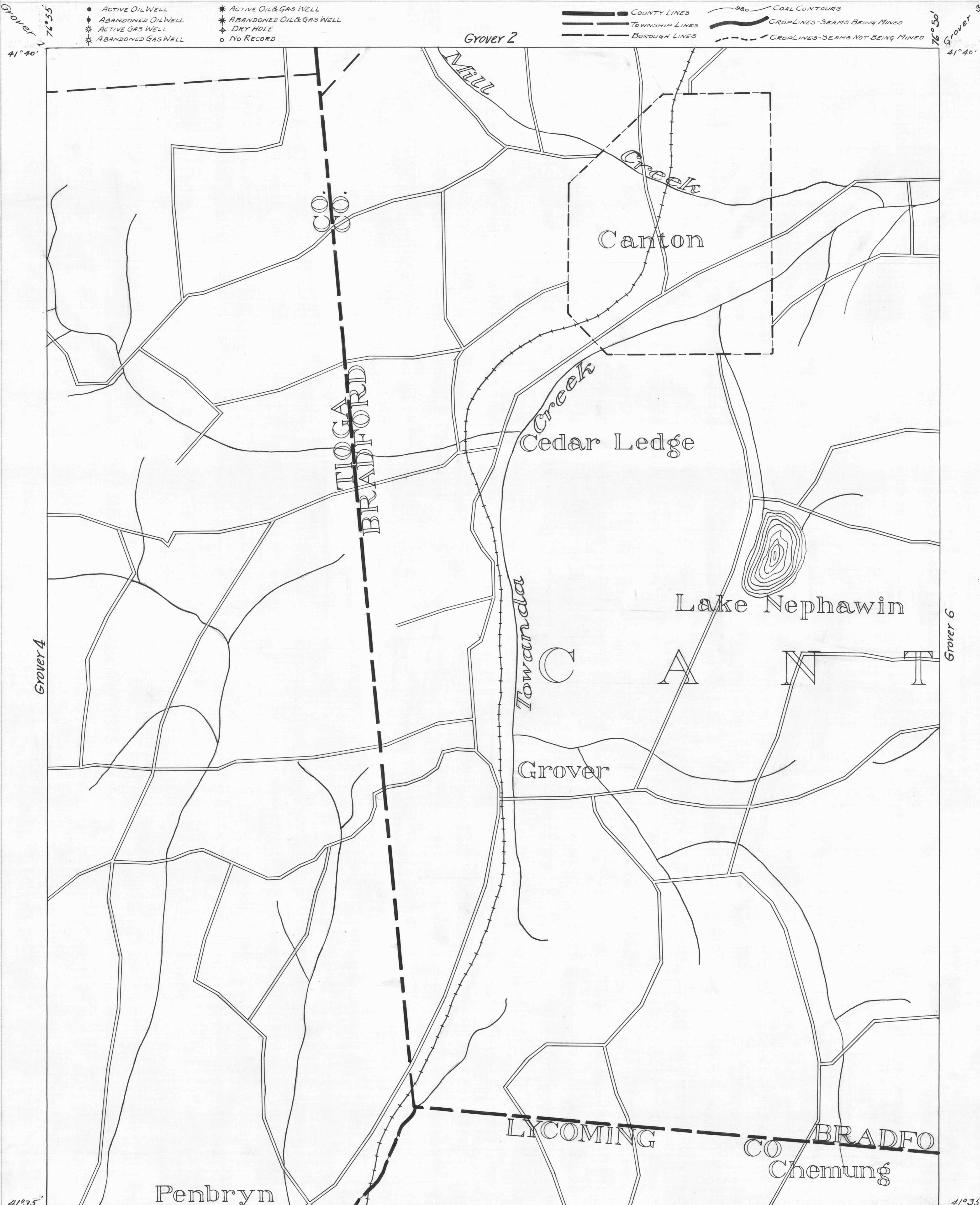

- DRIFT OPENING
- SLOPE OPENING
- SHAFTS
- ▨ BARRIER PILLAR

W.P.A. PROJECT NO. 4483

GROVER SHEET No. 5
Base Map

Grover 1
41° 40'
76° 55'

Grover 4
41° 35'
76° 55'

Grover 3
41° 40'
76° 56'

Grover 6
41° 40'
76° 56'

Grover 8
41° 35'
76° 55'

Grover 9
41° 35'
76° 56'