

Du Bois 5 78°50' 41°05' Du Bois 6 78°45' Penfield 4 41°05'

- ACTIVE OIL WELL
- ◆ ABANDONED OIL WELL
- ⊛ ACTIVE GAS WELL
- ⊙ ABANDONED GAS WELL
- ★ ACTIVE OIL & GAS WELL
- ◆ ABANDONED OIL & GAS WELL
- ⊛ DRY HOLE
- NO RECORD

- COUNTY LINES
- TOWNSHIP LINES
- BOROUGH LINES
- 980 COAL CONTOURS
- CROP LINE - SEAM BEING MINED
- - - CROP LINES - SEAMS NOT BEING MINED

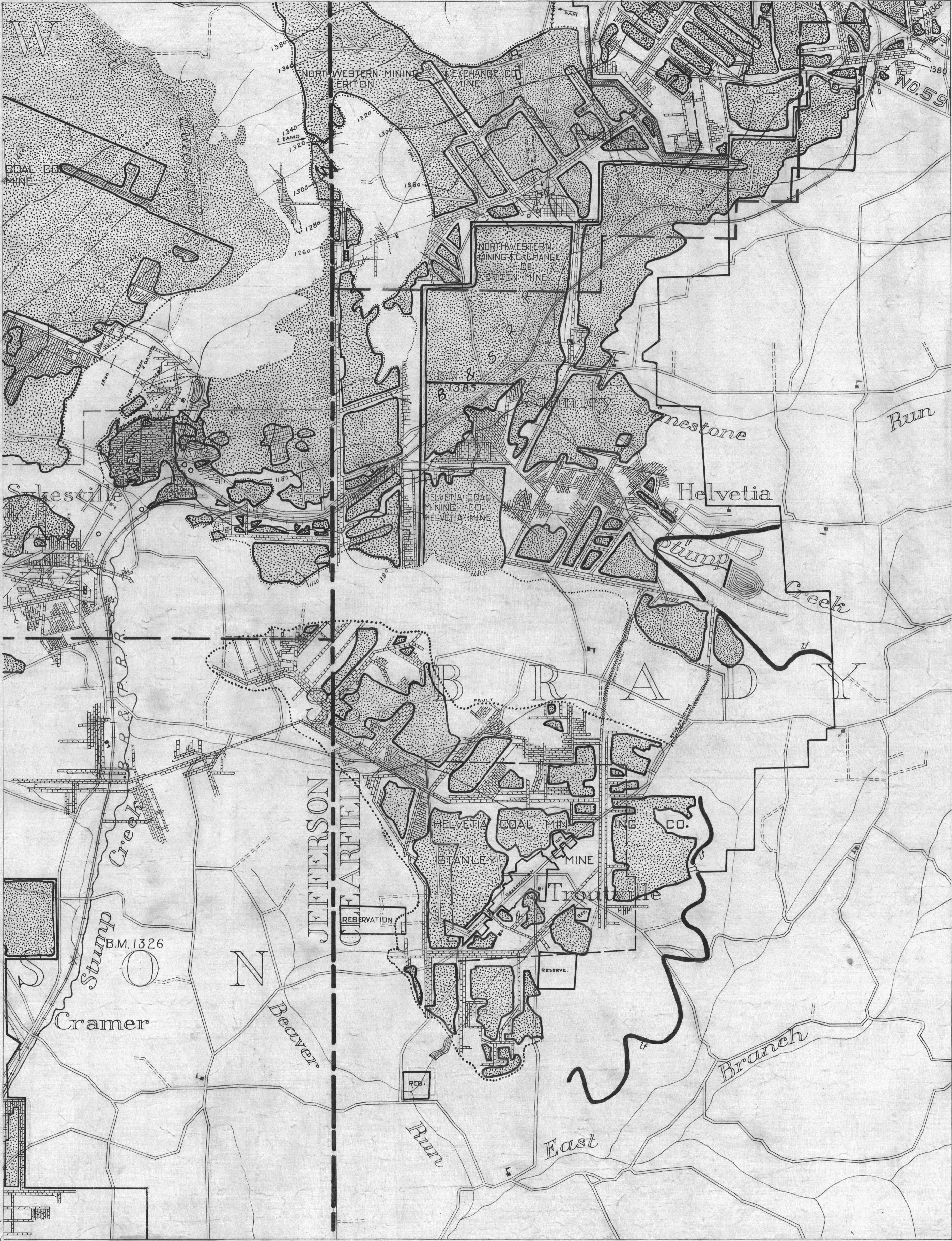

Punxsutawney 2 78°50' 41°00' Punxsutawney 3 78°45' Curwensville 1 41°00'

0 1 2 MILES  
 DU BOIS SHEET No. 9  
 Lower Freeport Seam-If.  
 W.P.A. PROJECT No 4483

- Y DRIFT OPENING
- Z SLOPE OPENING
- SHAFTS
- ▣ BARRIER PILLAR