

CAMBRIA MINING & MANUFACTURING COMPANY

JOHNSTOWN COAL & COKE COMPANY

MAP SHOWING
C SEAM MINES ON PROPERTY
IN
SUMMERHILL & PORTAGE TOWNSHIPS
CAMBRIA COUNTY
PENNSYLVANIA

EXTENDED TO:
SCALE 1"=1000'
CAMBRIA MINE & MFG CO
ARREST SONMAN

C.A. HUGHES & CO

KING'S STORM
4800 AC

PORTAGE No. 10

JOHN RICHMOND No. 1
4500 AC

PORTAGE No. 8

UPPER KITTANNING - FAULTED

PHILIP GEORGE
5740 AC

W. SMITH CO
2950 AC

BOUCHER-CORTRIGHT COAL CO.

315 Acs.
1,575,000 NT
ROSE B. CRICHTON

275 Acs.
1,237,500 NT

WILMORE COAL CO.

UPPER KITTANNING

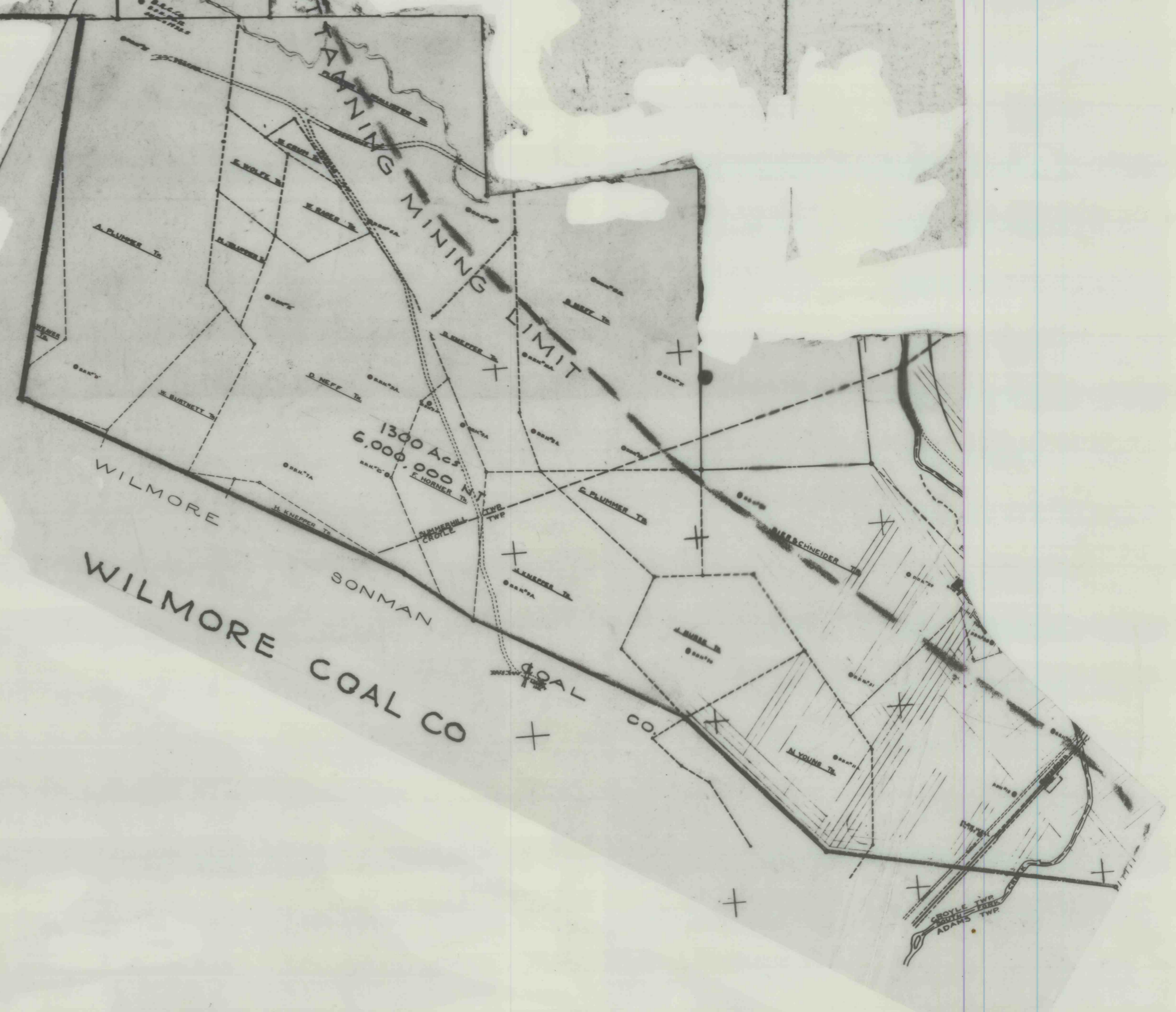

CAMBRIA MINING & MANUFACTURING COMPANY

WILMORE

LOYALHANA COAL & COKE CO.

FAIRHALL COAL CO.