

VOLUME OF STAGE II	144,800 CY
MAXIMUM TIME TO COMPLETE	16.1 MONTHS
MAXIMUM TOTAL TIME (FROM BEGINNING OF STARTER DIKE)	25.4 MONTHS

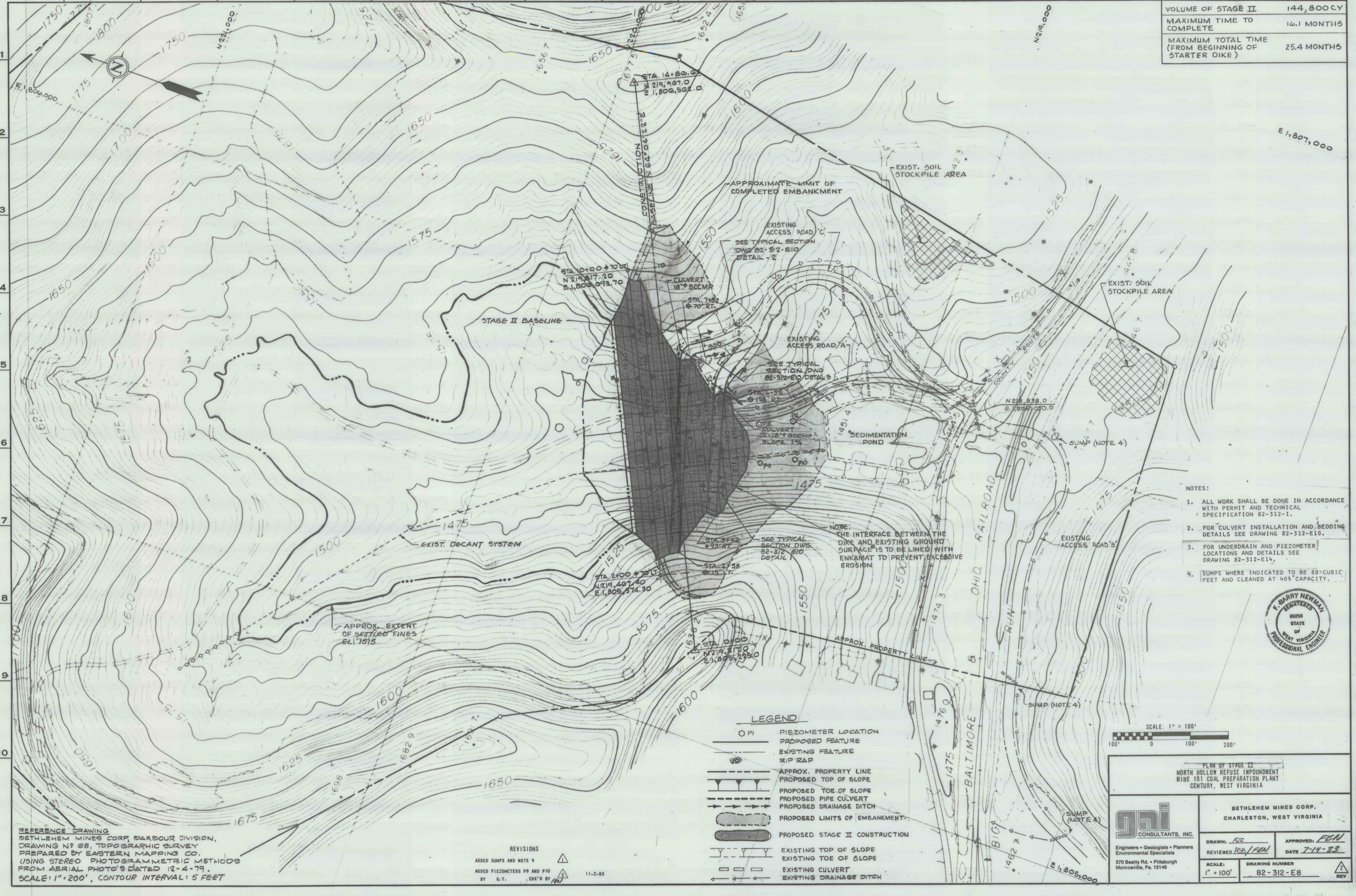

- NOTES:
1. ALL WORK SHALL BE DONE IN ACCORDANCE WITH PERMIT AND TECHNICAL SPECIFICATION 82-312-1.
 2. FOR CULVERT INSTALLATION AND BEDDING DETAILS SEE DRAWING 82-312-E10.
 3. FOR UNDERDRAIN AND PIEZOMETER LOCATIONS AND DETAILS SEE DRAWING 82-312-E14.
 4. SUMPS WHERE INDICATED TO BE 80 CUBIC FEET AND CLEANED AT 40% CAPACITY.

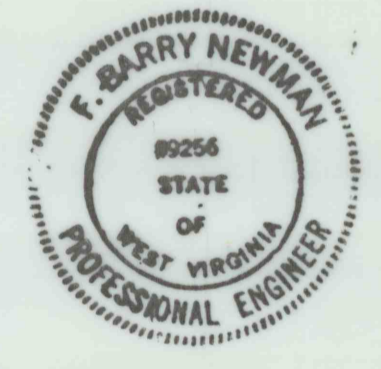

LEGEND

	PIEZOMETER LOCATION
	PROPOSED FEATURE
	EXISTING FEATURE
	RIP RAP
	APPROX. PROPERTY LINE
	PROPOSED TOP OF SLOPE
	PROPOSED TOE OF SLOPE
	PROPOSED PIPE CULVERT
	PROPOSED DRAINAGE DITCH
	PROPOSED LIMITS OF EMBANKMENT
	PROPOSED STAGE II CONSTRUCTION
	EXISTING TOP OF SLOPE
	EXISTING TOE OF SLOPE
	EXISTING CULVERT
	EXISTING DRAINAGE DITCH

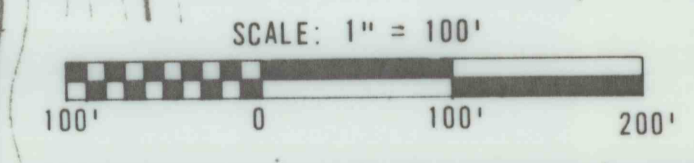

PLAN OF STAGE II
NORTH HOLLOW REFUSE IMPOUNDMENT
MINE 101 COAL PREPARATION PLANT
CENTURY, WEST VIRGINIA

gai
CONSULTANTS, INC.
Engineers • Geologists • Planners
Environmental Specialists
570 Beatty Rd. • Pittsburgh
Monroeville, Pa. 15146

BETHLEHEM MINES CORP.
CHARLESTON, WEST VIRGINIA

DRAWN: <i>ESC</i>	APPROVED: <i>FEN</i>
REVIEWED: <i>ASB/FEN</i>	DATE: 7-14-83
SCALE: 1" = 100'	DRAWING NUMBER: 82-312-E8

REFERENCE DRAWING
BETHLEHEM MINES CORP. BARBOUR DIVISION,
DRAWING N° 68, TOPOGRAPHIC SURVEY
PREPARED BY EASTERN MAPPING CO.
USING STEREO PHOTOGRAMMETRIC METHODS
FROM AERIAL PHOTO'S DATED 12-4-79.
SCALE: 1" = 200', CONTOUR INTERVAL: 5 FEET

REVISIONS

ADDED SUMPS AND NOTE 4

ADDED PIEZOMETERS P9 AND P10
BY G.Y. CHK'D BY *FEN*

11-2-83