

CURVE DATA					
ROAD	CURVE	Δ	R	T	Δ
C	①	37°14'14"	492.66'	152.50'	294.19'
C	②	126°30'00"	150.00'	297.59'	331.18'

VOLUME OF STAGE I	55,600 CY
MAXIMUM TIME TO COMPLETE	6.3 MONTHS
MAXIMUM TOTAL TIME (FROM BEGINNING OF STARTER DIKE)	9.3 MONTHS

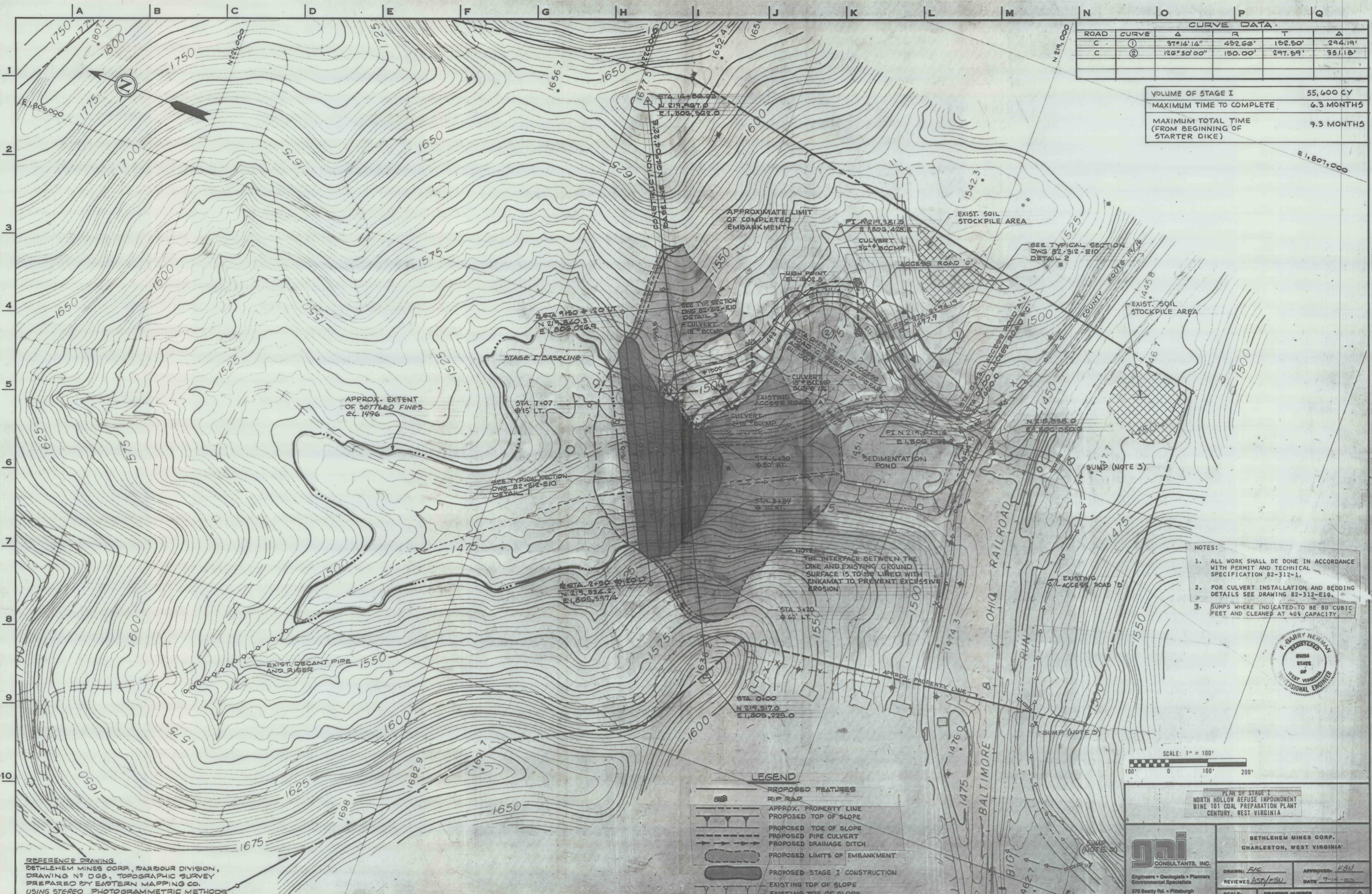

- NOTES:
1. ALL WORK SHALL BE DONE IN ACCORDANCE WITH PERMIT AND TECHNICAL SPECIFICATION 82-312-1.
 2. FOR CULVERT INSTALLATION AND BEDDING DETAILS SEE DRAWING 82-312-E10.
 3. SUMPS WHERE INDICATED TO BE 80 CUBIC FEET AND CLEANED AT 40% CAPACITY.

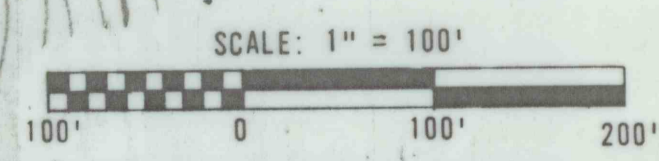

LEGEND

	PROPOSED FEATURES
	RIP RAP
	APPROX. PROPERTY LINE
	PROPOSED TOP OF SLOPE
	PROPOSED TOE OF SLOPE
	PROPOSED PIPE CULVERT
	PROPOSED DRAINAGE DITCH
	PROPOSED LIMITS OF EMBANKMENT
	PROPOSED STAGE I CONSTRUCTION
	EXISTING TOP OF SLOPE
	EXISTING TOE OF SLOPE
	EXISTING CULVERT
	EXISTING DRAINAGE DITCH

REFERENCE DRAWING:
 BETHLEHEM MINES CORP., BARBOUR DIVISION,
 DRAWING N3 DGB, TOPOGRAPHIC SURVEY
 PREPARED BY EASTERN MAPPING CO.
 USING STEREO PHOTOGRAMMETRIC METHODS
 FROM AERIAL PHOTOS DATED 12-4-79.

PLAN OF STAGE I
 NORTH HOLLOW REFUSE IMPOUNDMENT
 MINE 101 COAL PREPARATION PLANT
 CENTURY, WEST VIRGINIA

gai
 CONSULTANTS, INC.
 Engineers • Geologists • Planners
 Environmental Specialists
 570 Beatty Rd. • Pittsburgh
 Monroeville, Pa. 15146

BETHLEHEM MINES CORP.
 CHARLESTON, WEST VIRGINIA

DRAWN: *FVG* APPROVED: *FBN*
 REVIEWED: *ASD/KBL* DATE: 7-14-82

SCALE: 1" = 100' DRAWING NUMBER: 82-312-E7