

FIT TO #2

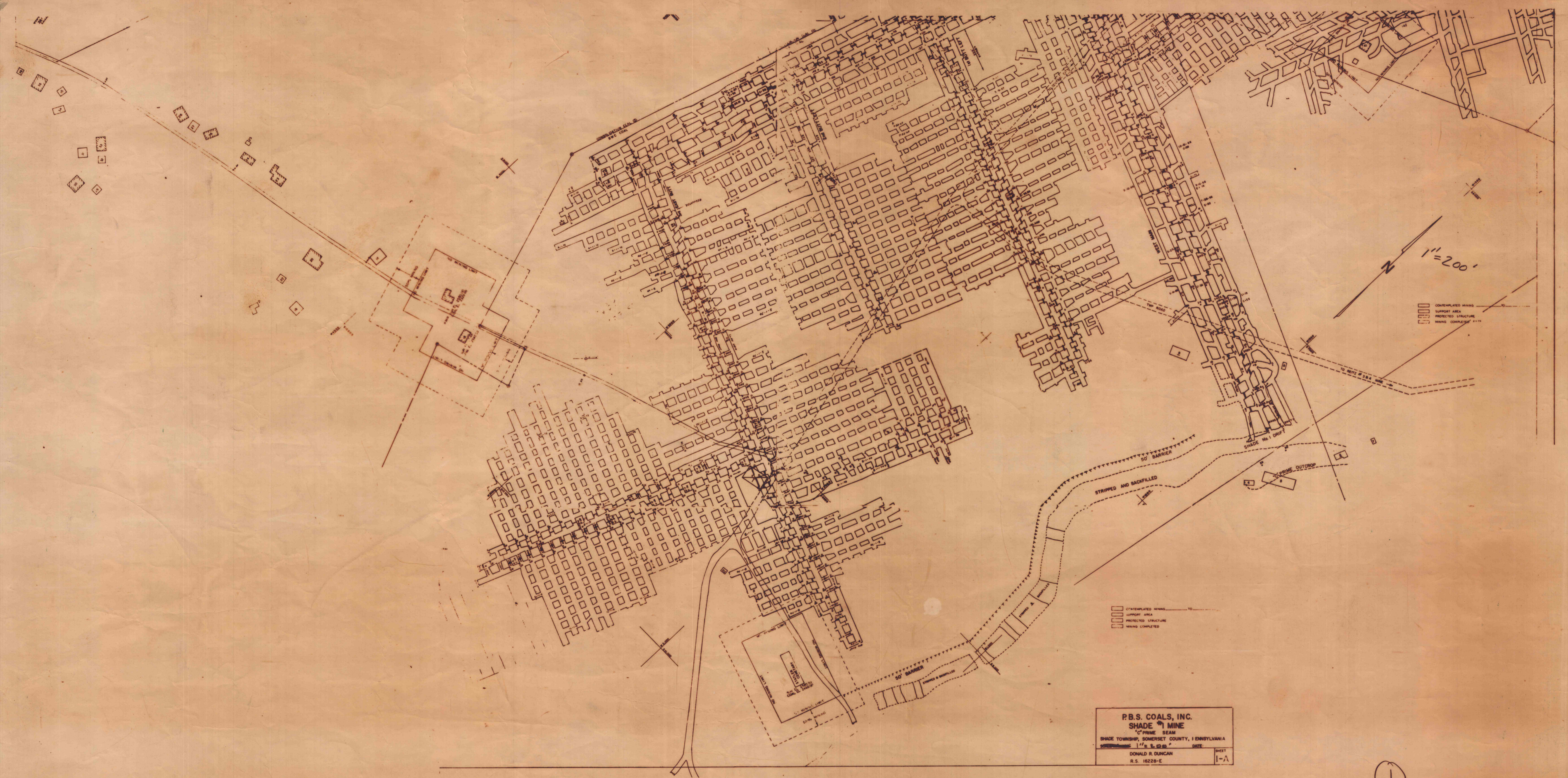

1"=200'

□ CONTEMPLATED MINING
 □ SUPPORT AREA
 □ PROTECTED STRUCTURE
 □ MINING COMPLETED

□ CONTEMPLATED MINING
 □ SUPPORT AREA
 □ PROTECTED STRUCTURE
 □ MINING COMPLETED

P.B.S. COALS, INC.
SHADE #1 MINE
 "C" PRIME SEAM
 SHADE TOWNSHIP, SOMERSET COUNTY, PENNSYLVANIA
 174 & 1828
 DONALD R. DUNCAN
 R.S. 1828-E

①
Sheet 1 of 2