

**LAUREL MINE
SEAM ROCK MAP
SOMERSET CO., PA.**

SCALE: 1"=500'

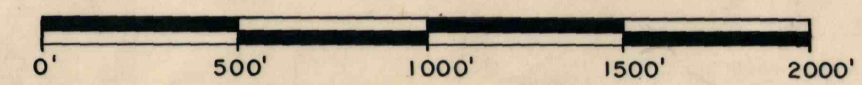

PREPARED BY: SUSAN OLMSTEAD
DRAWN BY: VICKIE B. RICHARDS
DATE SEPT. 15, 1978

LEGEND

- MINE WORKS
- - - MINE BOUNDARY
- RG-75 ROTARY HOLE
- SF-25 CORED HOLE
- 10 — ISO-% ROCK

- Greater than 75% ROCK IN THE SEAM
- Less than 75% and Greater than 50% ROCK IN THE SEAM
- Less than 50% and Greater than 25% ROCK IN THE SEAM

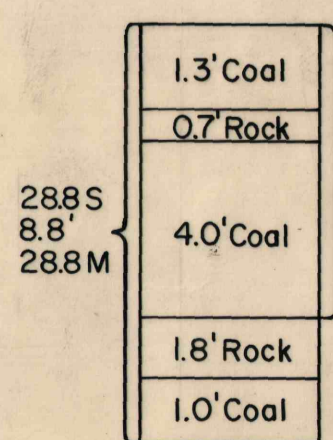

28.8 S - This is the percent of rock in the total seam taken from E-log or core log.
 11.6 m - This is the percent of rock in the seam if the seam is mined at the optimum mining height. (i.e. mining at least 6' of the section of seam with the least rock)
 28.8 M - This is the percent of rock in the seam as it was mined. Taken from the channel sample logs or rock and coal height reports.

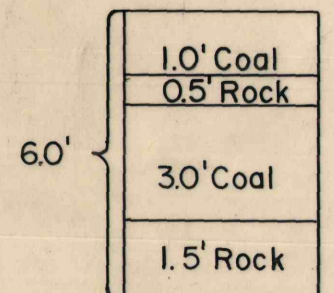

The iso-lines are drawn assuming the optimum mining height. The rock calculations were made assuming a minimum 6' entry. In places where the seam is less than 6' in height, the difference was added to the seam rock and calculated on a 6' mining height.