

CORRELATION CROSS-SECTION
SCALE: HORIZ. 1"=600'
VERT. 1"=600'



CROSS-SECTION LOCATION MAP
SCALE: 1"=2,000'

JENNERSTOWN DEEP UPPER FREEPORT
WEIGHTED QUALITY 1.60 PLOW DRY BASIS

| % WT | ASH | SULFUR | BTU | W/L | F.C. | FSI |
|-------|-------|--------|--------|-------|-------|-------|
| 85.60 | 11.66 | 1.05 | 13,797 | 21.68 | 66.65 | 8-1/2 |

UPPER FREEPORT RESERVE SUMMARY

| | Total Recoverable Coal Acres | Coal Thk. | Total Tons Clean Coal (000) | Consol. Tons Clean Coal (000) |
|--------------|------------------------------|-----------|-----------------------------|-------------------------------|
| Consol. Coal | 2,962.6 | 3.70' | 8,246.0 | 8,246.0 |
| Adverse Coal | 31.0 | 3.70' | 86.0 | 0.0 |
| Grand Total | 2,993.6 | 3.70' | 8,332.0 | 8,246.0 |

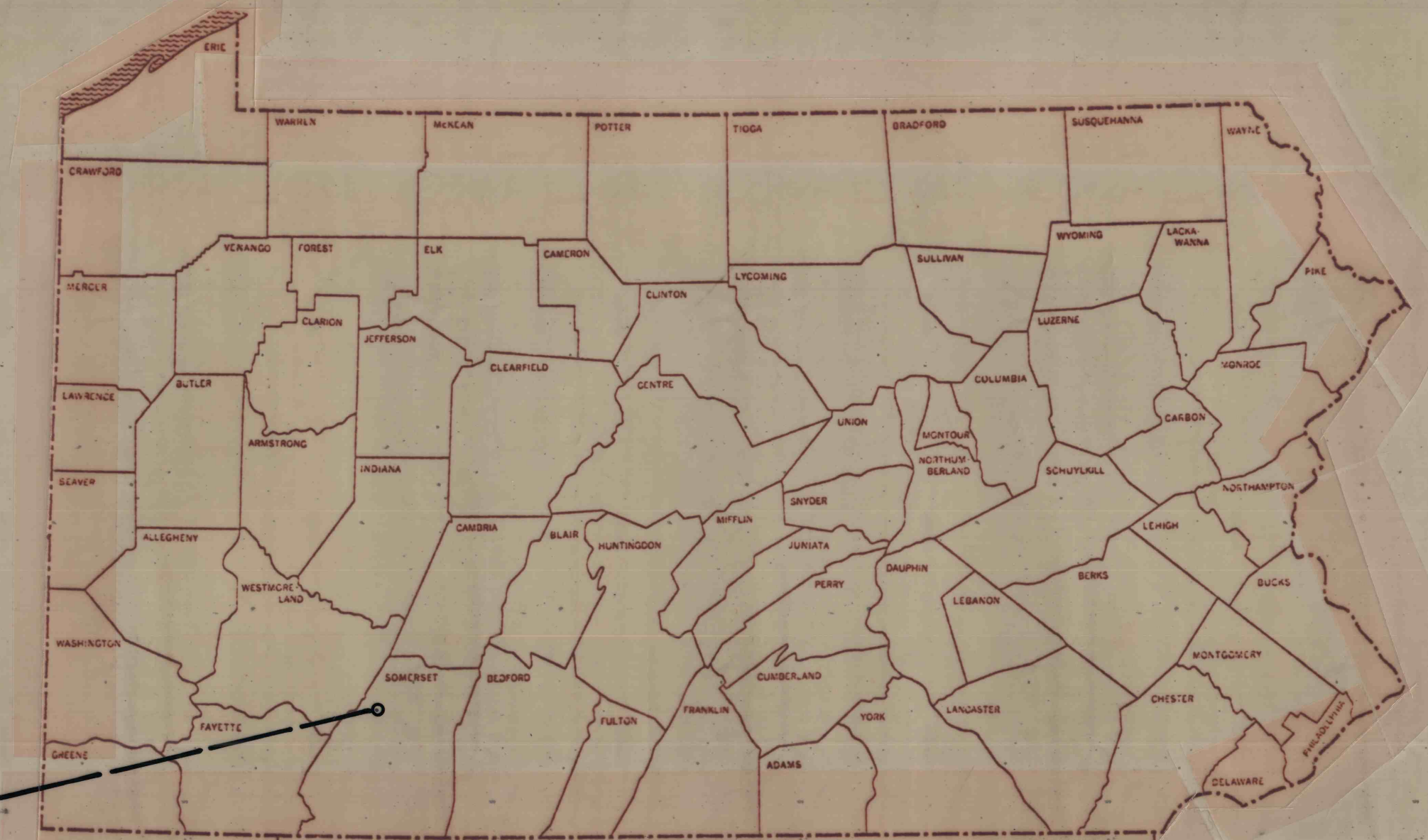
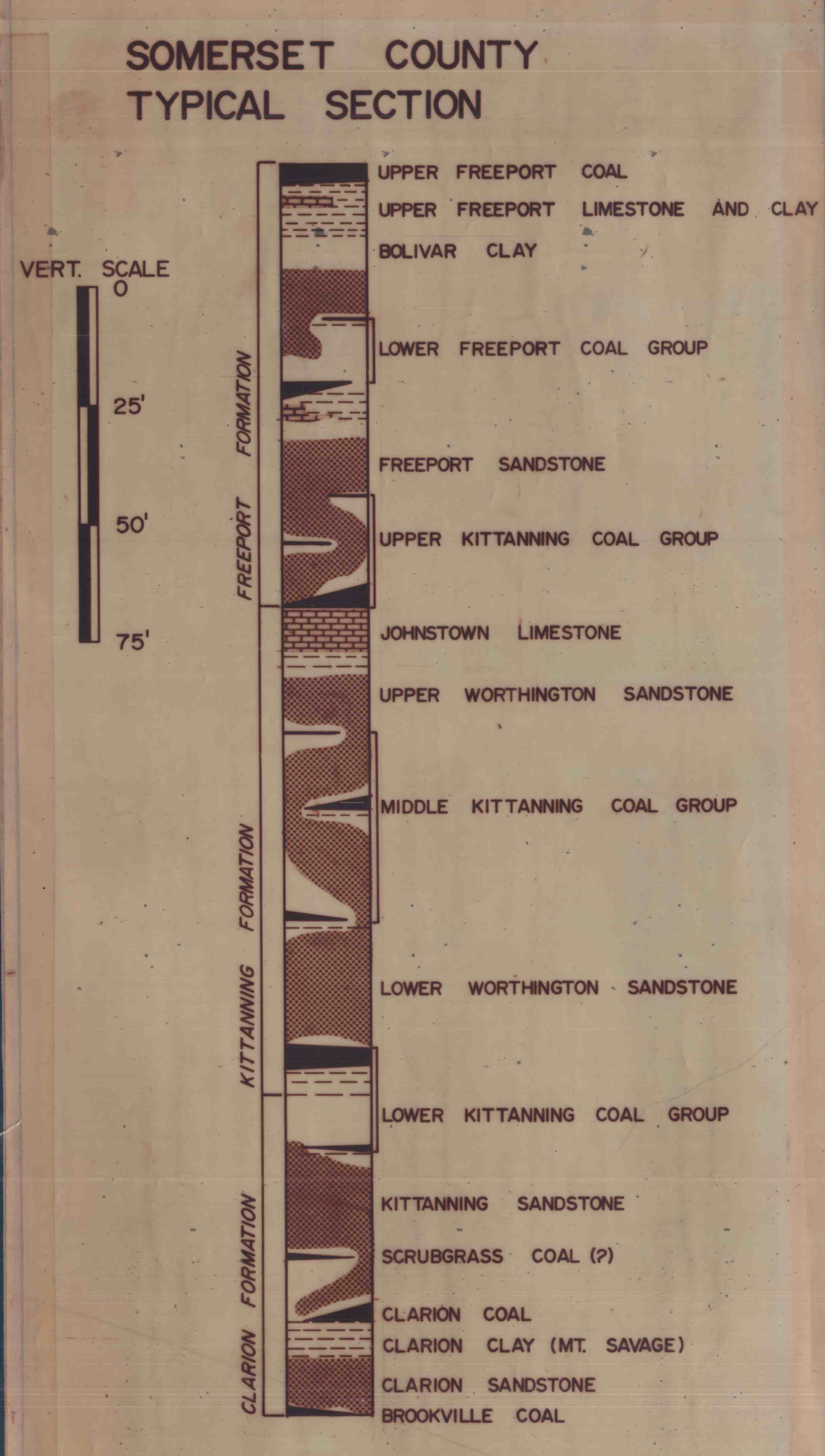

REFERENCES
Land data was compiled from Pittsburgh Coal Company Division files.
Geologic data was compiled from, Pennsylvania State Geologic Survey information, old mine workings maps and JN-Series drill hole data from Pittsburgh Coal Co., and JF-Series holes from Northern Appalachian Exploration files.
The topographic base is published by the U.S.C.S. Control is by the U.S.G.S. and U.S.C. & G.S. Topography is taken from photogrammetric methods from aerial photographs taken in 1967. Field checked in 1967. Polysonic projection, 1927 North American datum, Zone 1000 - meter Universal Mercator grid ticks.
Map updated by aerial survey 1973.

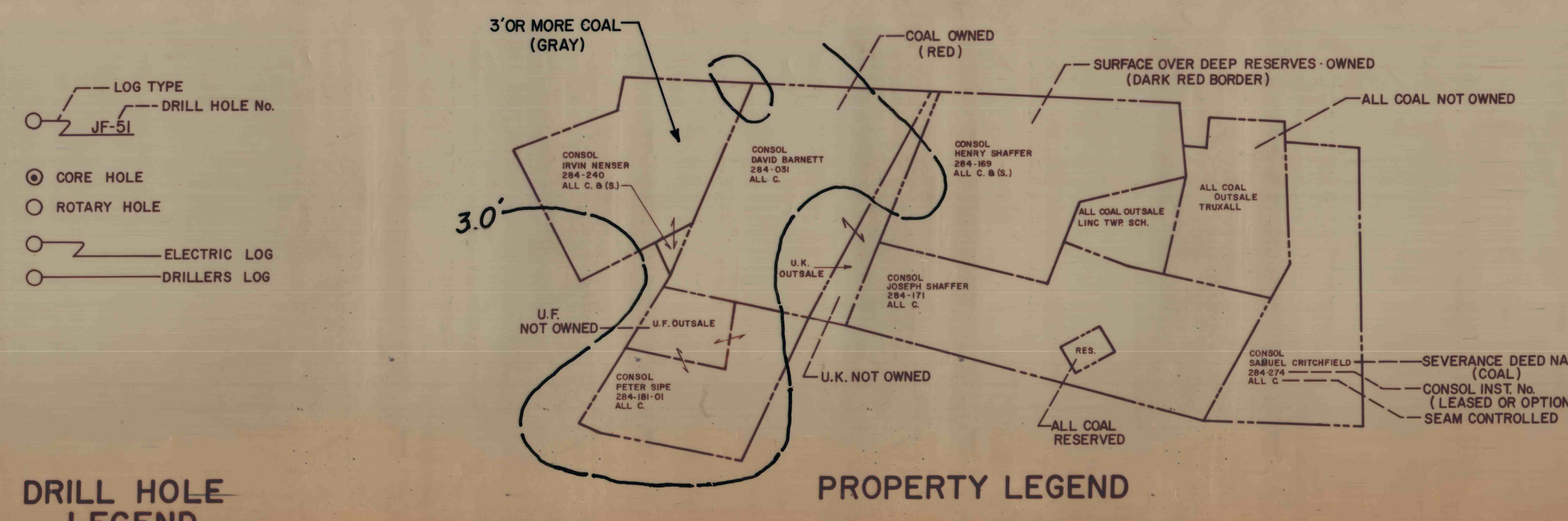
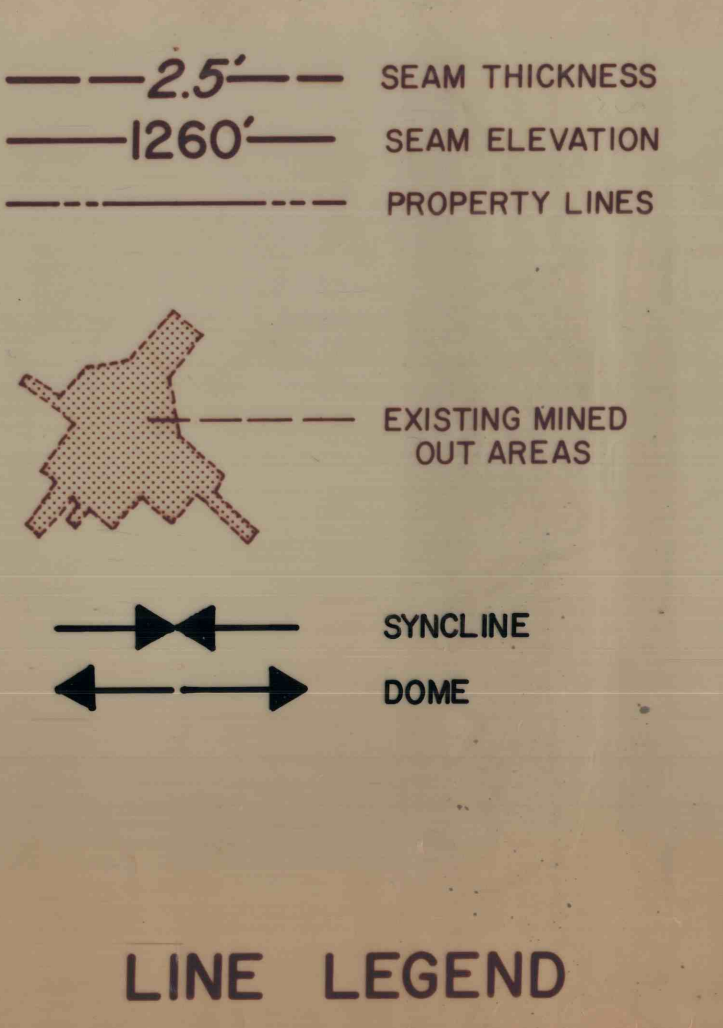

CONSOL Northern Appalachian Exploration Office

JENNERSTOWN DEEP UPPER FREEPORT

Scale: 1"=1000'

Date: SEPT. 1976
Designed by: G. YURCHICK
Drawn by: W. ASHBROOK