

CORRELATION CROSS-SECTION  
SCALE: HORIZ. 1/400'  
VERT. 1/400'



CROSS-SECTION LOCATION MAP  
SCALE: 1"=2,000'

JENNERSTOWN DEEP UPPER KITTANNING  
WEIGHTED QUALITY 1.60 PLSM BY BASIS

| % WT  | ASH   | SULFUR | SHU    | VEL   | P.C.  | FSI   |
|-------|-------|--------|--------|-------|-------|-------|
| 82.60 | 10.84 | 1.55   | 13,959 | 21.29 | 67.98 | 8-1/2 |

UPPER KITTANNING  
RESERVE SUMMARY

|              | Total Recoverable<br>Coal Acres | Coal<br>Tbk. | Total Tons<br>Clean Coal<br>(000) | Consol Tons<br>Clean Coal<br>(000) |
|--------------|---------------------------------|--------------|-----------------------------------|------------------------------------|
| Consol Coal  | 4,006.0                         | 4.0          | 11,443.0                          | 11,443.0                           |
| Adverse Coal | 47.8                            | 3.8          | 129.0                             | 0.0                                |
| Grand Total  | 4,053.7                         | 4.0          | 11,573.0                          | 11,443.0                           |

SOMERSET COUNTY  
TYPICAL SECTION

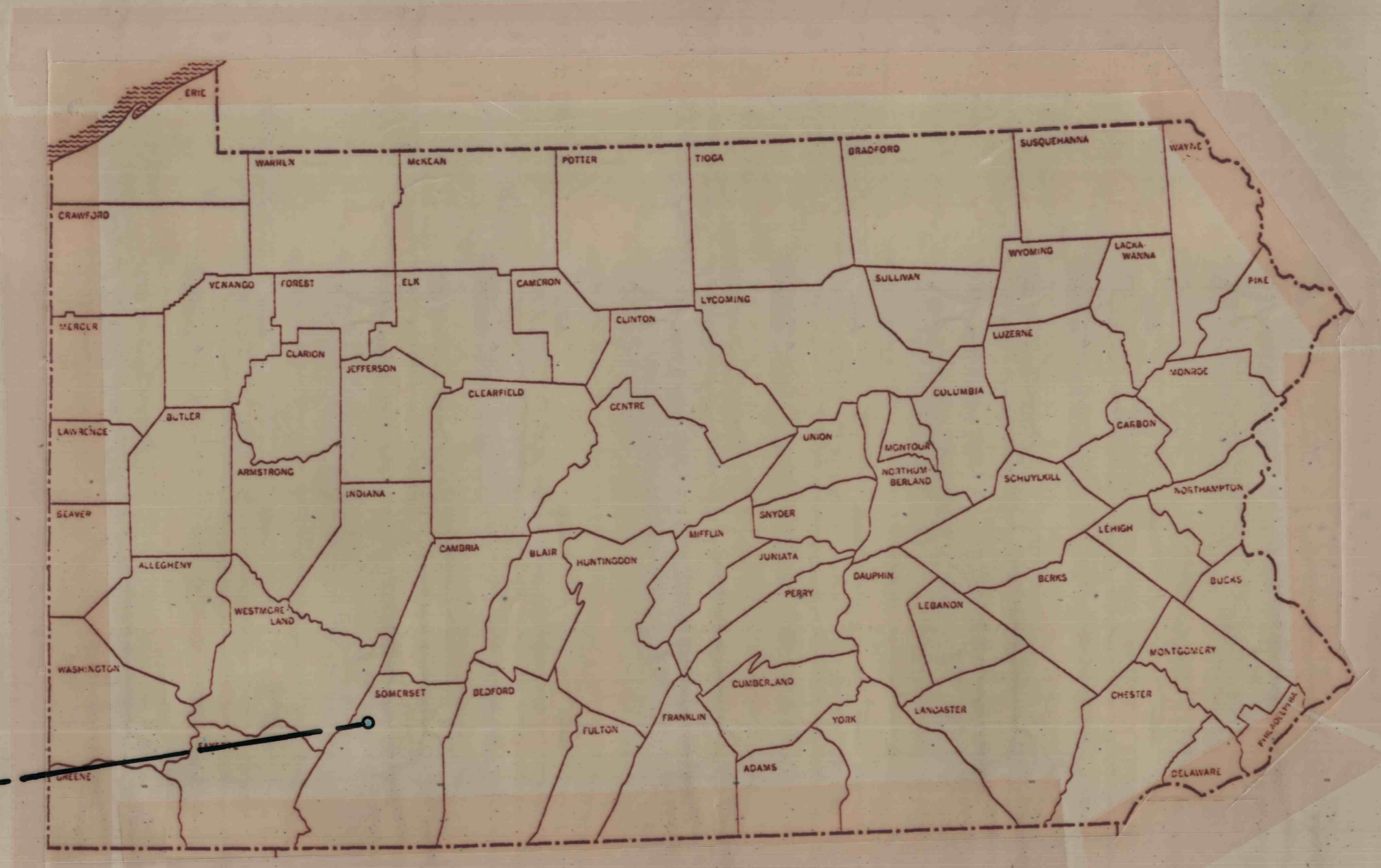
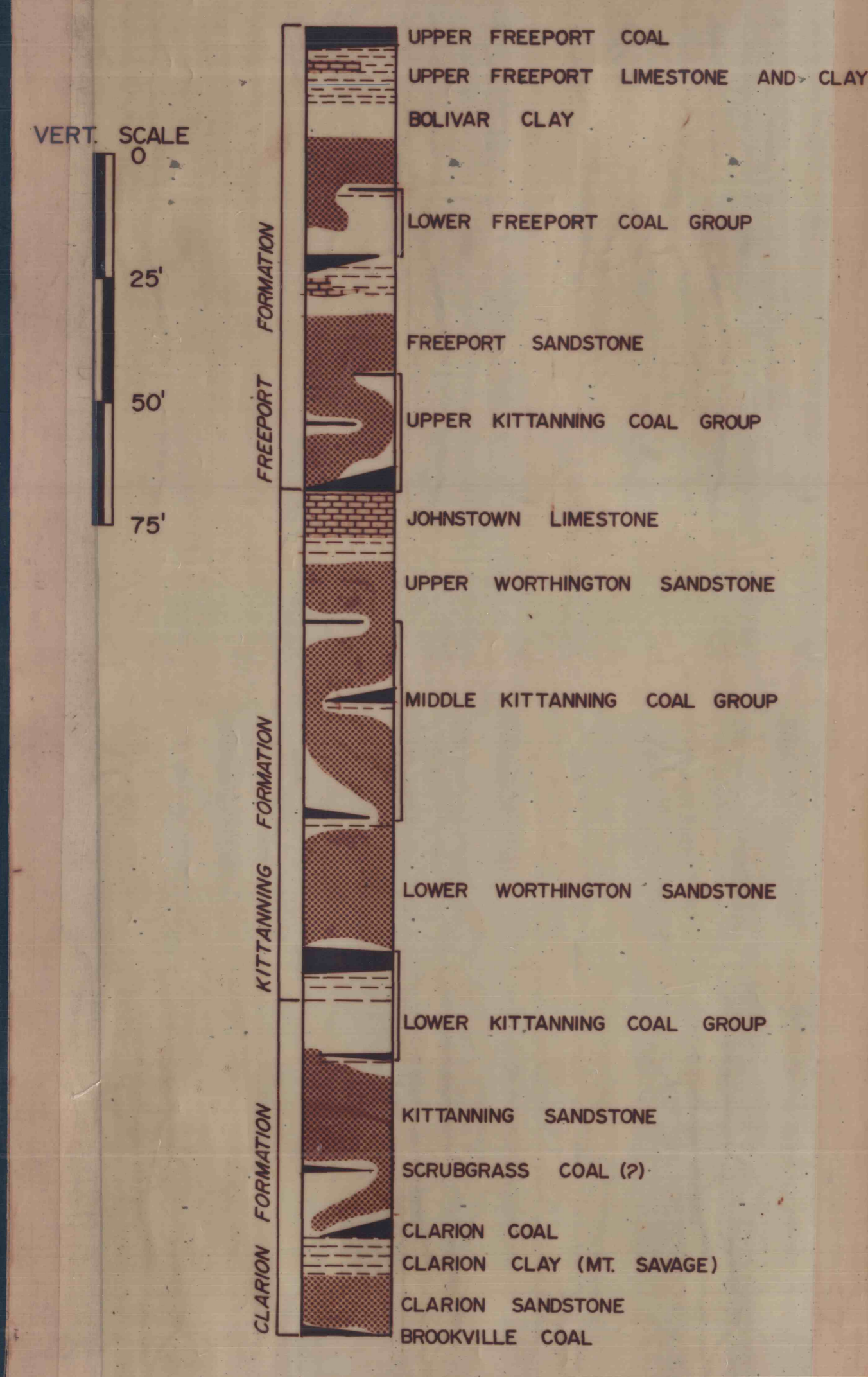

REFERENCES  
Land data was compiled from Pittsburgh Coal Company Division files.  
Geologic data was compiled from, Pennsylvania State Geologic Survey information, old mine workings maps and JN-Series drill hole data from Pittsburgh Coal Co., and JF-Series holes from Northern Appalachian Exploration files.  
The topographic base is published by the U.S.C.S. Control is by the U.S.G.S. and U.S.C. & G.S. Topography is taken from photogrammetric methods from aerial photographs taken in 1967. Field checked in 1967. Polyonic projection, 1927 North American datum, Zone 1000 - meter Universal Mercator grid ticks.  
Map updated by aerial survey 1973.

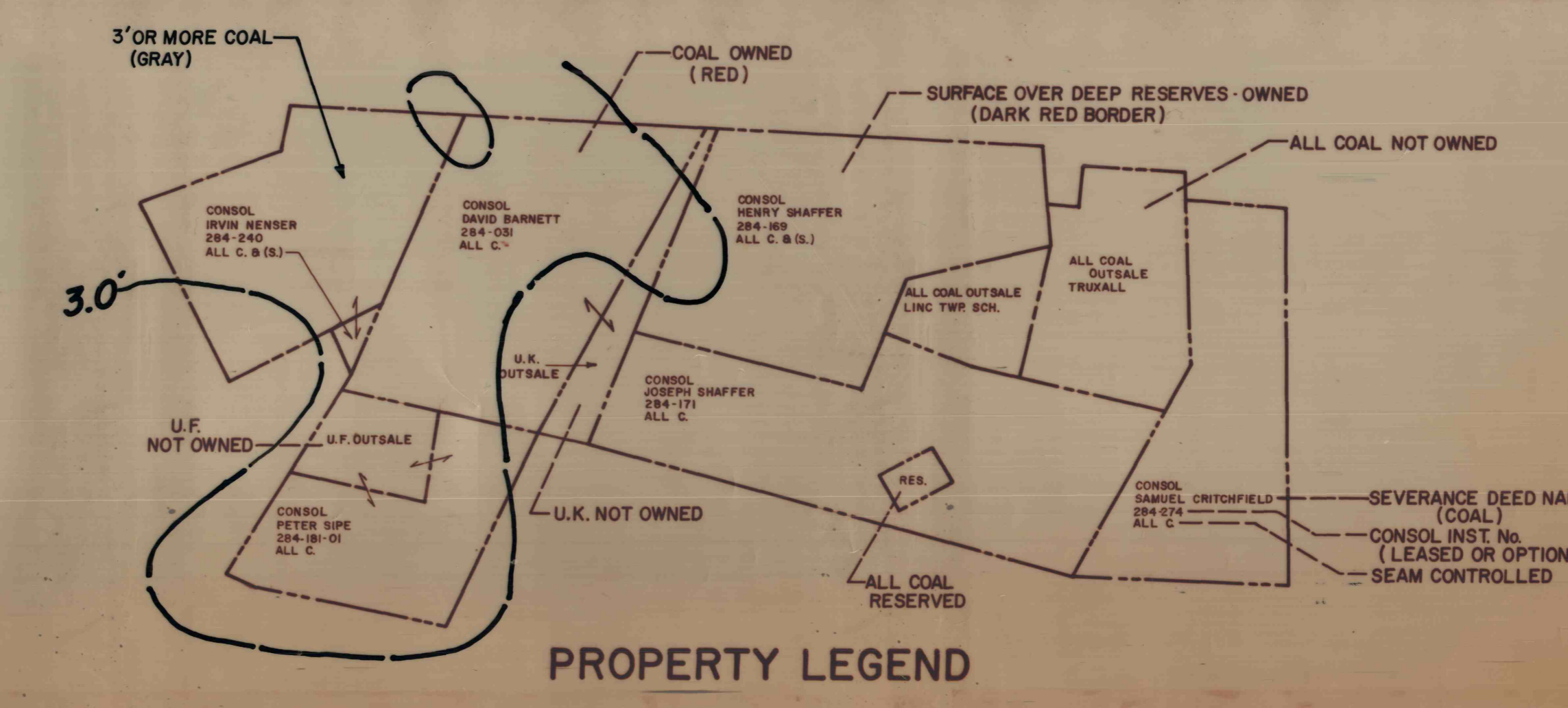
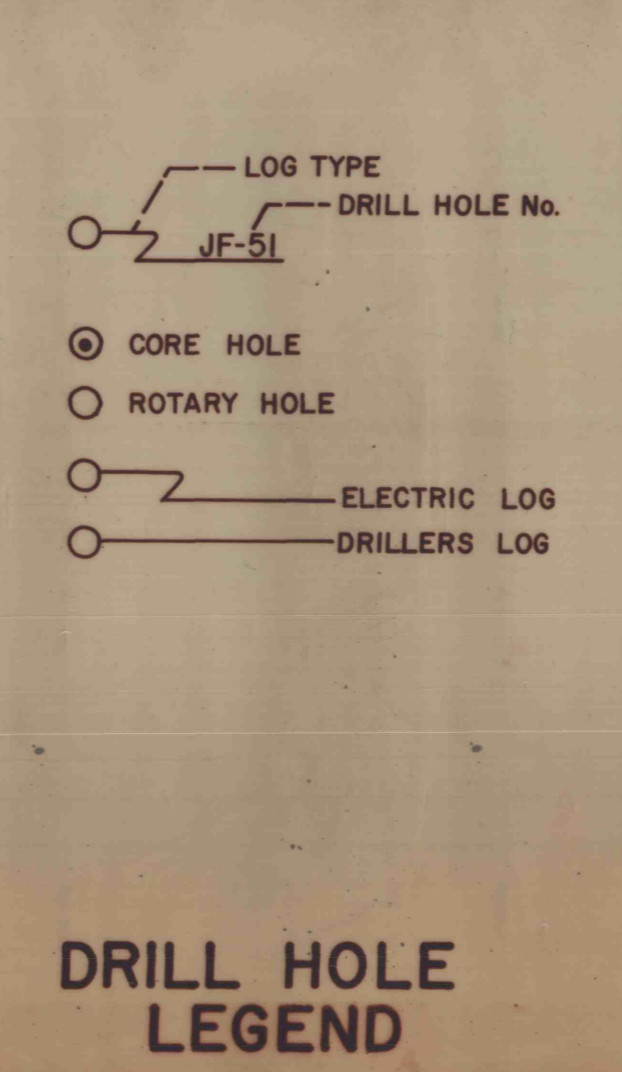
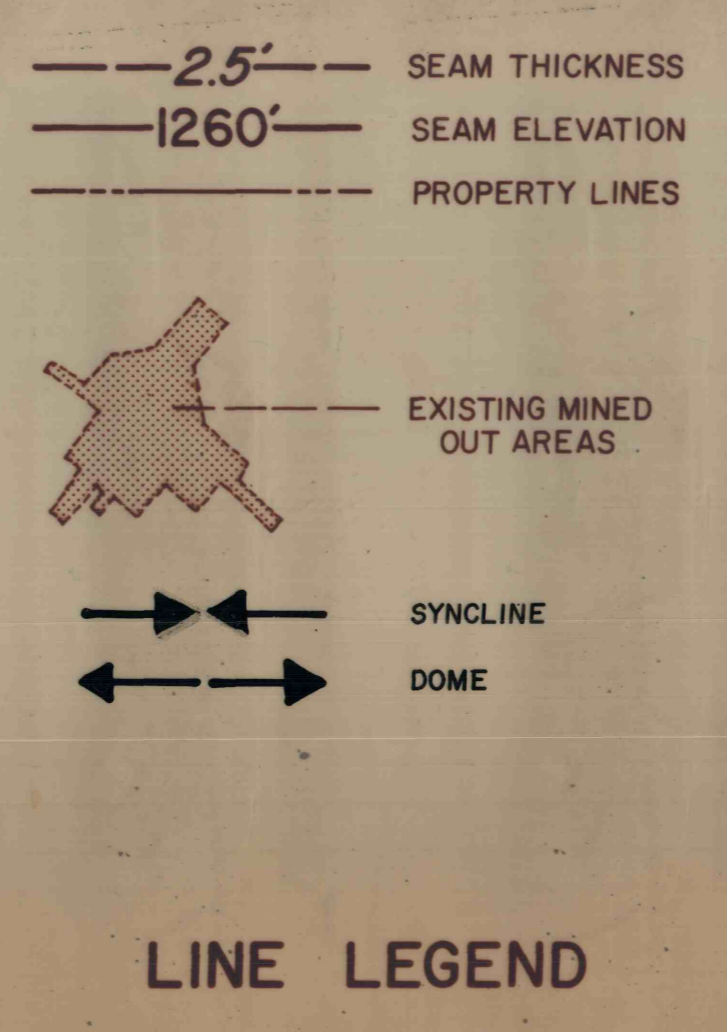

Northern Appalachian Exploration Office

**JENNERSTOWN DEEP  
UPPER KITTANNING**

Scale: 1"=1,000'

Date: SEPT. 1976  
Designed By: C. YURCHICK  
Drawn By: W. ASHBROOK