

MAP

Of the Borough
of
MANOR
Westmoreland Co.
Penna.

SCALE 1" = 80'

J. J. JANEWAY C.E.
TR. T. FINNIE

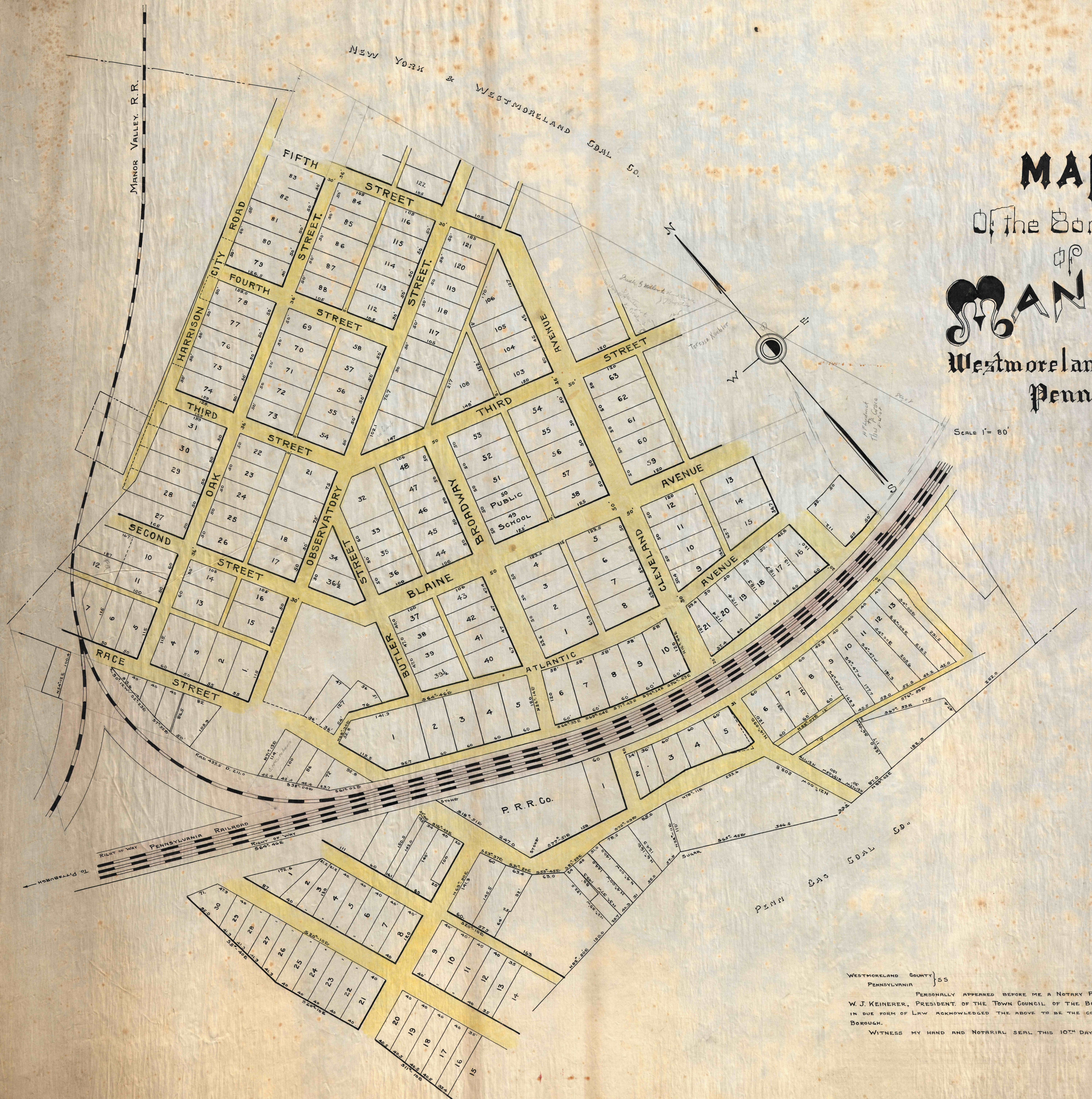

WESTMORELAND COUNTY } SS
PENNSYLVANIA }
PERSONALLY APPEARED BEFORE ME A NOTARY PUBLIC IN & FOR SAID COUNTY
W. J. KEINERER, PRESIDENT OF THE TOWN COUNCIL OF THE BOROUGH OF MANOR PA, AND
IN DUE FORM OF LAW ACKNOWLEDGED THE ABOVE TO BE THE CORRECT PLAN OF THE AFORESAID
BOROUGH.
WITNESS MY HAND AND NOTARIAL SEAL THIS 10TH DAY OF AUGUST A.D. 1895
E. H. BAIR
NOTARY PUBLIC