

**PLAN VIEW**  
SCALE 1" = 10'

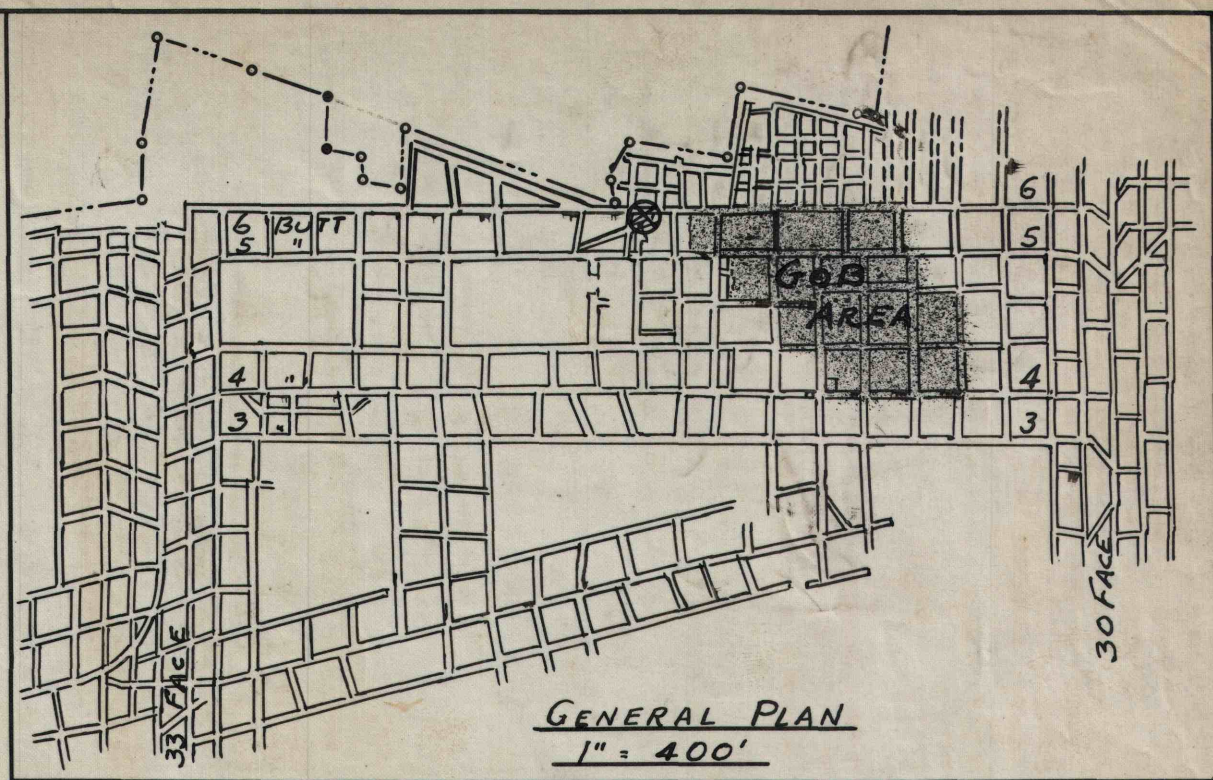

**GENERAL PLAN**  
1" = 400'

VICTIM FOUND HERE

DOTTED AREA INDICATES POSITION OF ROOF BEFORE FALL

PIECE OF ROOF APPROX. 5'x9'x0.10" WHICH FELL, CRUSHING VICTIM.

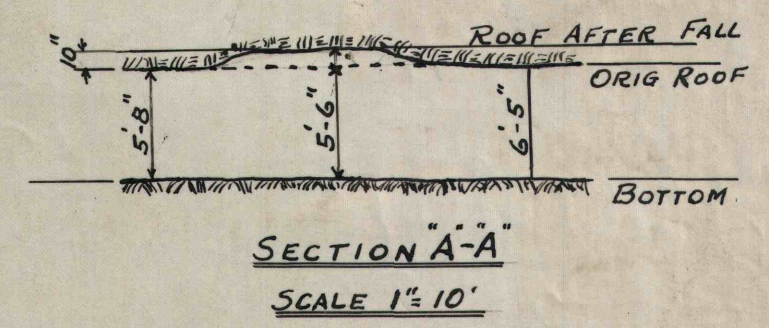

**SECTION "A-A"**  
SCALE 1" = 10'

**FATAL ACCIDENT**  
 VICTIM - ANDREW KANITRA.  
 TIME - APRIL 23 1945 - 9.00 A.M.  
 PLACE - CHAIN PILLAR BETWEEN 5 & 6 BUTTS - 33 FACE

EXPLANATION - EVIDENTLY LOADED CAR MOVED FORWARD KNOCKING OUT TIMBER LEG, CAUSING FALL OF ROOF WHICH CAUGHT AND CRUSHED VICTIM

O - INDICATES POSTS

JONES & LAUGHLIN STEEL CORP.		C-996
VESTA COAL DIVISION		
CALIFORNIA, PA		
MINE NO. 4 - 6 BUTT - 33 FACE		
PLAN AT LOCATION OF		
ANDREW KANITRA. FATAL.		
DR. G.H.E.	DATE. 4-25-45	
TR. "	SCALE. AS SHOWN	