

PLAN VIEW  
1"=10'

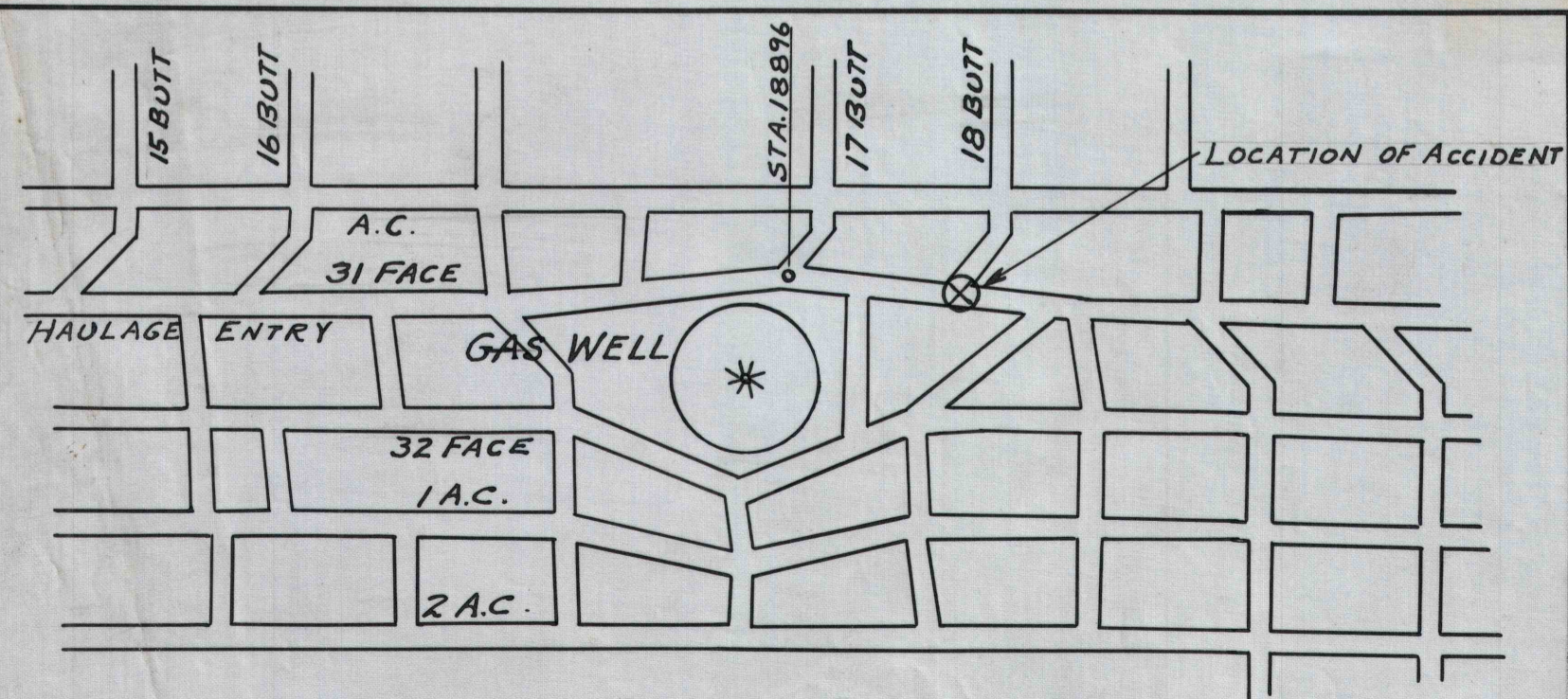
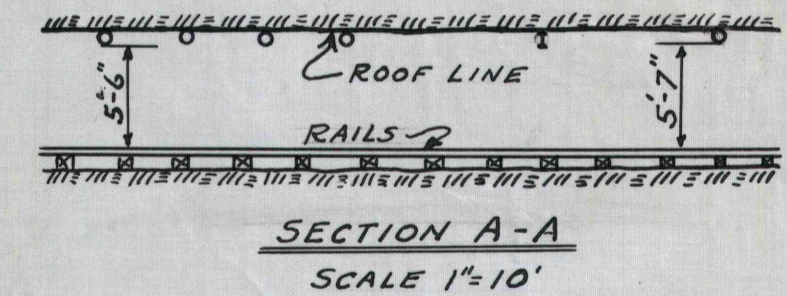

GENERAL PLAN  
SCALE 1"=100'

VICTIM - JOSEPH STALEY  
 OCCUPATION - BRAKEMAN (SNAPPER) CHECK No 3458  
 ACCIDENT - FATAL, FRONT CAR OF TRIP DERAILED  
 AND CRUSHED VICTIM.  
 PLACE - 31 FACE AT 18 BUTT LT. CHUTE  
 TIME - 9-20 P.M. AUG. 28, 1942  
 MOTORMAN - JOHN GANOVSKY (BUDDY)  
 ⊗ - LOCATION OF ACCIDENT

JONES & LAUGHLIN STEEL CORP.		
VESTA COAL DIVISION		
CALIFORNIA, PA.		
MINE No. 4 PLAN SHOWING		
LOCATION OF JOSEPH STALEY		
FATAL ACCIDENT		
DR. G.H.E.	DATE AUG. 29, 1942	B-920
TR.	SCALE AS SHOWN	