

EXPLANATION:

LOADING MACHINE WAS PULLED BACK AS SHOWN AWAITING EMPTIES TO LOAD THE LAST CAR OF COAL FROM THE PLACE. HARTEL, LOADING MACHINE OPERATOR AND TOBIAS, TIMBERMAN WERE CAUGHT BY FALL OF 15 INCHES OF ROOF COAL WHILE TRIMMING UP PLACE IN BY LAST CROSS BAR. BOTH MEN FATALLY INJURED.

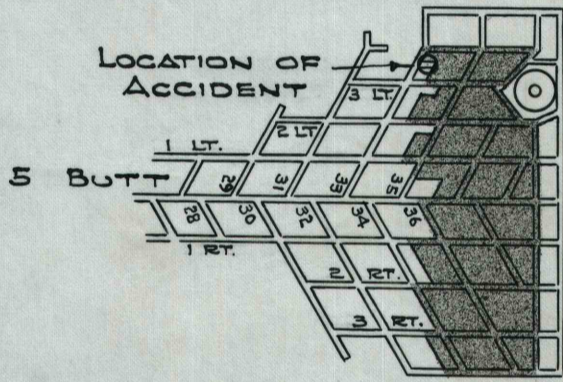

GENERAL PLAN
SCALE 1"=400'

PLAN
SCALE 1"=10'

VICTIMS:

LOUIS T. HARTEL CHECK NO. 1551
LOADING MACHINE OPERATOR.

STEPHEN TOBIAS CHECK NO. 324
TIMBERMAN.

LOCATION:

33 ROOM, 5 BUTT, 44 FACE
NO. 4 MINE.
TIME: 1:30 P.M. MARCH. 12., 1951.

JONES & LAUGHLIN STEEL CORPORATION
VESTA COAL DIVISION
NO. 4 MINE

LOUIS T. HARTEL - STEPHEN TOBIAS
FATALITY 33 ROOM 5 BUTT 44 FACE

MARCH. 15., 1951

C-1072