

Surface Subdivision of the Tracteller 18 Acres  
Scale 1/2" = 100'  
For further information see Plan A 8193  
N 50° E 81'

not this surface is included in  
deed of appropria to Barbara Schorr  
see abstract 4829  
Barbara Schorr  
Surface

No. Minors Tracts to the Gray & Bell Tract are included in the A. W. Mellon Abstract of the Deed of appropria to the Gray & Bell in the following column:

Thomas W. Hinkle	Vol. 245, Page 525
Isaac W. McNamee	251, 504
Michael Cook	254, 260
John S. Sims	319
John A. Dyer	231, 528
Thomas W. Hinkle	238, 649
John W. Hinkle	250, 558
Adam Hinkle	300, 425
John C. Hinkle	303, 275
J. H. Dyer	330, 600
John W. Hinkle	371, 152
Geo. W. Thomas	373, 408
Charles Hinkle	411, 592
Wm. Hinkle	411, 584
Thos. Mellon	462, 87

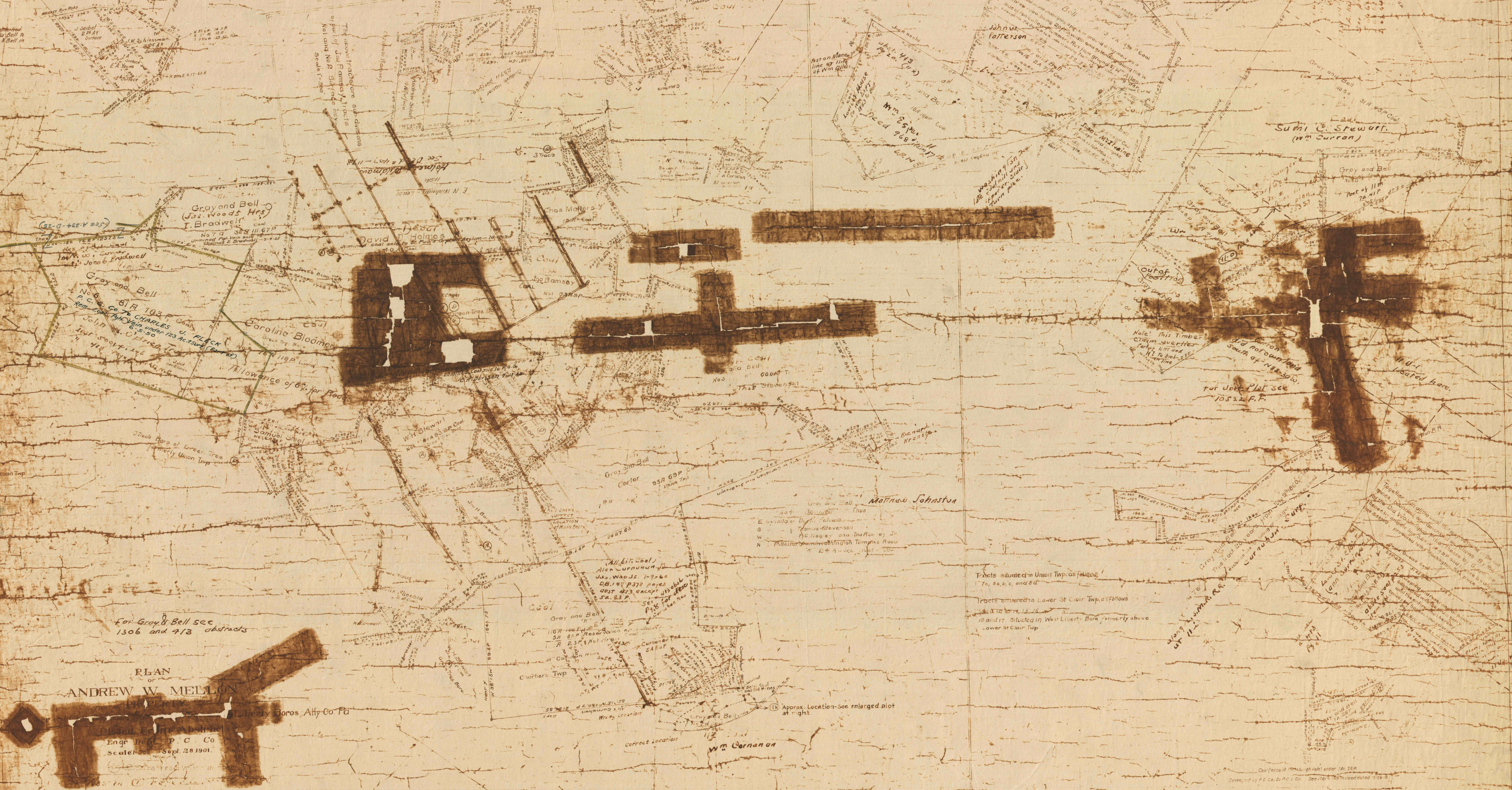

For Gray & Bell sec 1306 and 713 abstracts

PLAN  
OF  
**ANDREW W. MELLON**  
PLAT  
Liberty Floros, Atty. Co. Pa.  
Engineer, P. C. Co.  
Scale 1/2" = 100' - Sept. 28, 1901.  
Wm. C. Hinkle  
John W. Mellon  
(see abstract 4001)

Tracts situated in Union Twp. as follows  
7, 8, b, c, and 8 d

Tracts situated in Lower St. Clair Twp. as follows  
10 and 17. Situated in West Liberty Base formerly shown  
Lower St. Clair Twp.

The above tracts do not join and are not in position with relation to another  
Scale 1/2" = 100'