

FIT TO 11

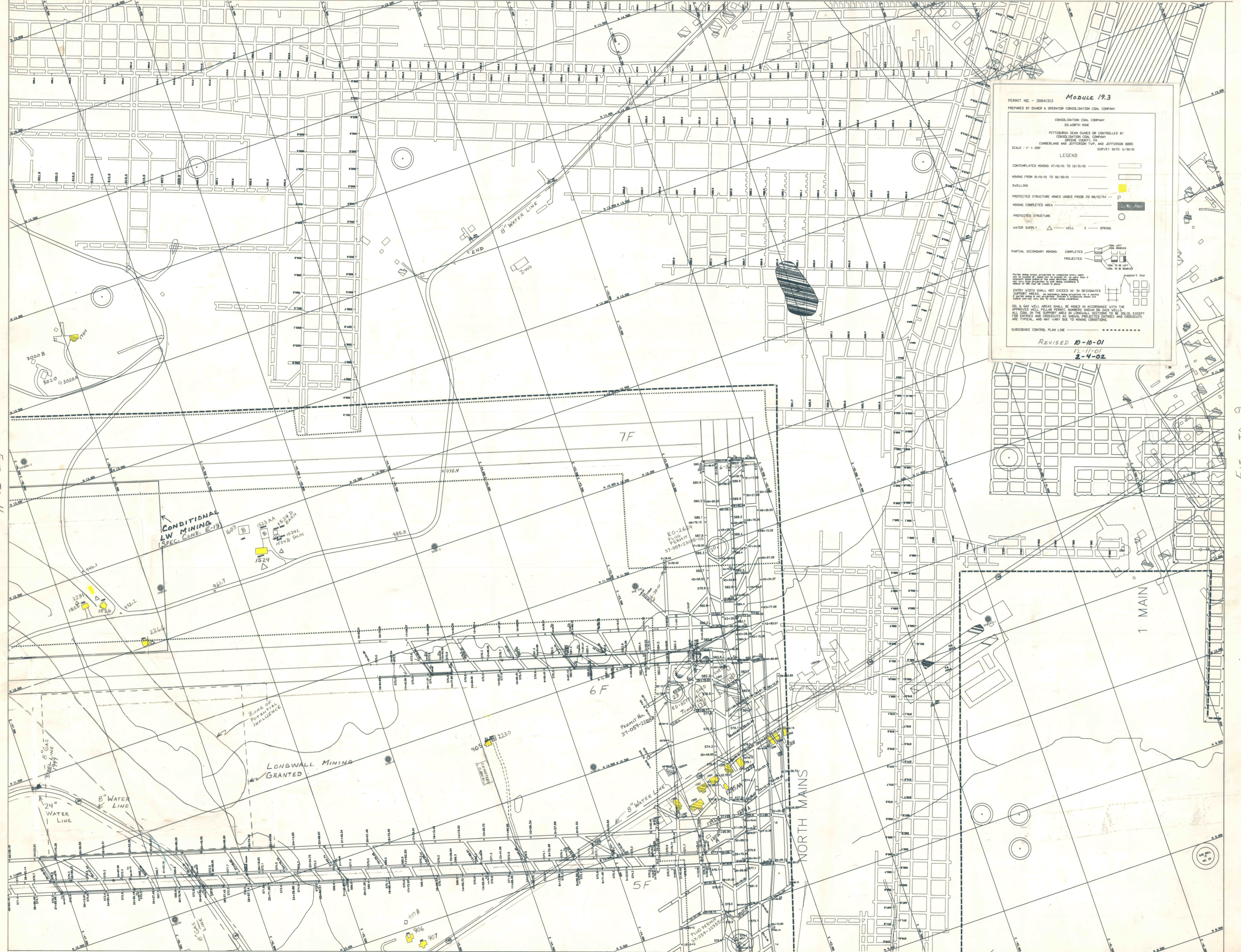

PERMIT NO. - 30841313 **MODULE 19.3**  
 PREPARED BY OWNER & OPERATOR CONSOLIDATION COAL COMPANY  
 CONSOLIDATION COAL COMPANY  
 SILVERTON MINE  
 PITTSBURGH SEAM OWNED OR CONTROLLED BY  
 CONSOLIDATION COAL COMPANY  
 CUMBERLAND AND JEFFERSON TOWNSHIP, AND JEFFERSON BORO  
 GREENE COUNTY, PA  
 SCALE: 1" = 200'  
 SURVEY DATE: 6/30/01

**LEGEND**

CONTINGENT MINING 07/01/01 TO 12/31/01

MINING FROM 01/01/01 TO 06/30/01

DWELLING

PROTECTED STRUCTURE MINED UNDER PRIOR TO 08/21/94

MINING COMPLETED AREA

PROTECTED STRUCTURE

WATER SUPPLY:  $\Delta$  WELL  $\square$  SPRING

PARTIAL SECONDARY MINING: COMPLETED, PROJECTED

ENTRY WIDTH SHALL NOT EXCEED 36' IN DESIGNATED SUPPORT AREA.

SOIL & GAS WELL AREAS SHALL BE MINED IN ACCORDANCE WITH THE APPROVED WELL PILLAR PERMIT, NUMBERS SHOWN ON SAID WELLS. ALL COAL IN THE SUPPORT AREA IN LONGWALL SECTIONS TO BE SOLD, EXCEPT FOR ENTRIES AND CROSSCUTS AS SHOWN, PROJECTED ENTRIES AND CROSSCUTS ARE TYPICAL, AND MAY VARY DUE TO MINING CONDITIONS.

SUBSIDENCE CONTROL PLAN LINE

REVISED 10-10-01  
 12-11-01  
 2-4-02

6 02 117

FIT TO 14