

PERMIT NO. - 308433  
 PREPARED BY OWNER & OPERATOR CONSOLIDATION COAL COMPANY  
 CONSOLIDATION COAL COMPANY  
 SILVERHIDE MINE  
 PITTSBURGH SEAM OWNED OR CONTROLLED BY  
 CONSOLIDATION COAL COMPANY  
 CUMBERLAND AND JEFFERSON TOWNSHIPS, WEST JEFFERSON BEAR  
 WARDEN, GREENE COUNTY, PA.  
 SCALE: 1" = 400'  
 SURVEY DATED 12/28/99

**LEGEND**

CONTINGENT MINING RIGHTS TO 06/26/00

MINING FROM 07/01/99 TO 12/31/99

SWELLING

PROTECTED STRUCTURE MINED UNDER PRIOR TO 06/26/00

MINING COMPLETED AREA

PROTECTED STRUCTURE

WATER SUPPLY: WATER WELL, SPRING

PARTIAL SECONDARY MINING: COMPLETED, PROJECTED

ENTRANCE WIDTH SHALL NOT EXCEED 10' IN UNDESIGNED SUPPORT AREAS. IN SUPPORT AREAS EXCEEDING 10' WIDTH, THE SUPPORT SHALL BE DESIGNED TO SUPPORT THE FULL WEIGHT OF THE OVERLIEING STRATA. THE SUPPORT SHALL BE DESIGNED TO SUPPORT THE FULL WEIGHT OF THE OVERLIEING STRATA. THE SUPPORT SHALL BE DESIGNED TO SUPPORT THE FULL WEIGHT OF THE OVERLIEING STRATA.

SOIL & GAS WELL AREAS SHALL BE MINED IN ACCORDANCE WITH THE APPROVED WELL PLANS. PROTECTIVE BARRIERS ON SOIL WELLS SHALL BE DESIGNED BY THE COMPANY AND APPROVED BY THE STATE. ALL ENTRY AND CROSSCUTS AS SHOWN, PROTECTIVE BARRIERS AND CROSSCUTS ARE TYPICAL, AND MAY VARY DUE TO MINING CONDITIONS.

SUBSIDENCE CONTROL PLAN LINE

REVISED 5-10-00  
 APP'D 5-30-00

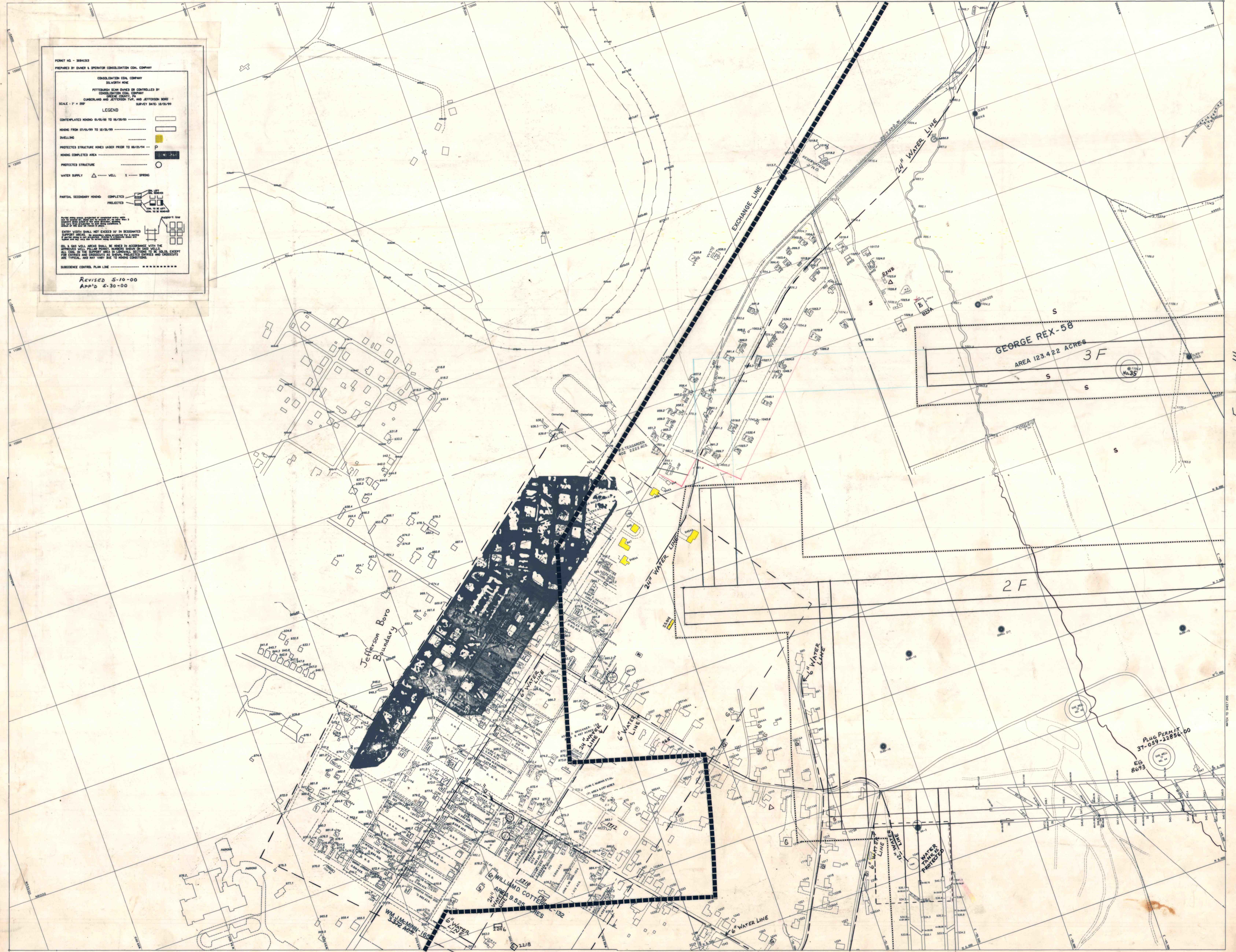

GEORGE REX-58  
 AREA 123.422 ACRES  
 3F

2F

PLUG PERMIT  
 37-059-22856-00  
 EG 8692

FIT TO 14

FIT TO 19

SHEET 15