

LEGEND:-

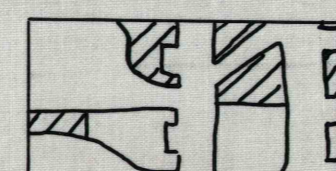

MINED PRIOR TO 7-1-48

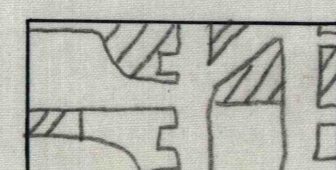

PROPOSED MINING FOR NEXT 6 MONTHS

ROADS

Elev. 1960 etc. = ELEVATION OF SURFACE  
 LEVEL DATUM IS U.S.G.S.  
 CONTOURS ARE OF BOTTOM OF 3 FT. "E" SEAM COAL

UNLESS OTHERWISE NOTED, MINING SHOWN IS IN PROPERTY OWNED AND OPERATED BY PGH. COAL CO., GRAY, PA.

SURFACE

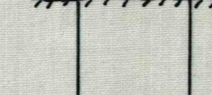

"E" SEAM

"Cprime" SEAM

COLUMNAR SECTION

*L. M. Carter*  
 MINING ENGINEER

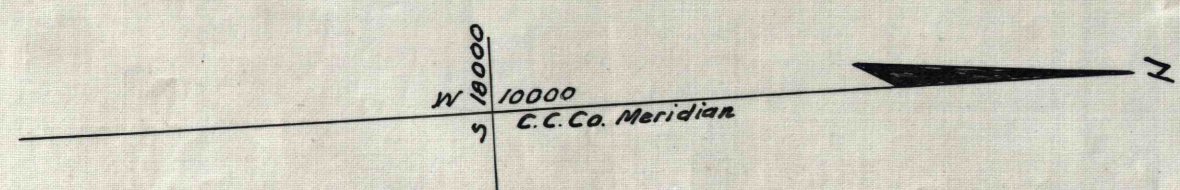
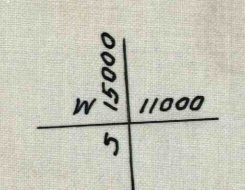
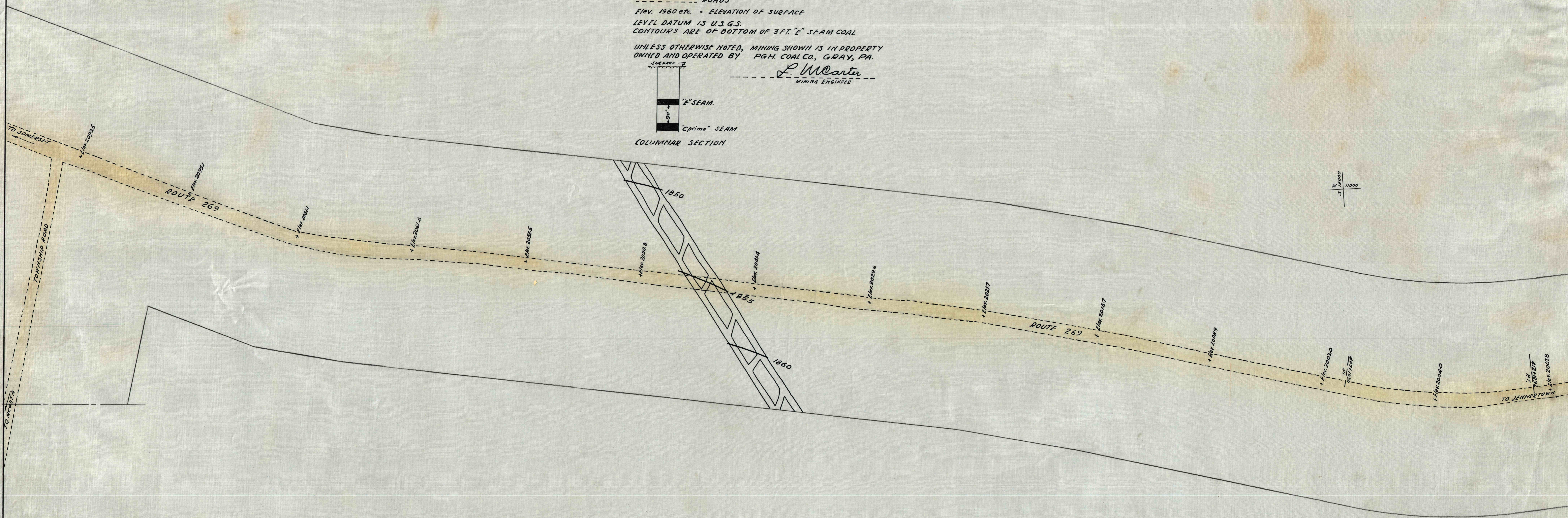

CONSOLIDATION COAL CO.  
 "E" SEAM COAL MINING OPERATION  
 ALONG ROUTE No 269  
 SCALE 1" = 100' JULY 1948 ENG. DEPT. ACOSTA, PA.