

Note: For Construction Details see plan G-303

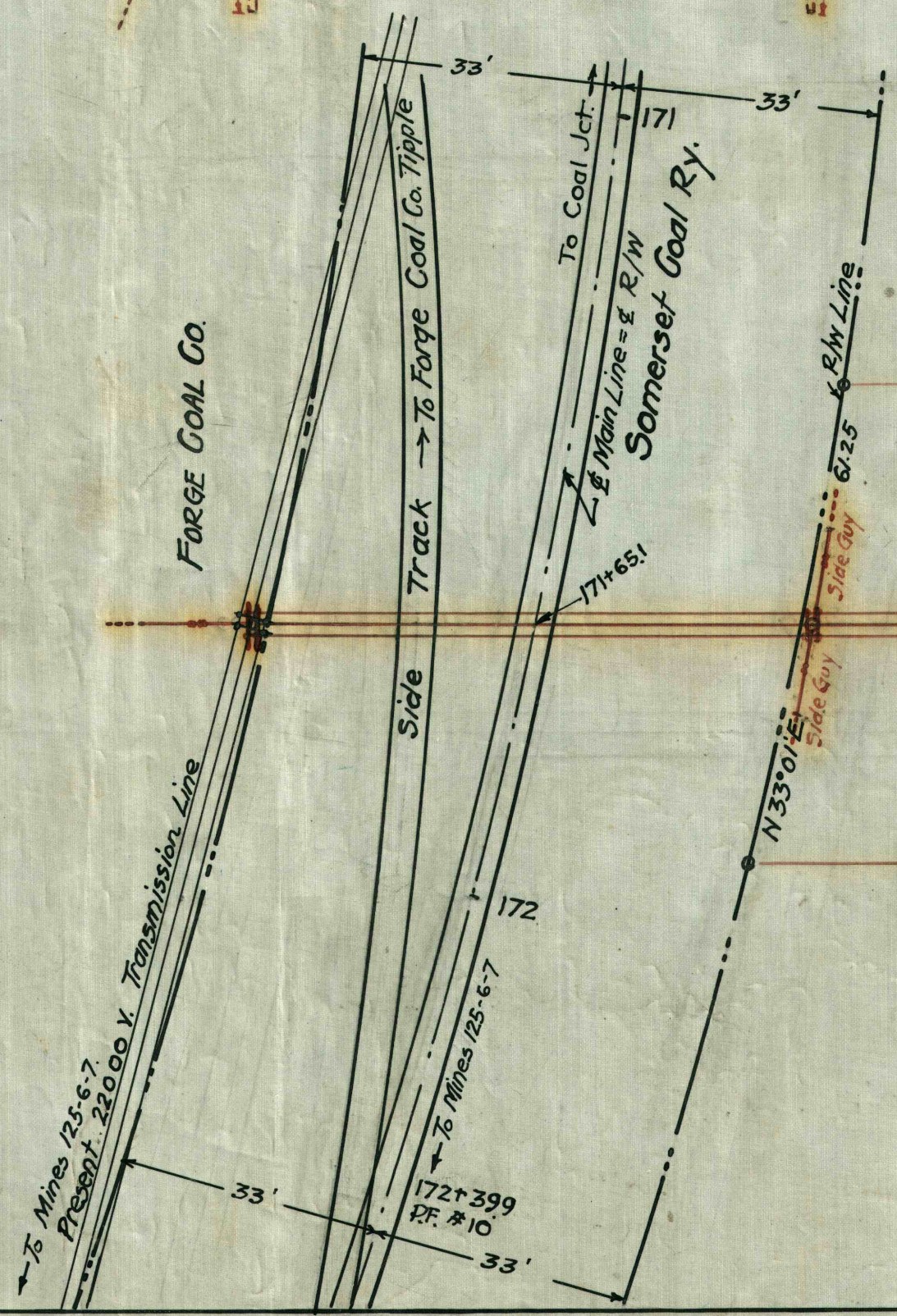

3 Cond. - #4 Stranded Copper wire
22000 V. 3 phase
→ S 69° 05' E

PLAT TO ACCOMPANY AGREEMENT
BETWEEN
SOMERSET GOAL RAILWAY CO.
AND
SOMERSET GOAL CO.
CONVEYING CROSSING RIGHTS FOR TRANSMISSION LINE
NEAR
MINE 125
Lincoln Twp. Somerset Co., Penna.
Scale 1"=20'

Engr. Dept. Pa. Md. Div.

The C.C.C.
1-G-304