

387413

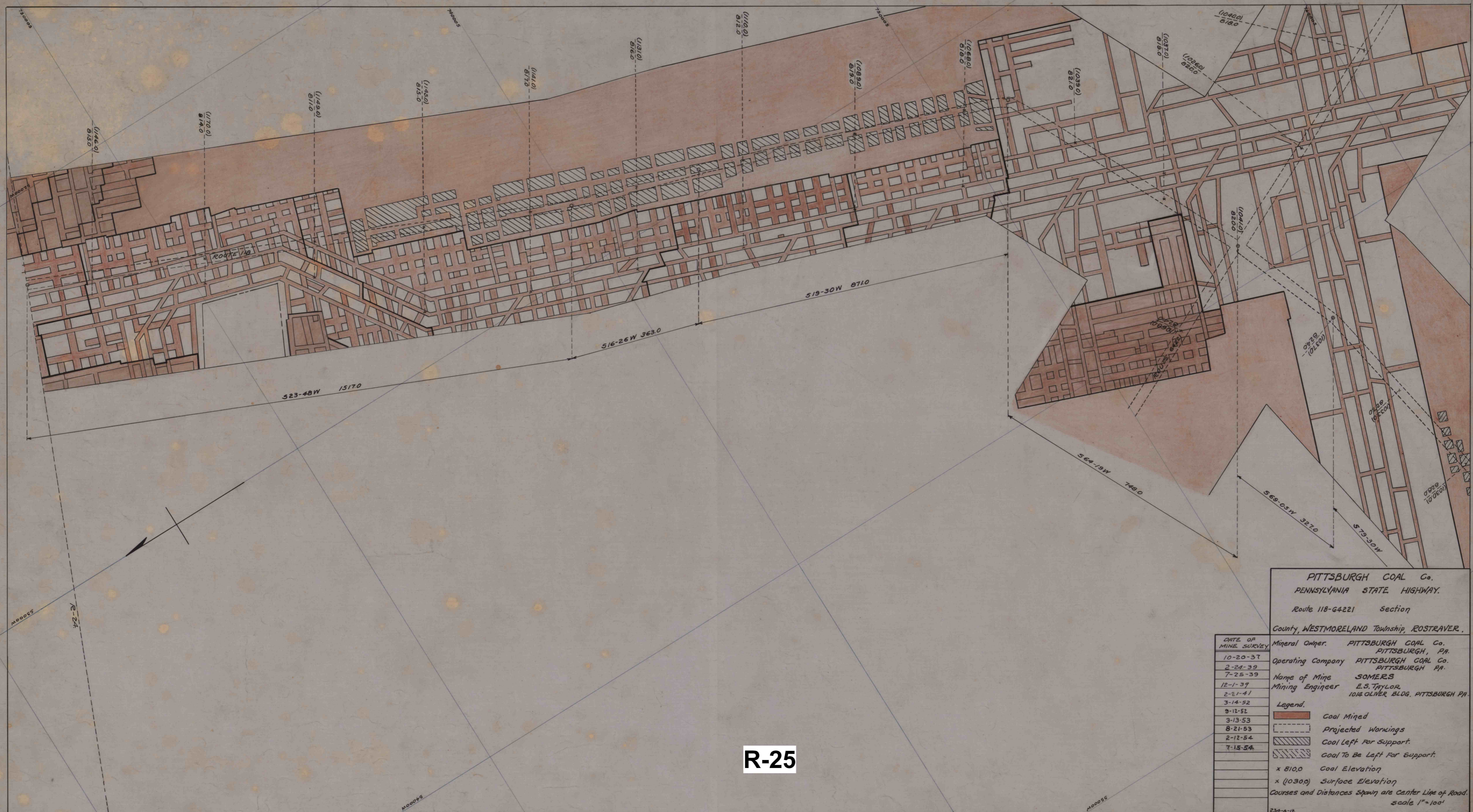

R-25

PITTSBURGH COAL Co.  
 PENNSYLVANIA STATE HIGHWAY.  
 Route 118-64221 Section  
 County, WESTMORELAND Township, ROSTRAVER.

DATE OF MINE SURVEY	Mineral Owner	PITTSBURGH COAL Co.
10-20-37		PITTSBURGH, PA.
2-24-39	Operating Company	PITTSBURGH COAL Co.
7-25-39		PITTSBURGH PA.
12-1-39	Name of Mine	SOMERS
2-21-41	Mining Engineer	E.S. TAYLOR
3-14-52		1014 OLIVER BLDG. PITTSBURGH PA.

Legend.

	Coal Mined
	Projected Workings
	Coal Left For Support.
	Coal To Be Left For Support.
x 810.0	Coal Elevation
x 1030.0	Surface Elevation

Courses and Distances Spawn are Center Line of Road.  
 scale 1"=100'

R-25