

387409

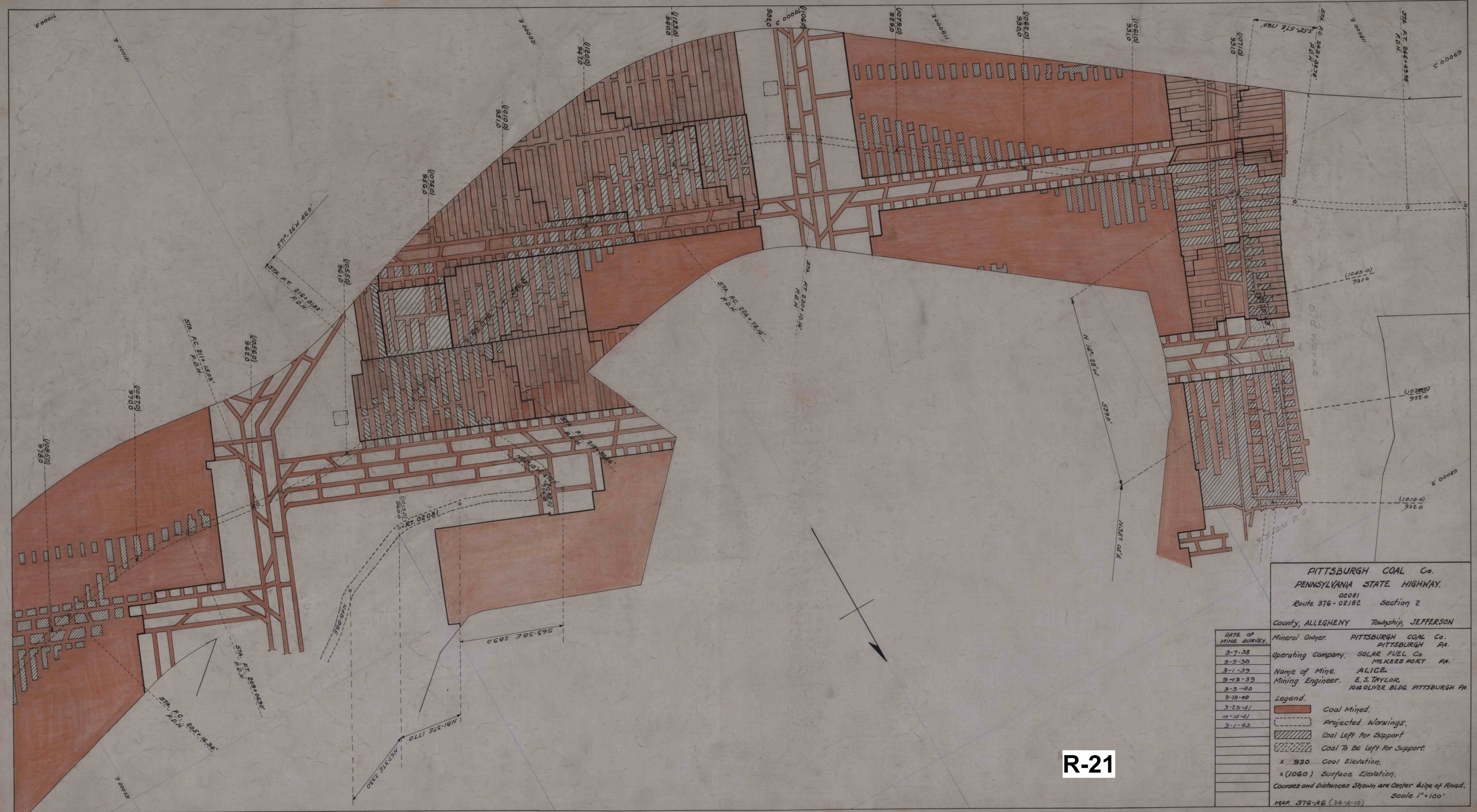

PITTSBURGH COAL Co.
 PENNSYLVANIA STATE HIGHWAY.
 02081
 Route 376 - 02182 Section 2
 County, ALLEGHENY Township, JEFFERSON

DATE OF MINE SURVEY.	Mineral Owner.	PITTSBURGH COAL Co. PITTSBURGH PA.
3-7-38	Operating Company.	SOLAR FUEL Co MCKEES PORT PA.
3-1-39	Name of Mine.	ALICE
3-18-39	Mining Engineer.	E. S. TAYLOR 1014 OLIVER BLDG. PITTSBURGH PA.
3-5-40		
3-18-40	Legend.	
3-25-41		Coal Mined.
10-14-41		Projected Workings.
3-1-43		Coal Left For Support
		Coal To Be Left For Support.
	x 930	Coal Elevation.
	x (1060)	Surface Elevation.
	Courses and Distances Shown are Center Line of Road.	
	Scale 1" = 100'	
	MAP. 376-A6 (34-A-10)	

R-21

R-21