

PLAN FOR EXCHANGE OF COAL
 BETWEEN
Blaine Coal Co.
 —and—
The M.R.C.C. & C.Co.
 SITUATE IN
 FORWARD TOWNSHIP, ALLEGHENY CO., PA.
 SCALE 200 TO 1
 ENGINEERING DEPT. THE M.R.C.C. & C.Co. OCT. 31, 1905

The M.R.C.C. & C.Co. Blaine Coal Co.		Blaine Coal Co. The M.R.C.C. & C.Co.	
No.	Acres	No.	Acres
1	Wilson Wall	2	John S. Eberman
4	Robt. McKinney	3	Isaac & Sarah Wall
5	Wm. Mayhew	4	Wm. Caldwell
7	Brisbin Wall	8	John Gamble Jr. et al.
	Total 141,209		Total 141,209

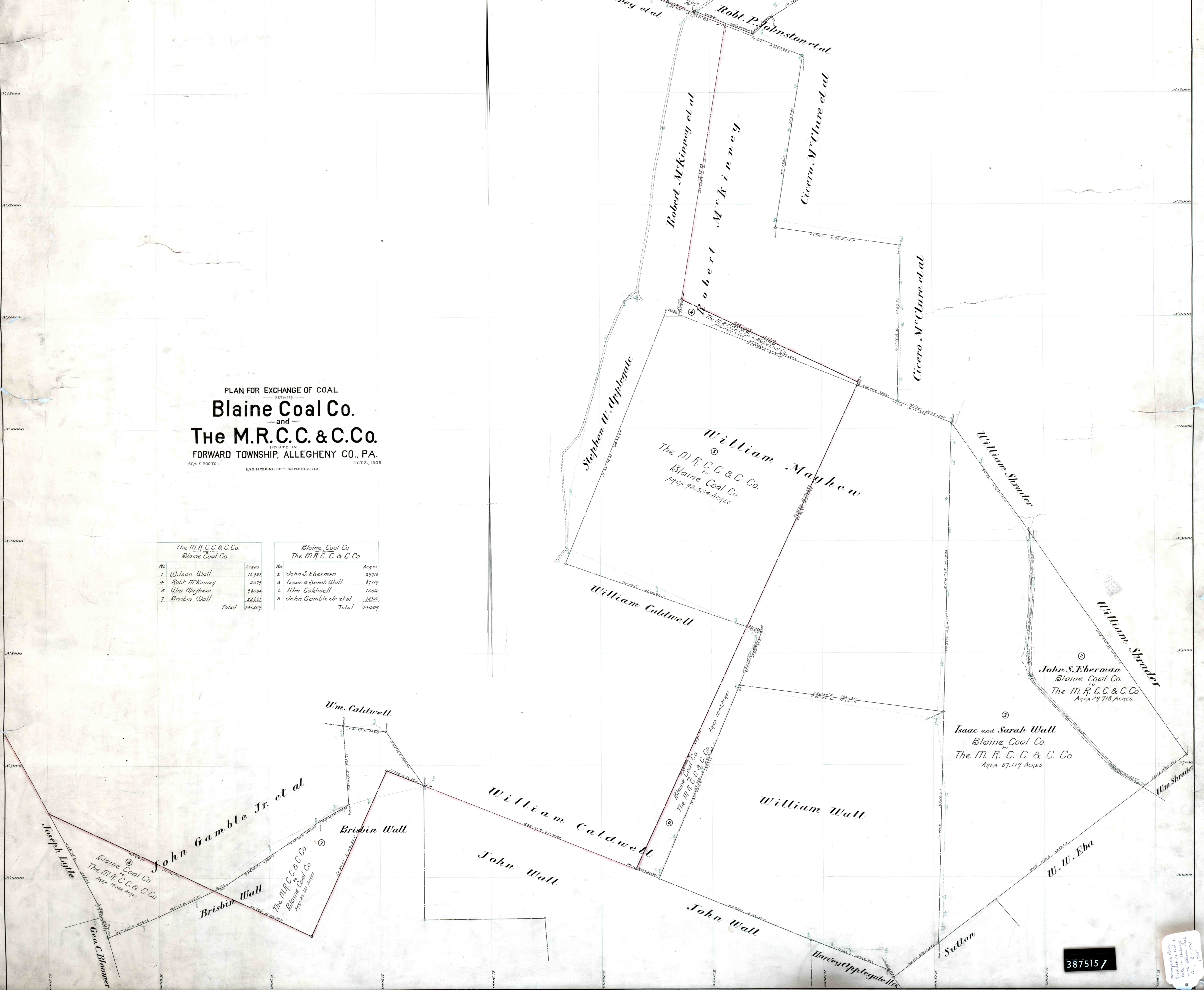

387515 /

Blaine Coal Co. & The M.R.C.C. & C.Co. Survey of 1905