

LAND OF THEODORE TEETS

MERLE W. HOUSEHOLDER JR.

GEORGE G. YOVICH

GEORGE G. YOVICH

SHERWOOD OSTROM

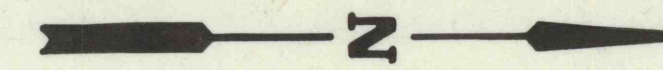

THOMAS GRZELKA SR.
WESLEY MOORE
THOMAS GRZELKA JR.
ALFRED GRZELKA
HOWARD HORNER
J.A. CARPENTER
LOUIS KUGLICS

AREA = 10.78 ACRES

LAND OF
ZELLA DOUGLASS

PROPOSED TO BE CONVEYED TO
NORTHEASTERN BEAVER COUNTY
SCHOOL DISTRICT

LAND OF
NORTH SEWICKLEY
TOWNSHIP VOLUNTEER
FIRE DEPARTMENT

DOUGLASS
RECORDED IN PLAN BOOK VOL. 8 - PAGE 70 & 71.

9
10
11
12
13
14
15
1
2

Laurin Kemp

Anna P. Douglass

Pennsylvania Turnpike

BEAVER COUNTY
COMMISSIONERS

BAKER COAL CO.
MINE

George W. Myers

COAL MINE ENTRANCE

Elvera Bowen

END 10/7/18

NORTHEASTERN
BEAVER COUNTY
SCHOOL DISTRICT

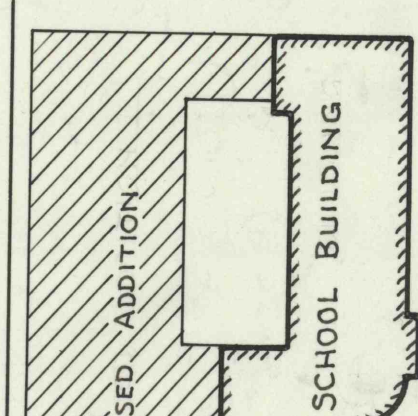

NOTE:
APPROXIMATE GROUND
ELEVATION AT SCHOOL
IS 1220 ±

DOUGLASS BROS
COAL MINES

Paul Lucas

Kenneth
Douglass

Anna P.
Douglass

Elvera G. Douglass

THOMPSON RUN COAL CO.
MINE

AIR SHAFT

MERCER ROAD

PA. ROUTE 65

TO ELLWOOD CITY

Zella Douglass

NOTE:
APPROXIMATE ELEVATION
OF OLD COAL MINE WORKINGS
IS 1150 ±

TO NEW BRIGHTON

Larson Design Group, Inc. makes no representation or warranty, expressed or implied, with regard to the accuracy, adequacy, completeness or reliability of any of the information contained herein. This map is for informational purposes only and in no way confirms the current state of the land depicted herein. Larson Design Group, Inc. hereby disclaims any and all liability for information and/or statements contained herein. Larson Design Group, Inc. shall not be liable for any damages incurred or arising as a result of reliance upon this map as well as from any errors or inaccuracies on such map.

NOTE:
THIS PLAN PREPARED BY THE PLOTTING
OF PLANS AND DEEDS OF RECORD AND
FROM MINE PLANS AND NOTES PLOTTED
FROM MINE SURVEY NOTE BOOKS.

PLAN OF PROPERTIES & COAL MINE WORKINGS

SITUATE IN
NORTH SEWICKLEY TOWNSHIP, BEAVER COUNTY, PA.

MADE AT THE INSTANCE OF
NORTHEASTERN BEAVER COUNTY SCHOOL DISTRICT

SCALE: 1 INCH = 100 FEET
DANIEL C. BAKER ~ REGISTERED PROFESSIONAL ENGINEER & SURVEYOR ~ BEAVER, PA.

FEBRUARY 4, 1966



N.B. 1 - P. 1
N.B. 6 - P. 40
N.B. 12 - P. 80
N.B. 26 - P. 116
N.B. 55 - P. 136