

REVISIONS		
NO.	DATE	ITEM
1	2 02 54	Mine Workings To Spad No. 133
2	2 02 54	Added 25 Foot Barrier Lines
3	2 25 54	Added Proposed Drainage Line From Sump
4	2 25 54	Added New Air Course
5	4 02 54	Mine Workings To Spad No. 140
6	7 16 54	Mine Workings To Spad No. 143
7	7 16 54	Plan Of Advanced Old Workings Revised
8	5 30 57	Mine Workings To Spad No. 252
9	1 14 59	Mine Workings To Spad No. 350
10	2 29 60	Mine Workings To Spad No. 442
11	9 21 60	Mine Workings To Spad No. 461
12	9 21 60	Man-Way To Spad No. 521
13	6 05 62	Mine Workings To Spad No. 470
14	6 05 62	Mine Workings To Spad New No. 79
15	11 15 63	Added New Concrete Portal
16	11 15 63	Mine Workings To Spad New No. 154
17	3 25 64	New Tracing Completed
18	3 25 64	Mine Workings To Spad New No. 166
19	3 30 64	Mine Workings To Spad New No. 186
20	3 18 65	Mine Workings To Spad New No. 226
21	9 15 65	Mine Workings To Spad New No. 241
22	3 15 66	Mine Workings To Spad New No. 291
23	6 10 67	Man-Way To Spad No. 533
24	6 10 67	Mine Workings To Spad New No. 350

Additions by Michael Baker Jr. Inc. in Revised Print of 6-10-67
 Parcel Numbers - Tax District 55, Map 153
 Deep Test Borings for Medical Center of Beaver Co.,
 on Parcel 164. Borings 1 to 18 drilled Jan-Feb 72.
 Borings 15 to 18 drilled Oct-Nov 1975.
 Mine Parcel Elevations Surveyed by Michael Baker Jr., Inc. on
 Dec. 12, 1973.
 Additional Mine Workings Traced from Fallston
 Fire Clay Co. Mine Map Dated Feb. 1927.

THE GENERAL PLAN, PROPERTY LINES AND OLDER
 MINE WORKINGS TO AND INCLUDING SPAD NUMBER 99
 HAVE BEEN TRACED FROM THE ORIGINAL PLAN MADE
 BY C. W. OHNSMAN, DATED APRIL 1928.
 THE NEWER MINE WORKINGS, BEGINNING WITH
 SPAD NUMBER 96, ARE BEING ADDED AS THE MINE
 PROGRESSES.
 SCALE 1" = 100'
 JANUARY, 1954
 THIS NEW TRACING SHOWING THE ABOVE FEATURES,
 IS BEING COMPLETED ON MARCH 25, 1964.
 RUSSELL S. MITCHELL, C. E. - P. E.
 125 HIGH STREET, SLIPPERY ROCK, PA.

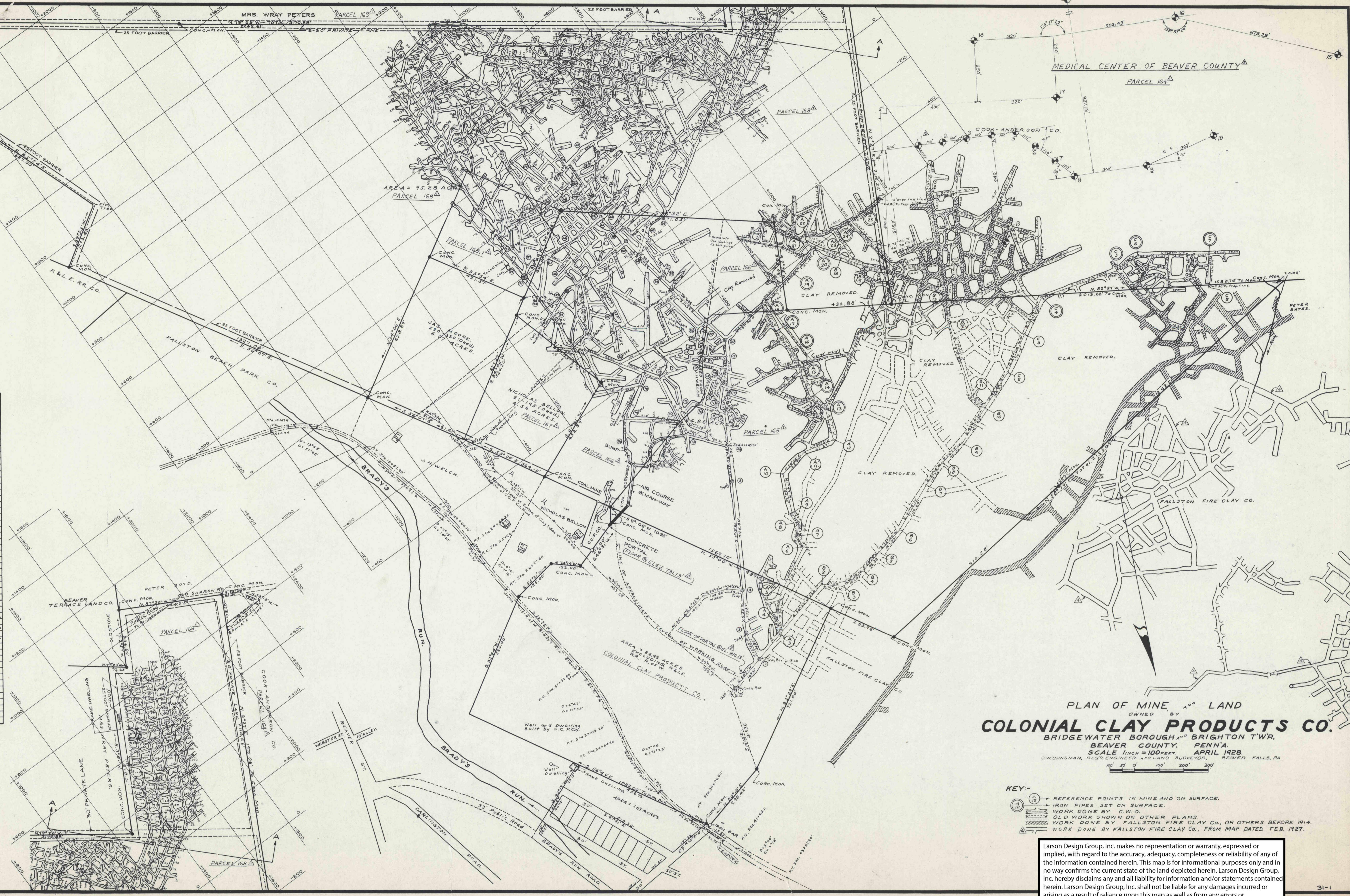

PLAN OF MINE AND LAND
 OWNED BY
COLONIAL CLAY PRODUCTS CO.
 BRIDGEWATER BOROUGH, BRIGHTON TWP.,
 BEAVER COUNTY, PENNA.
 SCALE 1 INCH = 100 FEET. APRIL 1928.
 C.W. OHNSMAN, RES'D ENGINEER AND LAND SURVEYOR, BEAVER FALLS, PA.

- KEY:-
- (A) REFERENCE POINTS IN MINE AND ON SURFACE.
 - (B) IRON PIPES SET ON SURFACE.
 - WORK DONE BY C.W.O.
 - OLD WORK SHOWN ON OTHER PLANS.
 - WORK DONE BY FALLSTON FIRE CLAY CO., OR OTHERS BEFORE 1914.
 - WORK DONE BY FALLSTON FIRE CLAY CO., FROM MAP DATED FEB. 1927.

Larson Design Group, Inc. makes no representation or warranty, expressed or implied, with regard to the accuracy, adequacy, completeness or reliability of any of the information contained herein. This map is for informational purposes only and in no way confirms the current state of the land depicted herein. Larson Design Group, Inc. hereby disclaims any and all liability for information and/or statements contained herein. Larson Design Group, Inc. shall not be liable for any damages incurred or arising as a result of reliance upon this map as well as from any errors or inaccuracies on such map.