

COLONIAL CLAY PRODUCTS CO.

COOK-ANDERSON FARM

M. W. GOETMAN.

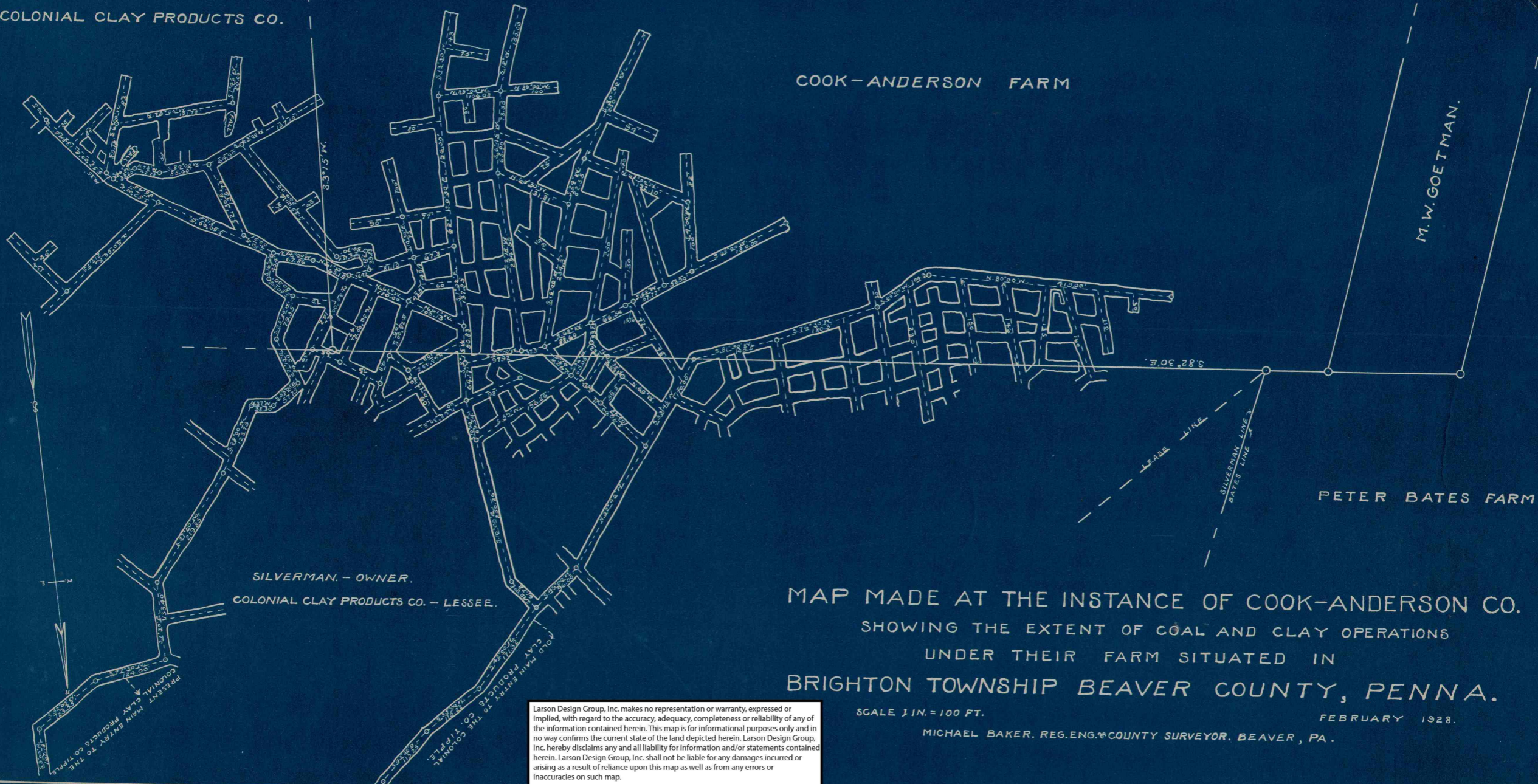

PETER BATES FARM

SILVERMAN - OWNER.  
COLONIAL CLAY PRODUCTS CO. - LESSEE.

MAP MADE AT THE INSTANCE OF COOK-ANDERSON CO.  
SHOWING THE EXTENT OF COAL AND CLAY OPERATIONS  
UNDER THEIR FARM SITUATED IN  
BRIGHTON TOWNSHIP BEAVER COUNTY, PENNA.

SCALE 1 IN. = 100 FT.

FEBRUARY 1928.

MICHAEL BAKER, REG. ENG. & COUNTY SURVEYOR, BEAVER, PA.

Larson Design Group, Inc. makes no representation or warranty, expressed or implied, with regard to the accuracy, adequacy, completeness or reliability of any of the information contained herein. This map is for informational purposes only and in no way confirms the current state of the land depicted herein. Larson Design Group, Inc. hereby disclaims any and all liability for information and/or statements contained herein. Larson Design Group, Inc. shall not be liable for any damages incurred or arising as a result of reliance upon this map as well as from any errors or inaccuracies on such map.