

Larson Design Group, Inc. makes no representation or warranty, expressed or implied, with regard to the accuracy, adequacy, completeness or reliability of any of the information contained herein. This map is for informational purposes only and in no way confirms the current state of the land depicted herein. Larson Design Group, Inc. hereby disclaims any and all liability for information and/or statements contained herein. Larson Design Group, Inc. shall not be liable for any damages incurred or arising as a result of reliance upon this map as well as from any errors or inaccuracies on such map.

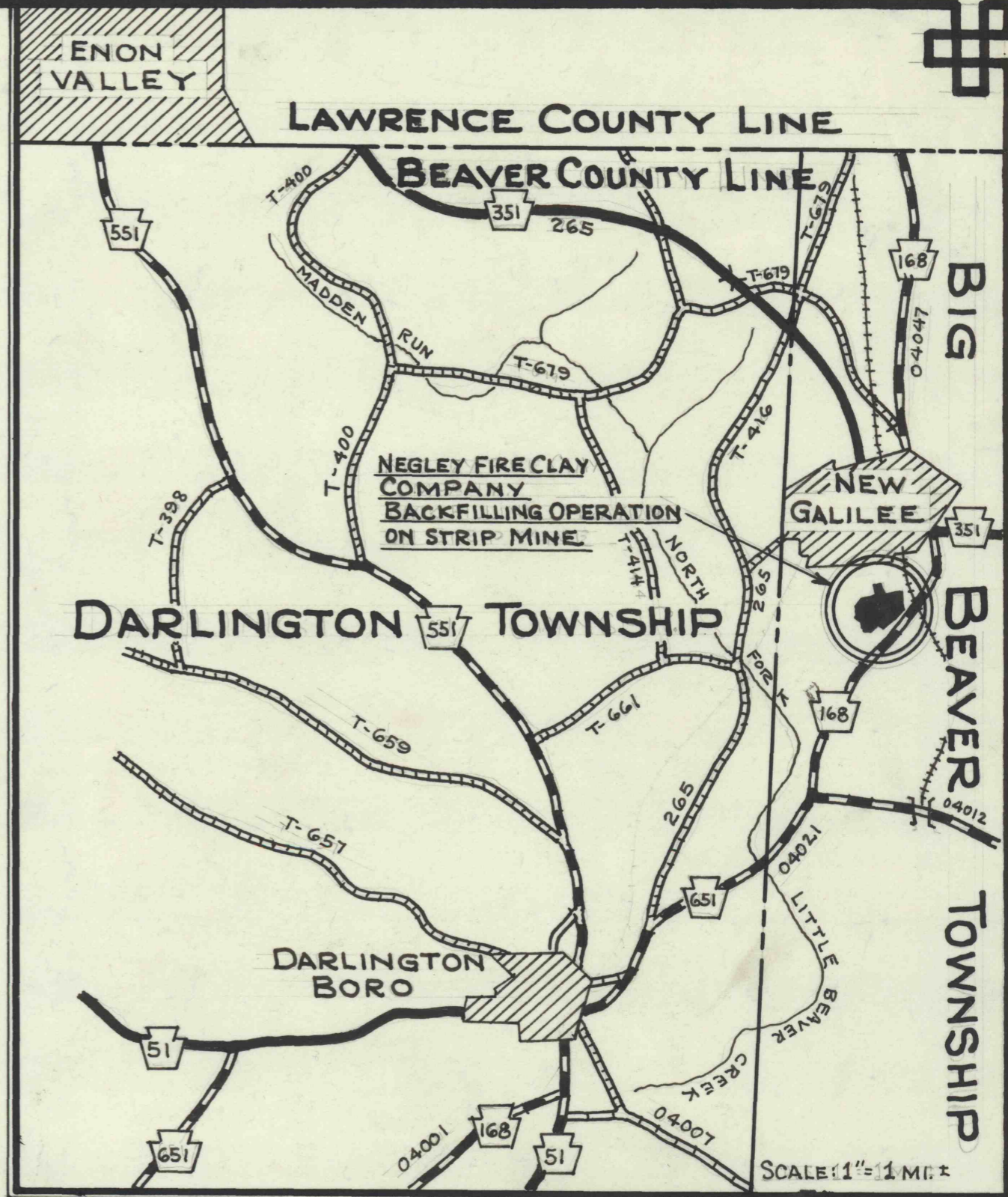
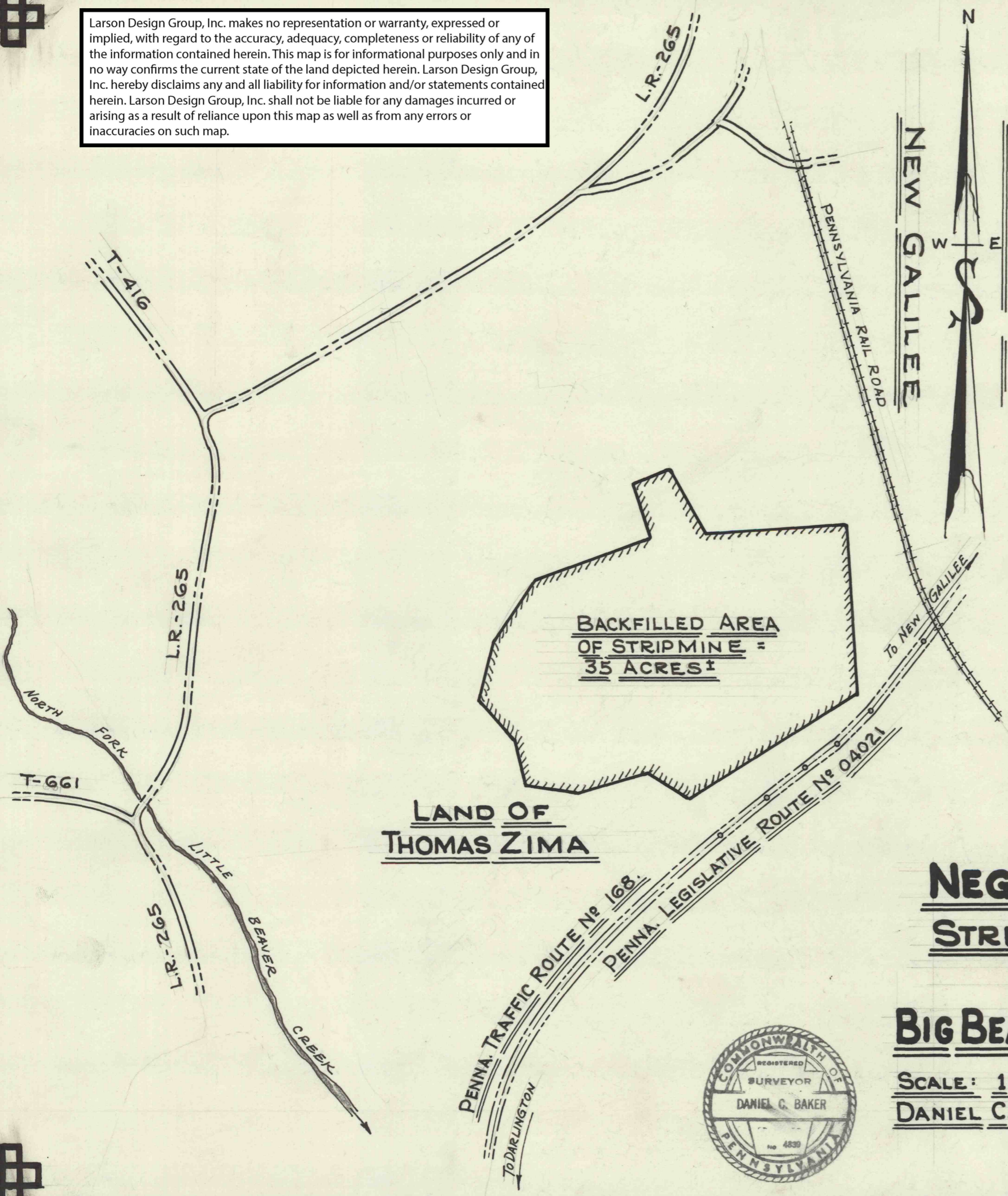

LOCATION MAP

NEGLEY FIRE CLAY COMPANY
STRIP MINE BACKFILLING OPERATION
ON LAND OF THOMAS ZIMA
BIG BEAVER TOWNSHIP, BEAVER COUNTY, PENNA.

SCALE: 1 INCH = 400 FEET
 DANIEL C. BAKER, REGISTERED SURVEYOR, BEAVER, PENNA.
 DECEMBER 10, 1958.

