

1441-20

Map showing proposed Road between Shenandoah and Brandonville.

MAP
SHOWING THE PROPOSED ROAD
IN UNION, EAST UNION & WEST MAHANOE TOWNSHIPS
FROM BRANDONVILLE STATION WESTWARD 2 3/4 MILES TO KEHLEY RUN COLLIERY
AS LAID OUT BY COMMISSIONERS
GEO. S. STAUFFER,
M. C. WATSON,
JOHN P. BOEHM.
OCTOBER A.D. 1899.
Scale 20 per one inch.

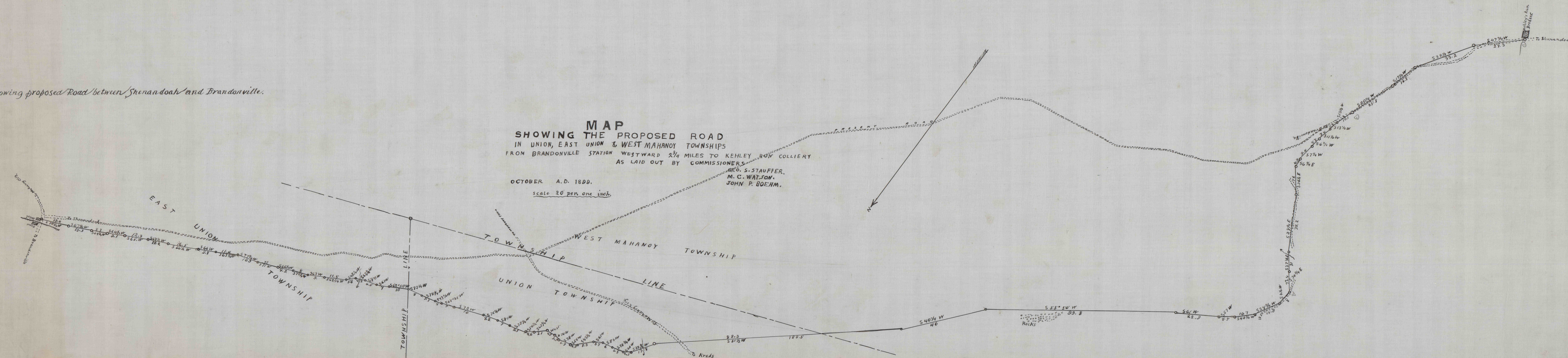

1441-2