

REVISION RECORD				
Date	Authority	Made	Checked	Description
1-1-33	C-11964	C.S.P.		Initial drawing for Plans 4-18 to 4-20
1-1-33	P-11432	C.S.P.		Revised drawing for Plans 4-18 to 4-20
1-1-34	P-11432	C.S.P.		Revised drawing for Plans 4-18 to 4-20
2-5-37	E.P.138	C.W.K.		Revised drawing for Plans 4-18 to 4-20
8-6-38	C-25817	C.W.K.		Revised drawing for Plans 4-18 to 4-20
8-6-38	C-25816	C.W.K.		Revised drawing for Plans 4-18 to 4-20
8-7-38	P-12786	C.W.K.		Revised drawing for Plans 4-18 to 4-20

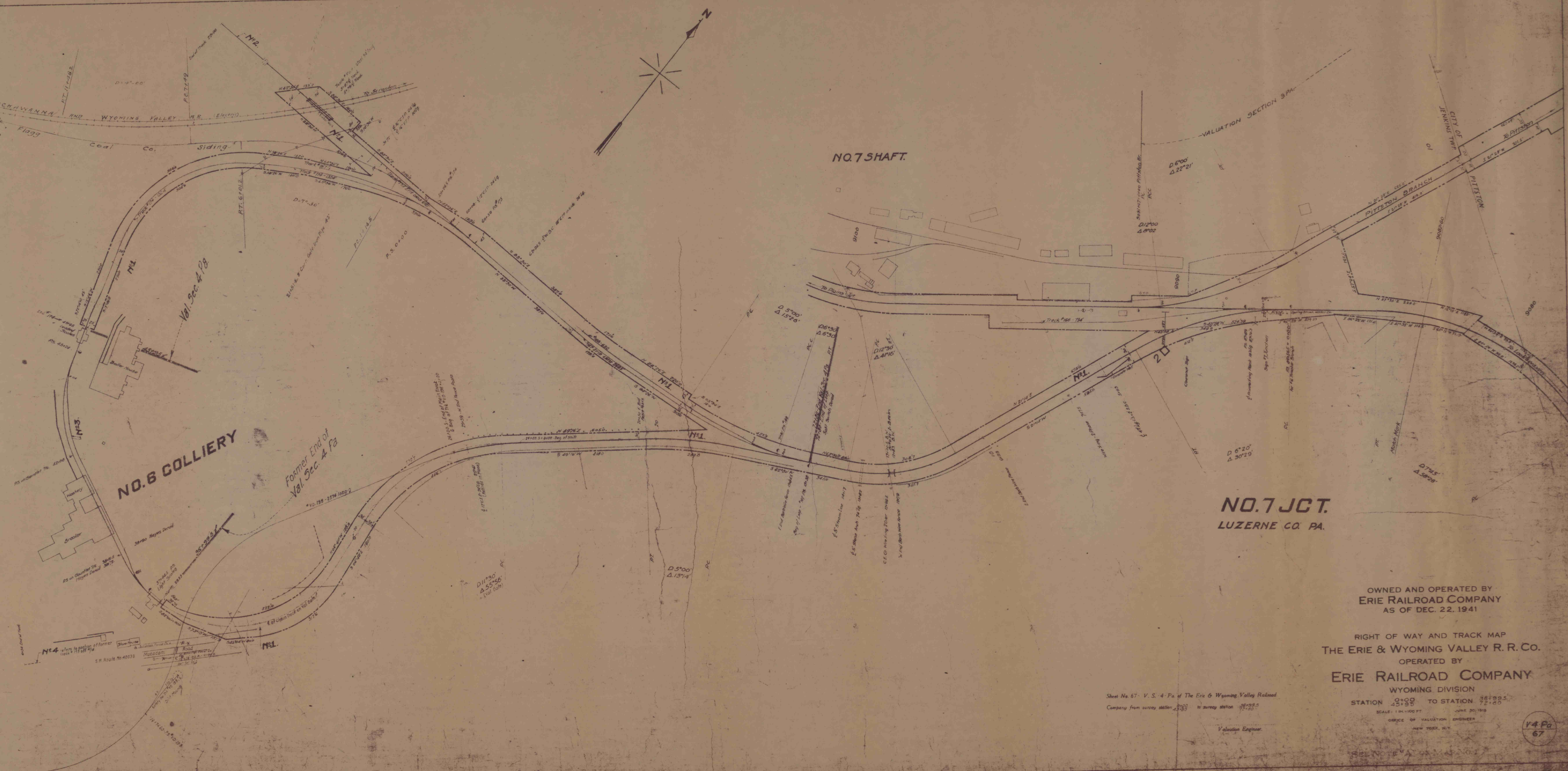

OWNED AND OPERATED BY
ERIE RAILROAD COMPANY
 AS OF DEC. 22, 1941

RIGHT OF WAY AND TRACK MAP
THE ERIE & WYOMING VALLEY R. R. CO.
 OPERATED BY
ERIE RAILROAD COMPANY
 WYOMING DIVISION

Sheet No. 67 - V. S. 4 - Pa. of The Erie & Wyoming Valley Railroad
 Company from survey station 25.00 to survey station 36.00

STATION 25.00 TO STATION 36.00
 SCALE: 1 IN. = 100 FT.
 JUNE 30, 1941
 OFFICE OF VALUATION ENGINEER
 NEW YORK, N.Y.

Valuation Engineer

V4 Pa
 67