

LEE LANDS

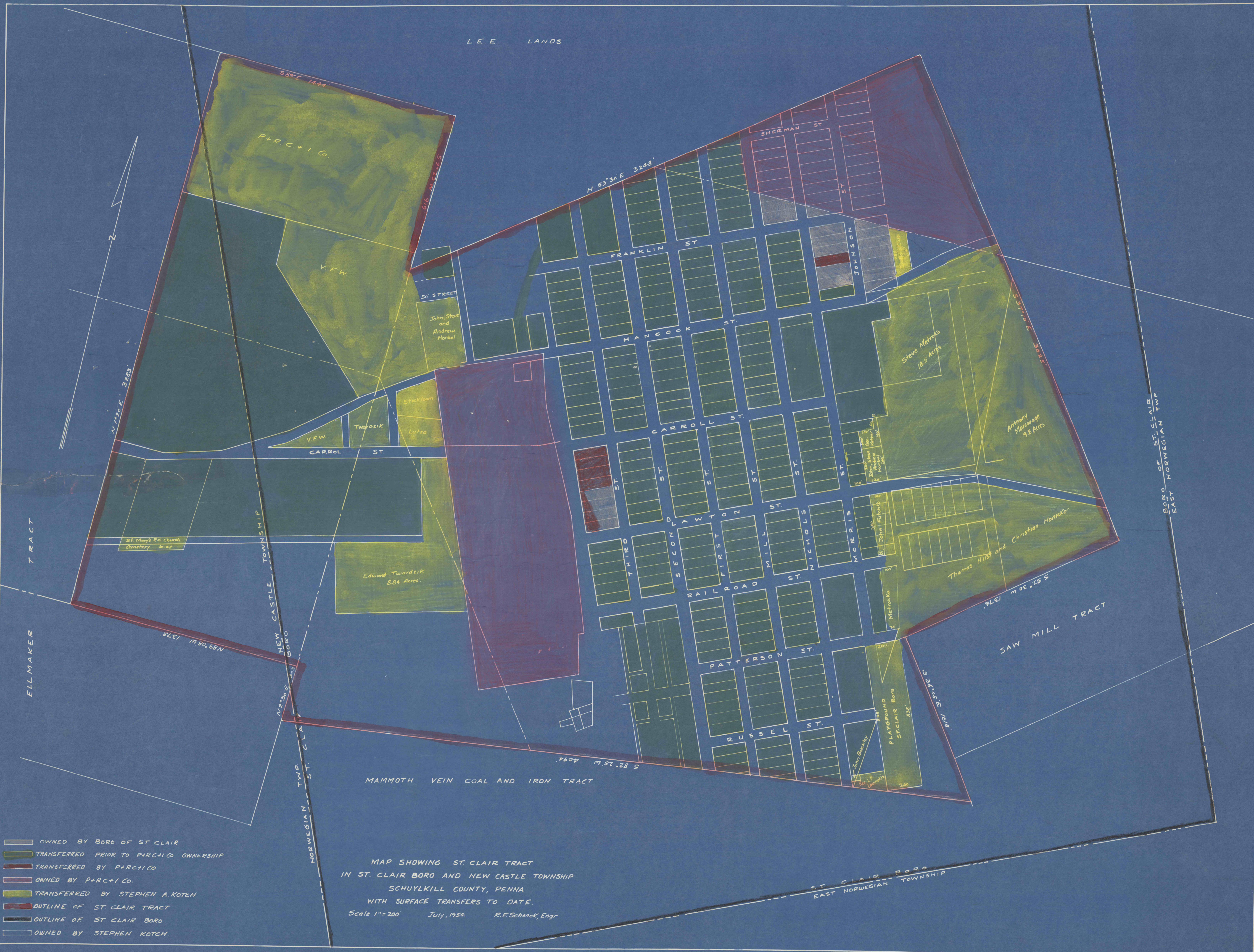

- OWNED BY BORO OF ST. CLAIR
- TRANSFERRED PRIOR TO PARC+I CO. OWNERSHIP
- TRANSFERRED BY PARC+I CO.
- OWNED BY PARC+I CO.
- TRANSFERRED BY STEPHEN A. KOTCH
- OUTLINE OF ST. CLAIR TRACT
- OUTLINE OF ST. CLAIR BORO
- OWNED BY STEPHEN KOTCH.

MAP SHOWING ST. CLAIR TRACT
 IN ST. CLAIR BORO AND NEW CASTLE TOWNSHIP
 SCHUYLKILL COUNTY, PENNA.
 WITH SURFACE TRANSFERS TO DATE.

Scale 1"=200' July, 1954. R.F. Schenck, Eng'r.

ST. CLAIR BORO
 EAST NORWEGIAN TOWNSHIP