

hrs. 1915

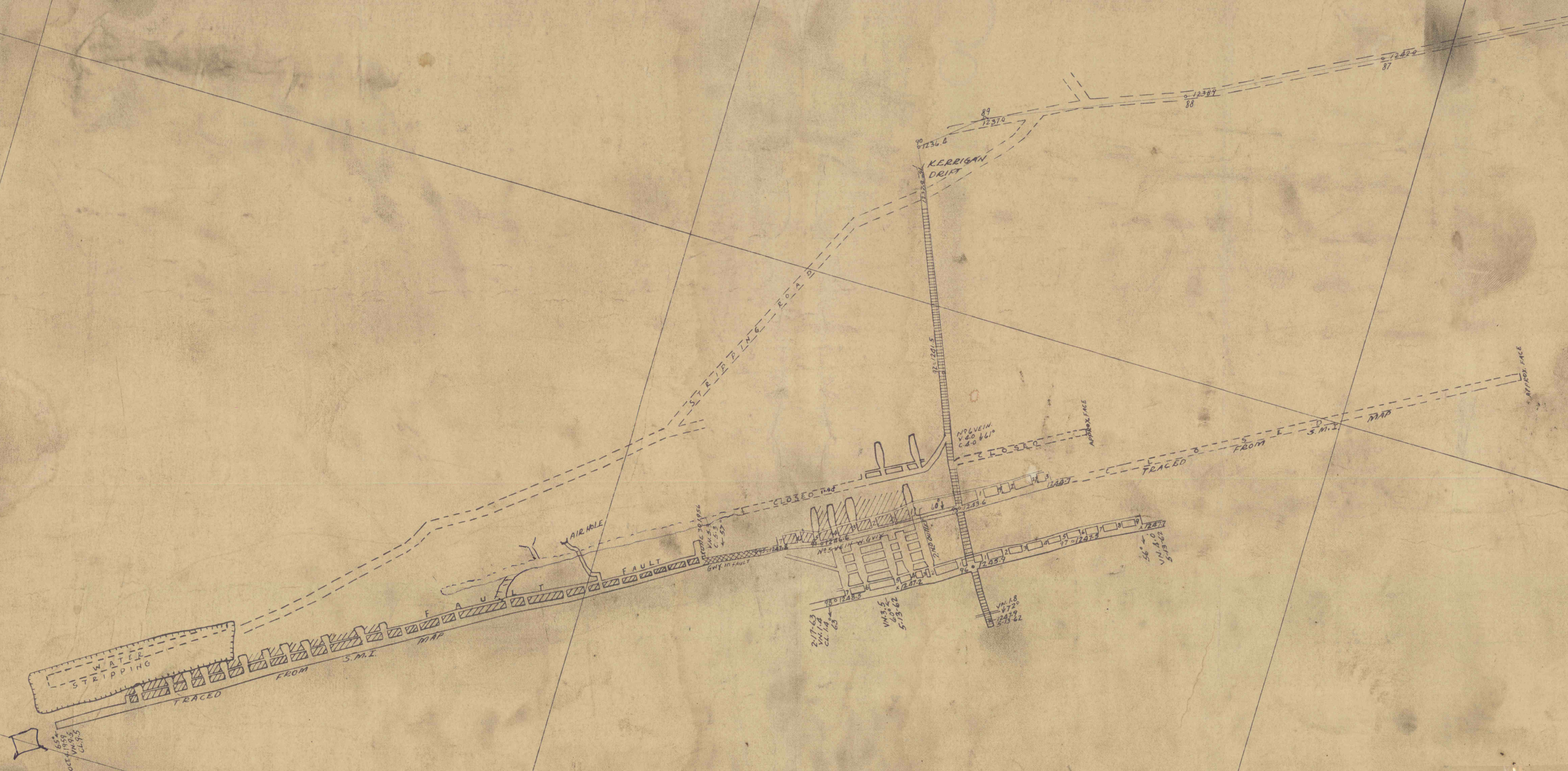

MAP SHOWING KERRIGAN DRIFT, LEHIGH VALLEY VAIN WORKINGS, SITUATE IN RUSH TOWNSHIP, DAUPHIN COUNTY, PENNSYLVANIA.  
 Scale 1" = 100' Feb. 17, 1963 John C. Briel, Jr. Reg. Surv. No. 6307-E