

DAUPHIN

COUNTY

NORTH

To Goldmine Road

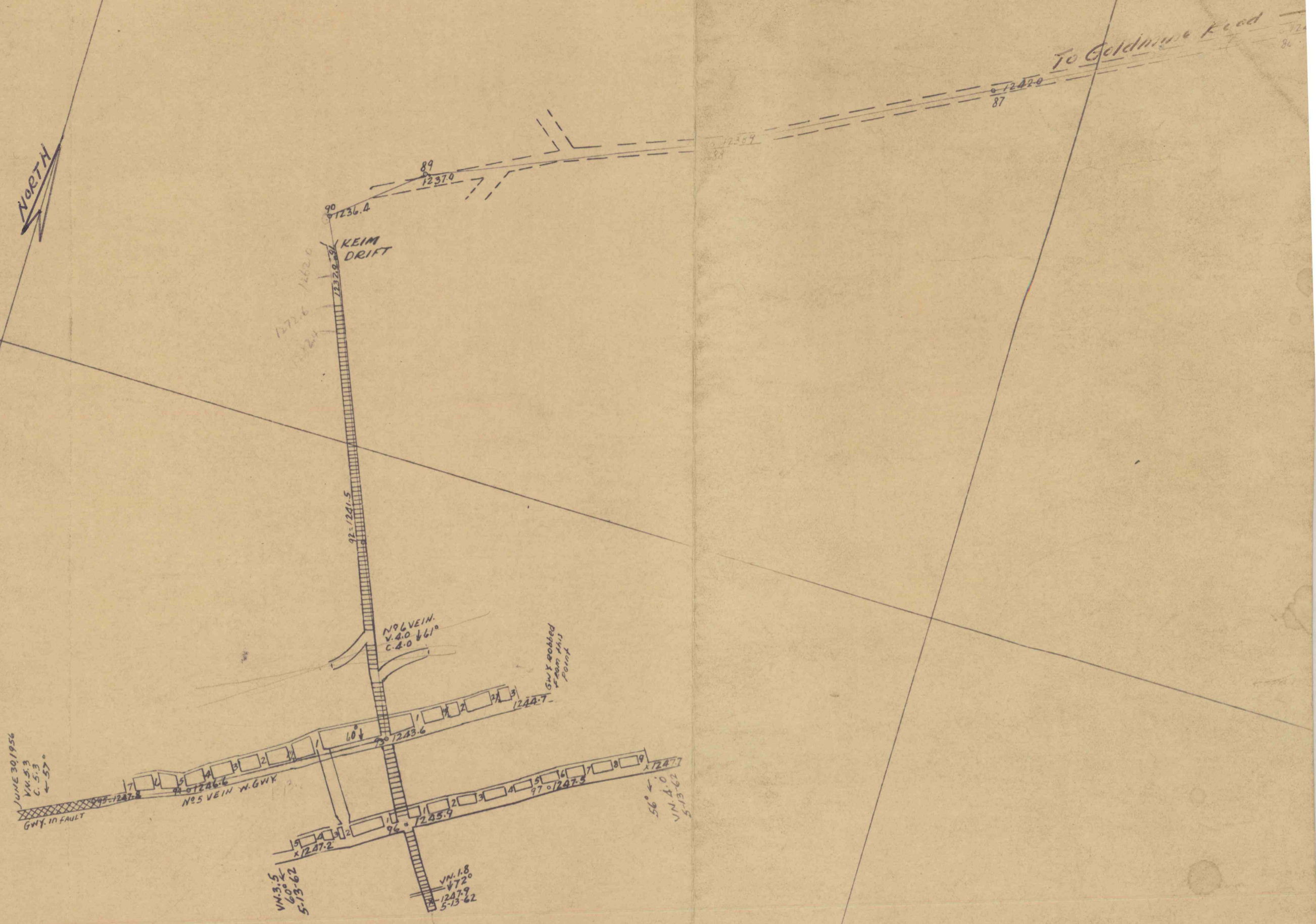

JUNE 30 1954  
V.M. 5.3  
C. 5.3  
4-57

V.M. 5.2  
40°-00'  
5-13-60

V.M. 1.8  
47°-20'  
1247.2  
5-13-62

GWK reached  
from this  
point

Scale 1"=100' John C. Briell  
Reg. Surv. N. 6307-E