

LEGEND

- PROPERTY BOUNDARY - LANCASTHIRE NO 25 MINE
- RESERVE AREA SUBDIVISION DESIGNATION
- DIAMOND DRILL HOLE LOCATIONS
- SEAM ISOPACH
- LIMIT OF MINEABLE RESERVES - 36" SEAM THICKNESS
- SANDSTONE CHANNEL WANT AREA
- RESERVE CATEGORY LINE (FIRST CLASS, SECOND CLASS)
- RESERVE CLASSIFICATION LINES (MEASURED, INDICATED)
- 50% MINING RECOVERY AREAS
- PROHIBITED MINING AREA
- MINE WORKINGS - LOWER FREEPORT "D" SEAM

SEAM THICKNESS INTERVAL

- 36"-42"
- +42"

LINEAR LINES (SUPPLIED BY BARNES & TUCKER CO)

TRACT BOUNDARY LINES

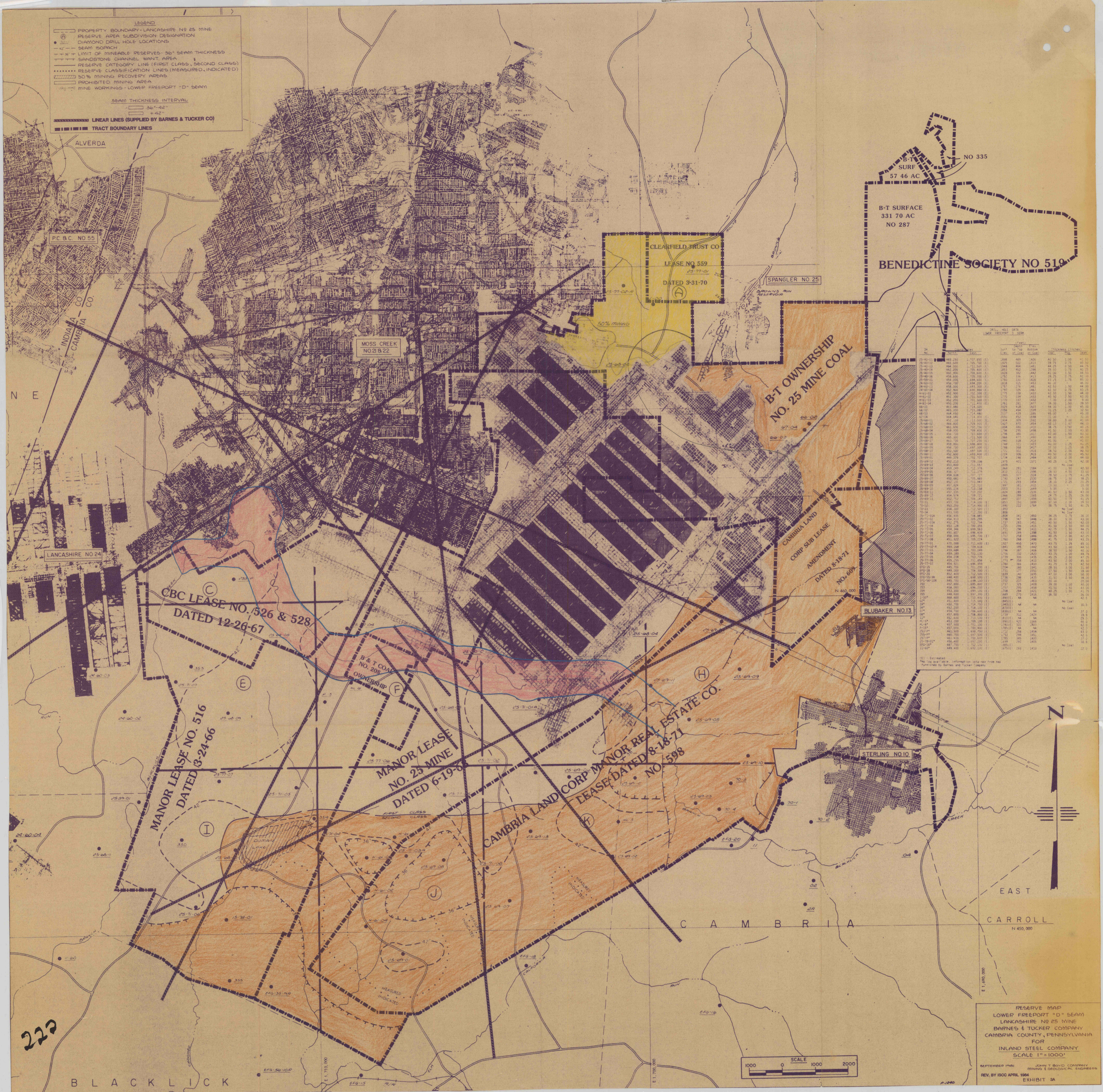

222

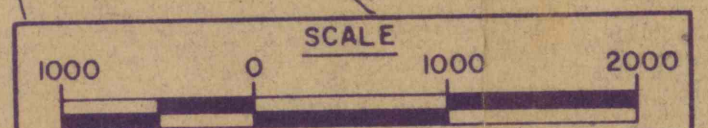

RESERVE MAP
LOWER FREEPORT "D" SEAM
LANCASTHIRE NO 25 MINE
BARNES & TUCKER COMPANY
CAMBRIA COUNTY, PENNSYLVANIA
FOR
INLAND STEEL COMPANY
SCALE 1"=1000'

SEPTEMBER 1961 JOHN T. BOYD COMPANY
MINING & GEOLOGICAL ENGINEERS
REV. BY 1800 APRIL 1964
EXHIBIT 3A