

PLAN FOR EXCHANGE OF COAL  
 BETWEEN  
**Blaine Coal Co.**  
 and  
**The M.R.C.C. & C.Co.**  
 FORWARD TOWNSHIP, ALLEGHENY CO., PA.  
 OCT 31, 1905  
 ENGINEERING DEPT. PENNSYLVANIA CO.

The M.R.C.C. & C.Co. Blaine Coal Co.		Blaine Coal Co. The M.R.C.C. & C.Co.	
No.	Acres	No.	Acres
1	14.94	2	27.16
4	5.07	3	57.19
5	78.54	4	10.00
7	22.61	4	10.00
Total	141.26	Total	142.27

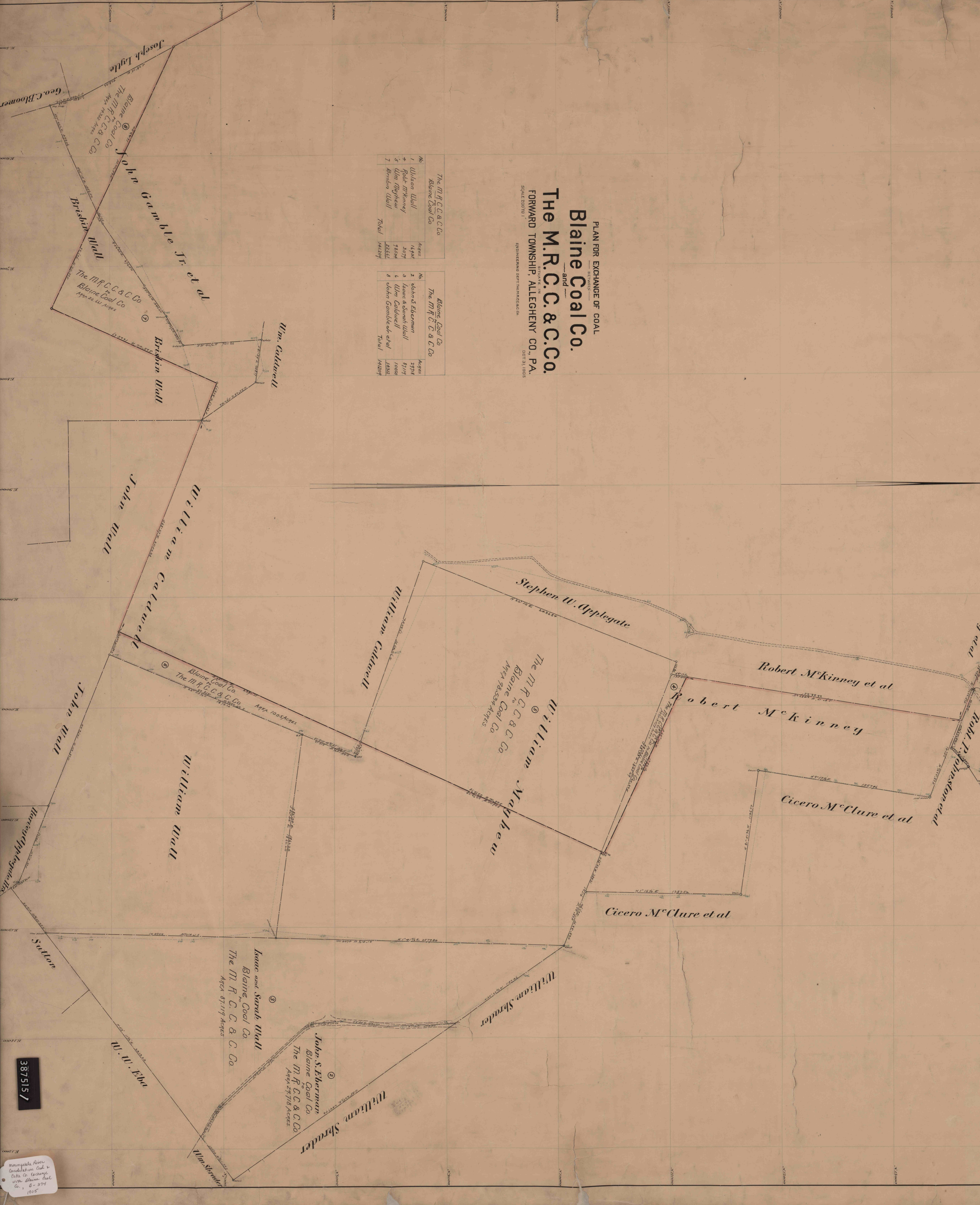

387515/

5081  
 142-8-8  
 Co. Blaine Coal  
 Exchange  
 Consideration Coal &  
 River  
 1905