

ENG. DEPT.
 Pittsburgh Coal Co.
 8-581
 N-10
 101-267
 Eng. Dept.

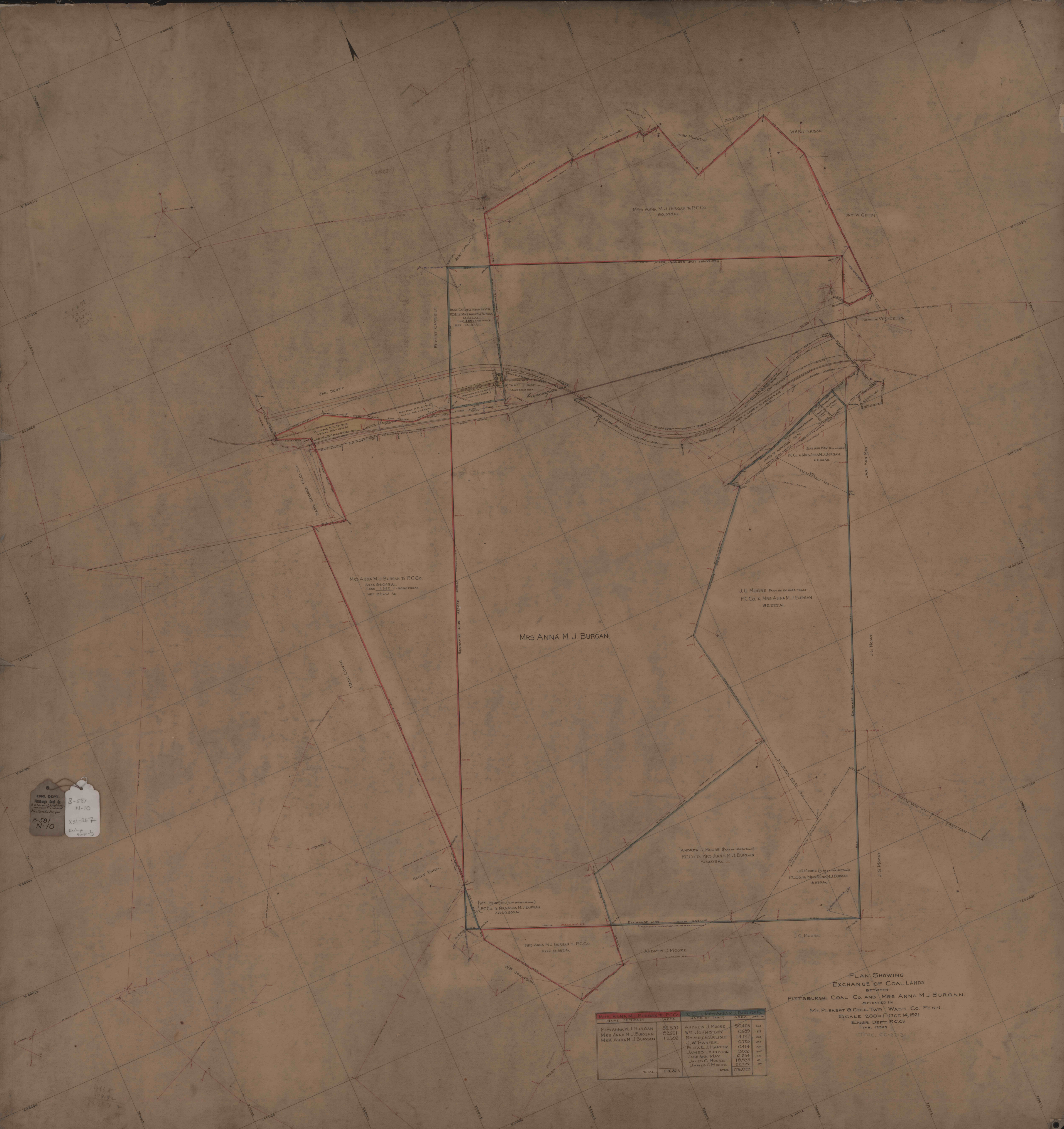

PLAN SHOWING
 EXCHANGE OF COALLANDS
 BETWEEN
 PITTSBURGH COAL CO AND MRS ANNA M. J. BURGAN
 SITUATED IN
 MT. PLEASANT & CECIL TWP. WASH. CO. PENN.
 SCALE 200' = 1" OCT 14, 1921
 ENGR. DEPT. P.C.C.O.
 TAB. 23265
 (THE. CO. 1373)

MRS. ANNA M. J. BURGAN	AREA	DATE OF TRANS.	AREA	P.C.C.O. TO MRS. ANNA M. J. BURGAN
MRS. ANNA M. J. BURGAN	20,570	ANDREW J. MOORE	50,405	221
MRS. ANNA M. J. BURGAN	22,222	WM. JOHNSTON	6,689	101
MRS. ANNA M. J. BURGAN	13,132	ROBERT CARLISLE	14,197	202
		J. W. HARTER	0,725	101
		ELIZA E. J. HARPER	0,414	101
		JAMES JOHNSTON	3,002	217
		JANE ANN MAY	6,634	214
		JAMES G. MOORE	19,535	211
		JAMES G. MOORE	22,222	211
TOTAL	176,823	TOTAL	176,823	