

Community Central Energy Corp. (Steam Pipe Line)  
1220 N. Washington Ave., Scranton, Pa.  
Telephone 717-343-2042

Bell Telephone Company of Penna. (Telephone Line)  
831 Adams Ave., Scranton, Pa. Telephone 717-346-4611

Penna. Gas and Water Company (Gas Pipe Line)  
39 Public Square, Wilkes Barre, Pa.  
Telephone 717-346-2073

Penna. Gas and Water Company (Water Pipe Line)  
39 Public Square, Wilkes Barre, Pa.  
Telephone 717-346-2073

Scranton Sewer Authority (Sewer Line)  
307 N. Washington Ave., Scranton, Pa.  
Telephone 717-342-7621

**LEGEND**

C - Denotes flushing borehole going to Clark Vein.  
T - Denotes flushing borehole going to Dunmore No. 1 Vein (Top Split).  
D - Denotes flushing borehole going to Dunmore No. 1 Vein.  
D2 - Denotes flushing borehole going to Dunmore No. 2 Vein.  
S - Denotes Supply Borehole.  
A - Denotes Access Borehole.

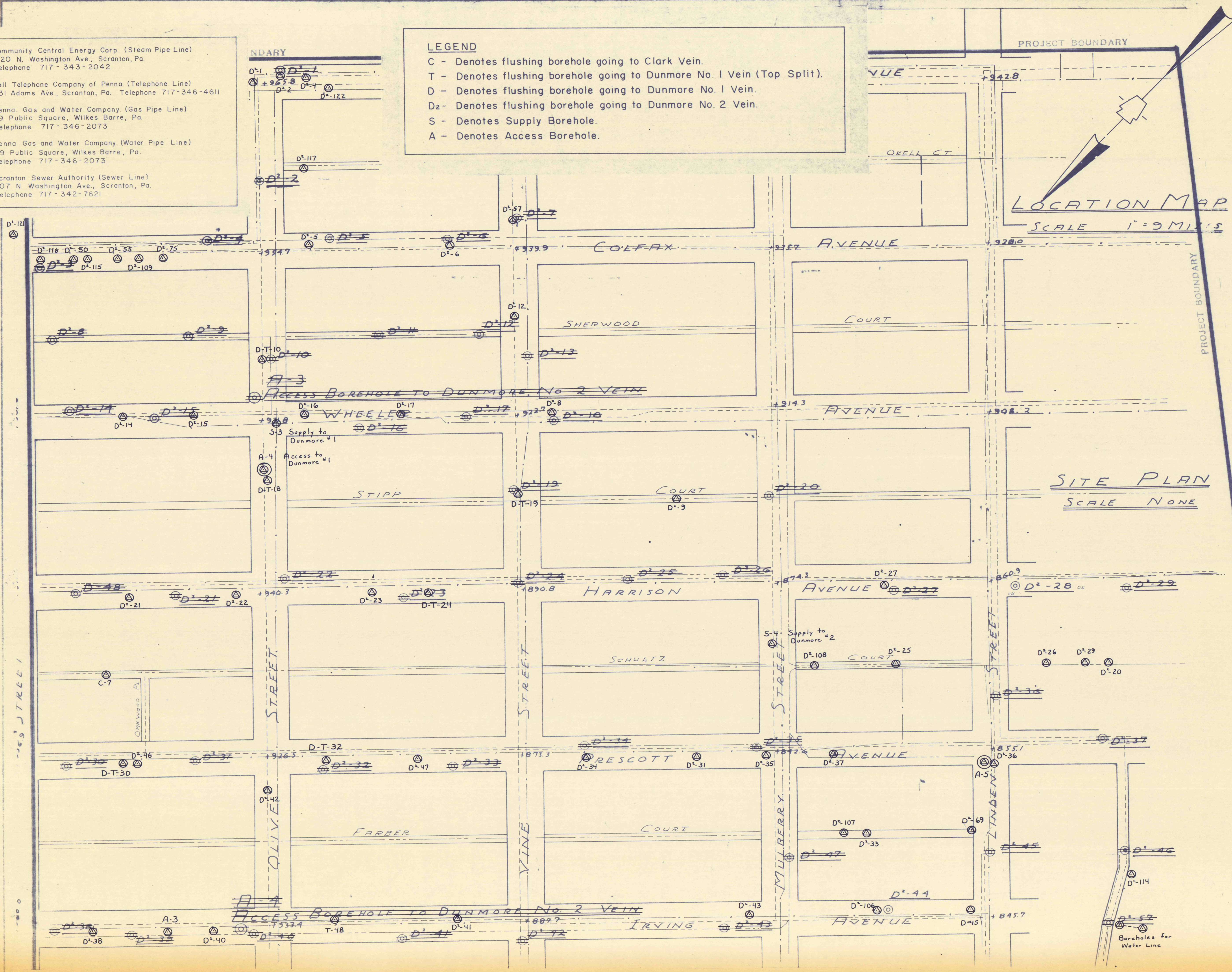

**LOCATION MAP**  
SCALE 1"=0.5 MILES

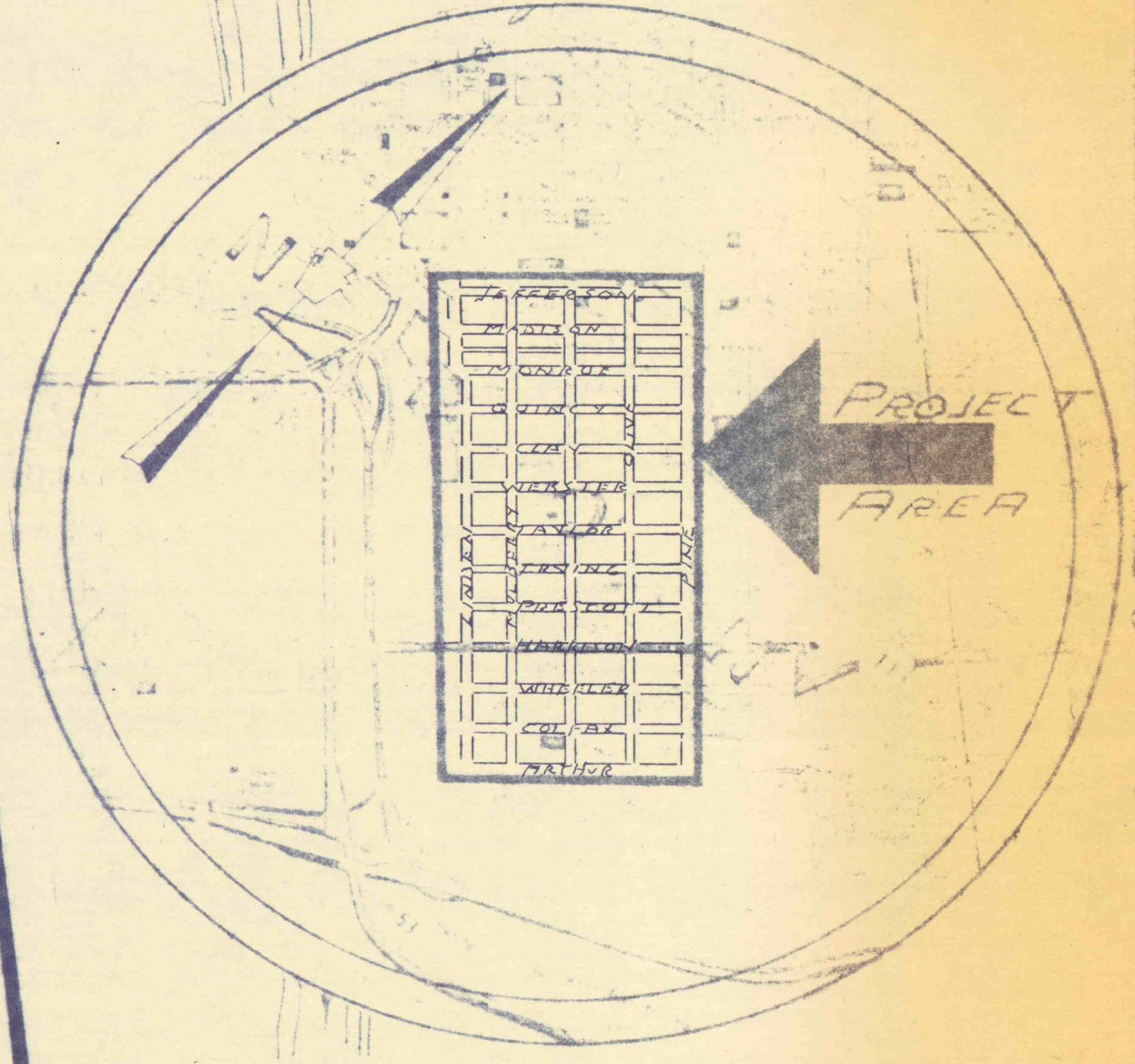
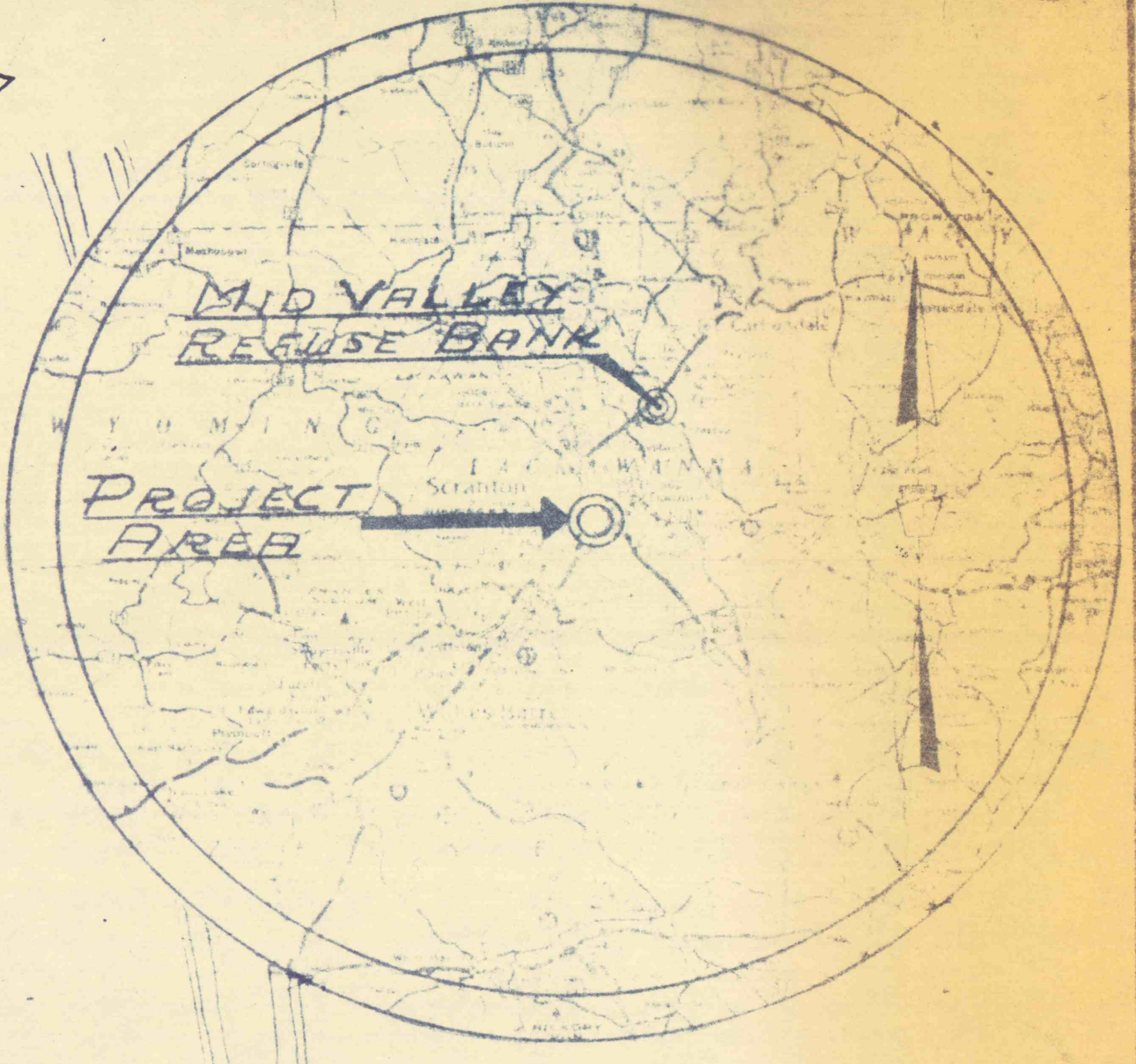

**SITE PLAN**  
SCALE NONE

⊕ - Relocated or Additional  
⊖ - Deleted Borehole

*S. E. Kyle for U. M. Brand*

PROJECT NO ASP-12-2

HYDRAULIC FLUSHING PROJECT  
HILL SECTION (PHASE II)  
SCRANTON, LACKAWANNA COUNTY

PLAN  
SURFACE (South Section)  
PINE BROOK MINE