

PLAN
Scale 1 in. = 100 ft.

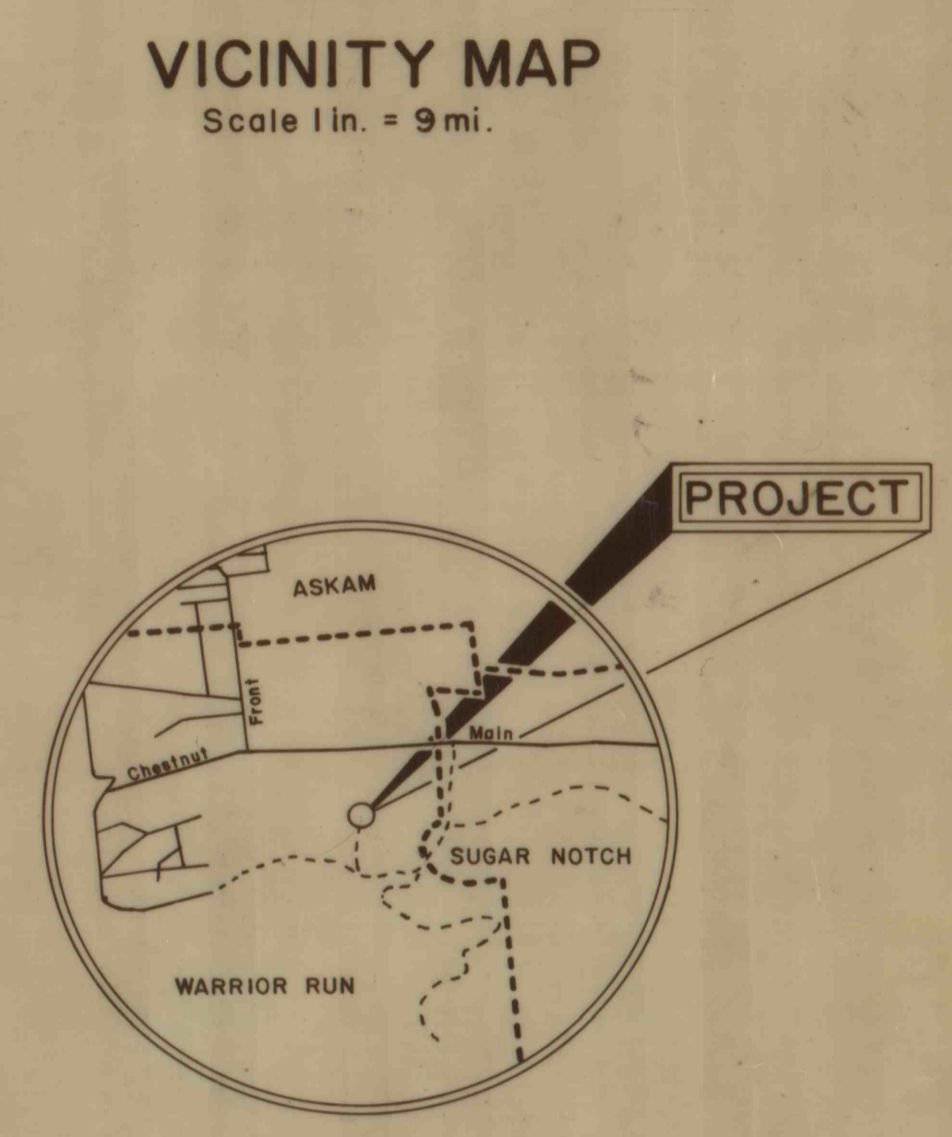

REFUSE BANK
(Light Woods)

Truesdale Colliery
No. 20 Tunnel Air Shaft
16 ft. Dia.
Surf. Elev. 839.5

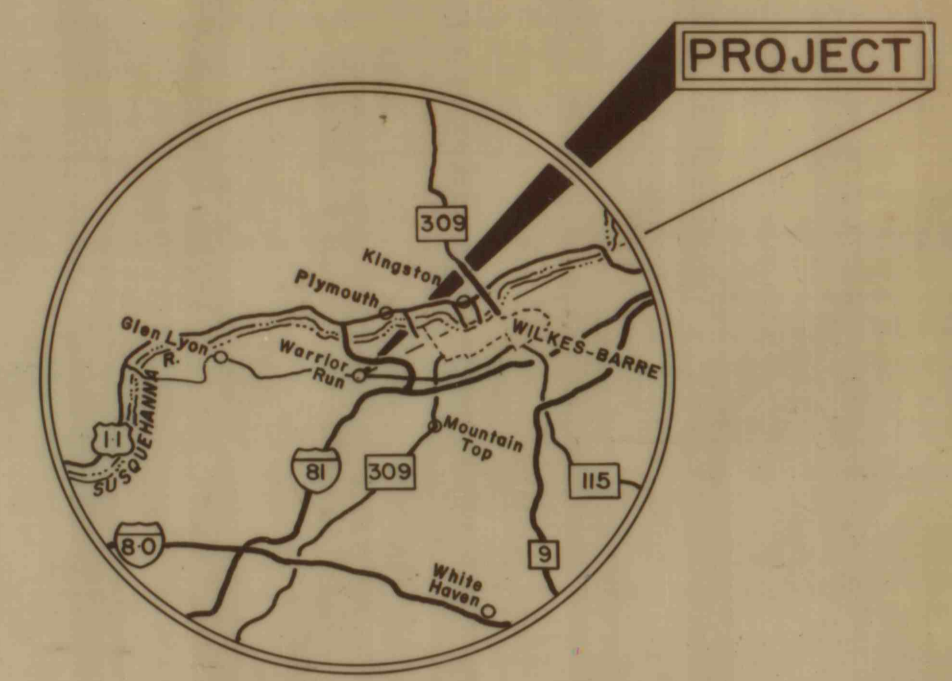
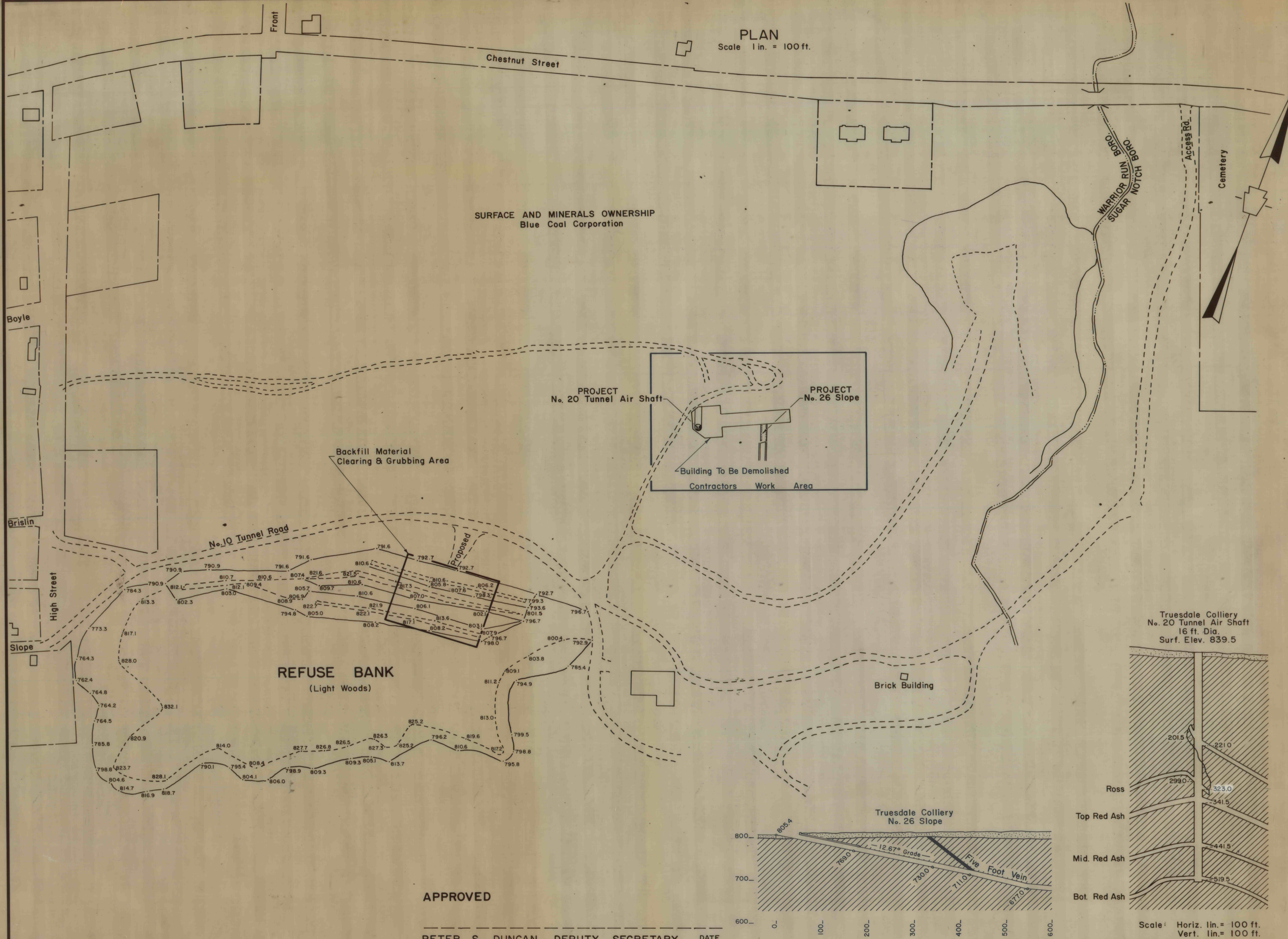
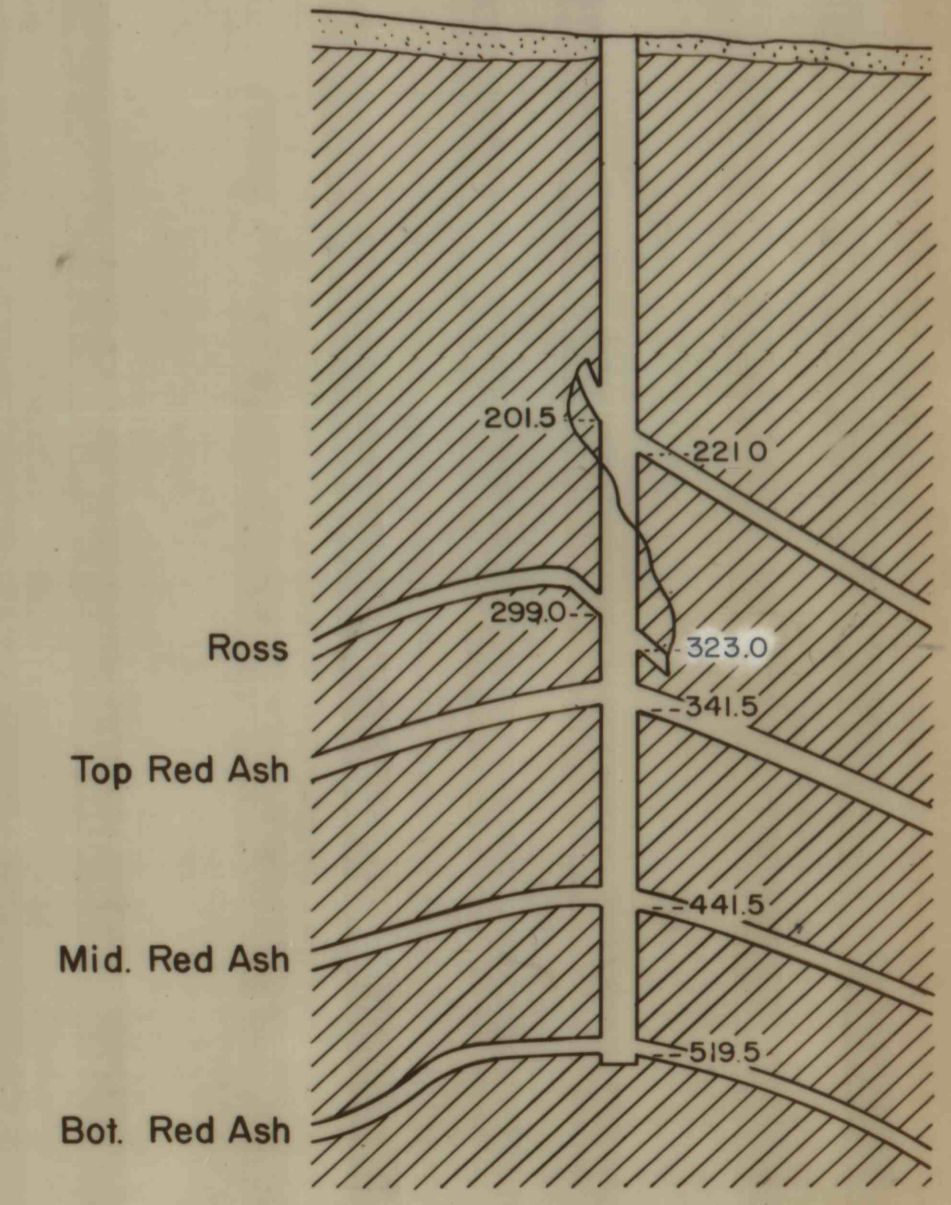
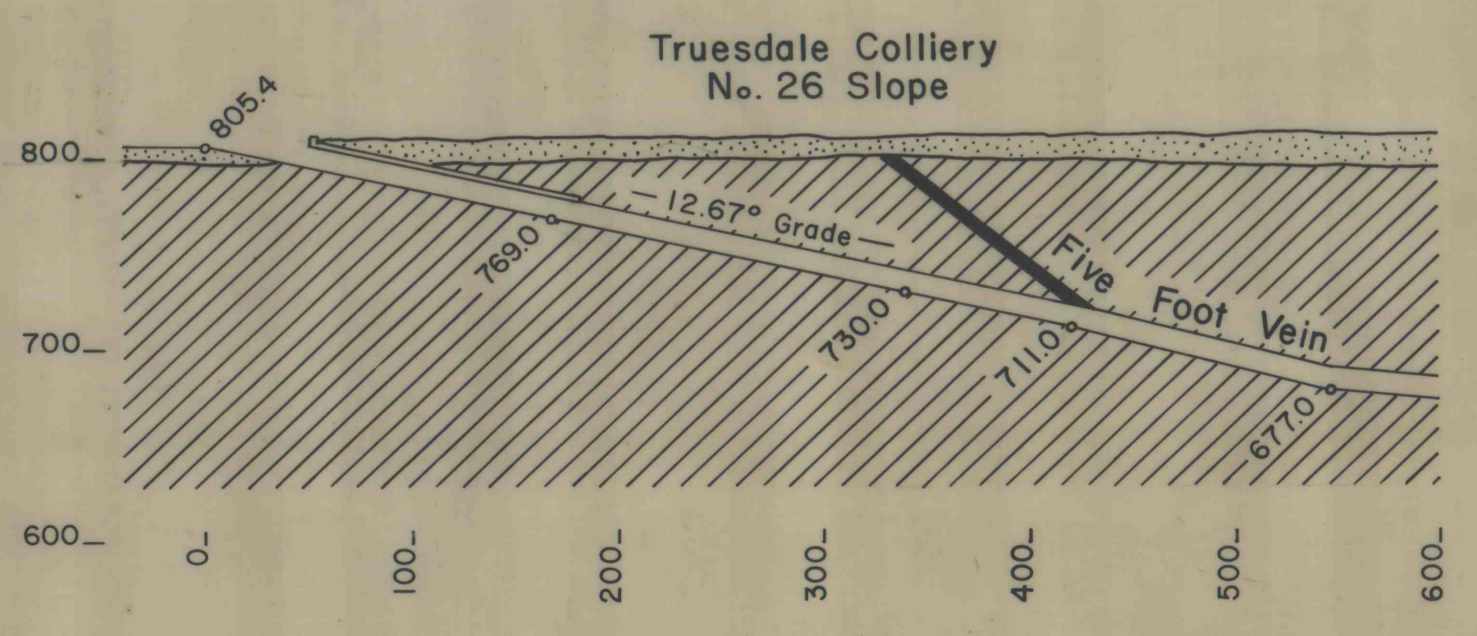

Scale: Horiz. lin. = 100 ft.
Vert. lin. = 100 ft.

APPROVED
PETER S. DUNCAN, DEPUTY SECRETARY FOR RESOURCES MANAGEMENT

NO.	DATE	REVISION	APPR.

SUBMITTED *Robert J. Stepanowski, D.E.*
DESIGNER
APPROVED *Stephen P. Zanchek, P.E.*
DISTRICT OPERATIONS SUPERVISOR, WILKES BARRE
APPROVED _____
DIRECTOR, BUREAU OF RESOURCES PROGRAMMING

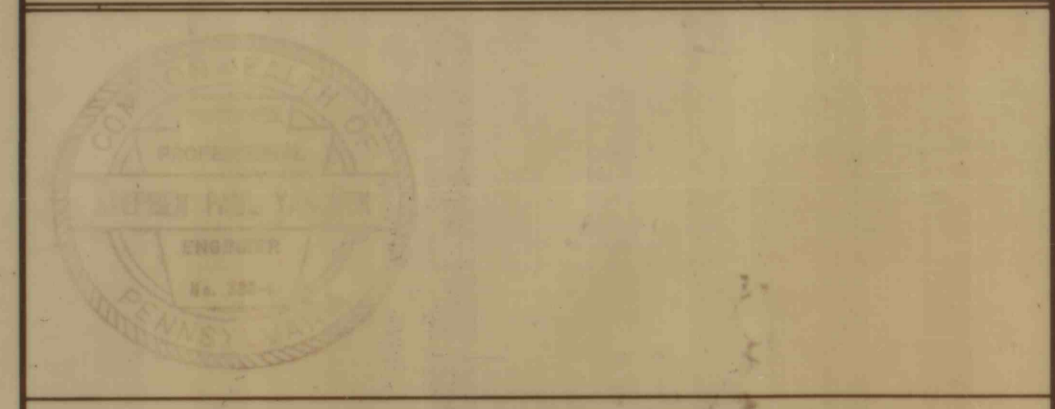

COMMONWEALTH OF PENNSYLVANIA
DEPARTMENT OF ENVIRONMENTAL RESOURCES
OFFICE OF RESOURCES MANAGEMENT

PROJECT NO. OSM 40 (045-80) 101.1
**BACKFILLING THE ABANDONED
No. 20 TUNNEL AIR SHAFT &
No. 26 SLOPE
TRUESDALE COLLIERY
WARRIOR RUN BORO, LUZERNE CO., PA.**

**PLAN, REFUSE BANK,
LOCATION AND VICINITY MAPS**

DRAWN BY	DATE	DRAWING NO.
CHECKED BY	SCALE As Shown	1 of 1