

B.H.#745
 1.9' Coal
 0.9' Sand
 0.4' Sand
 2.5' Coal
 2.9' 7.7'
 (10' P.R.L.)
 39' Interval to Rest
 35' " " B.R.A.

B.H.#732
 2.5' Coal
 0.3' Sand
 0.3' Sand
 2.7' Coal
 3.3' 11.8'
 29' Interval to Rest
 51' " " B.R.A.

B.H.#499
 Drilled 1949 for
 drainage to Rest to B.A.
 Rest to B.A. - 371'
 Interval - Sandstone - 710'
 1.4' Coal
 2.4' Sandstone
 1.1' Sandstone
 1.1' Sandstone
 1.6' Sandstone
 2.8' Sandstone
 Interval to B.A. 83'

B.H.#336
 Drilled for
 Top Red Ash
 But Red Ash (1947)
 Interval to B.A. 311'
 0.5' Coal
 Sandstone
 0.7' Coal
 3.0' Coal
 0.8' Coal
 1.8' Coal
 0.5' Coal
 0.4' Coal
 0.10' Coal
 7.1' 13.10'

B.H.#342
 Drilled on 70' Pitch
 from Bottom Red Ash
 Interval from B.A. to
 1500' 421'
 Shows very laminated
 conditions thru 34' to
 60' drilling

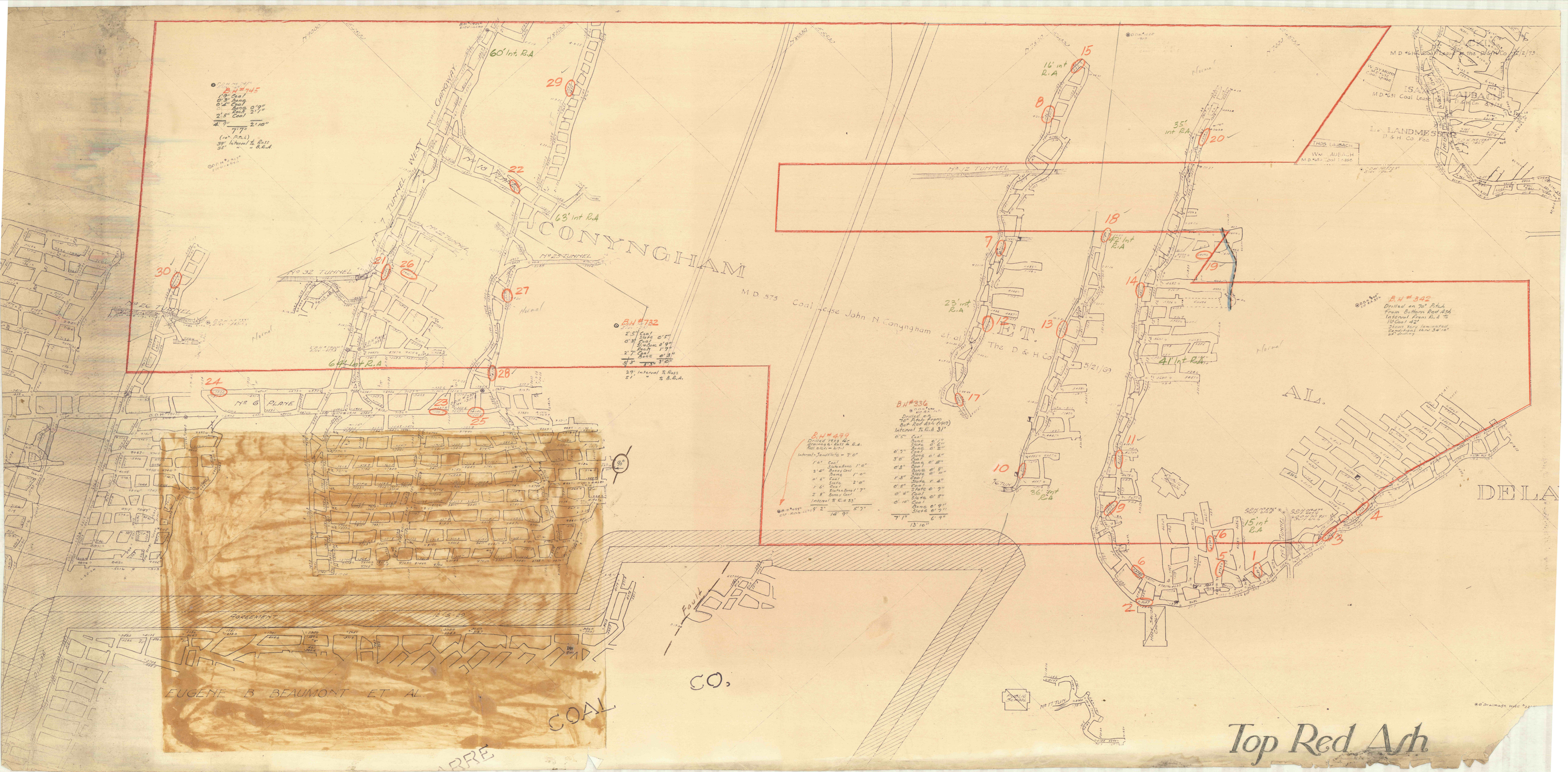

Top Red Ash