

#15 Transition Curves
 $\Delta = 9^{\circ}50'$
 $D = 8^{\circ}00'$
 $R = 716.78'$
 $T = 51.66'$
 $L = 123.05'$
 Offset 2.23

Compound Curve
 $\Delta = 19^{\circ}30'$
 $D = 12^{\circ}15'$
 $R = 353.98'$
 $L = 120.47'$
 Super Elev 2.00

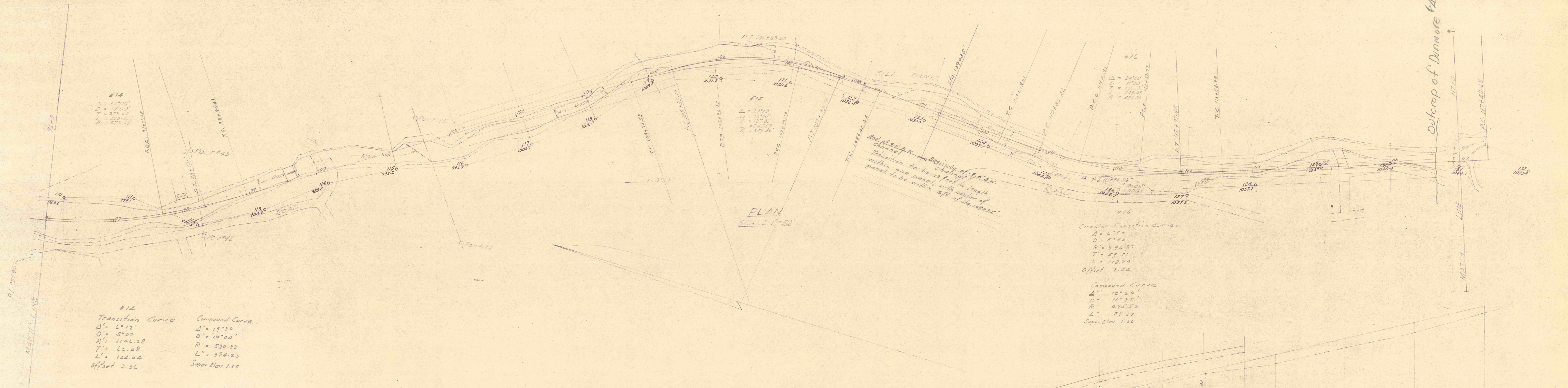

#14
 $\Delta = 5^{\circ}00'$
 $D = 10^{\circ}00'$
 $R = 273.24'$
 $T = 50.15'$
 $L = 77.49'$

#14
 Transition Curve
 $\Delta = 6^{\circ}12'$
 $D = 5^{\circ}00'$
 $R = 1146.28'$
 $T = 62.08'$
 $L = 124.04'$
 Offset 3.36

Compound Curve
 $\Delta = 19^{\circ}30'$
 $D = 10^{\circ}04'$
 $R = 570.33'$
 $L = 324.23'$
 Super Elev. 1.25

#16
 Circular Transition Curves
 $\Delta = 4^{\circ}50'$
 $D = 5^{\circ}45'$
 $R = 996.87'$
 $T = 59.51'$
 $L = 118.99'$
 Offset 3.54

Compound Curve
 $\Delta = 10^{\circ}20'$
 $D = 11^{\circ}35'$
 $R = 495.52'$
 $L = 89.37'$
 Super Elev 1.30

PROFILE
 SCALE 1" = 10' VERT

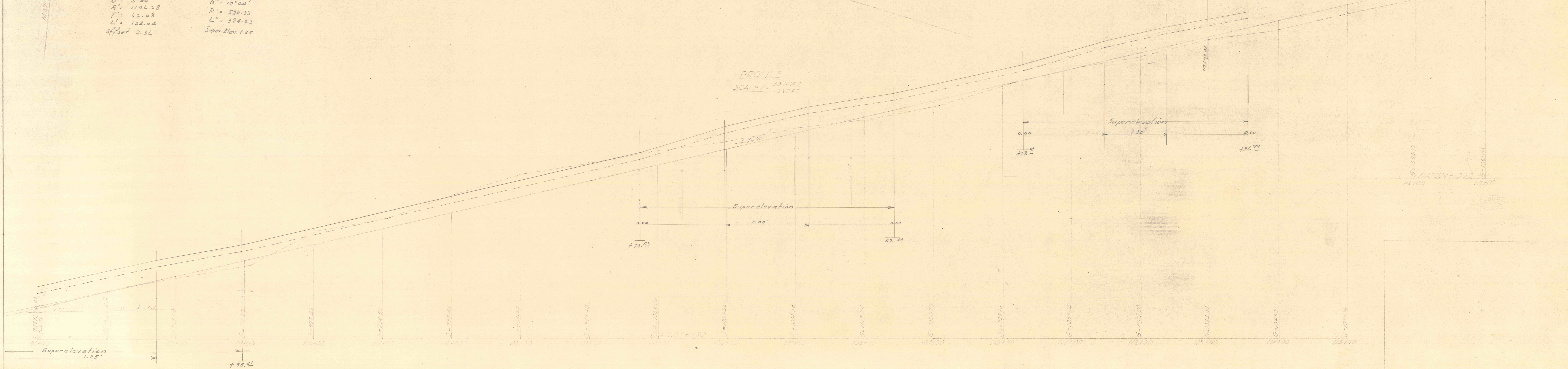

Outcrop of Dunmore #4 Bed.