

PC. Co. 6
Sta. No. 10965
(Approx. loc.)

10965

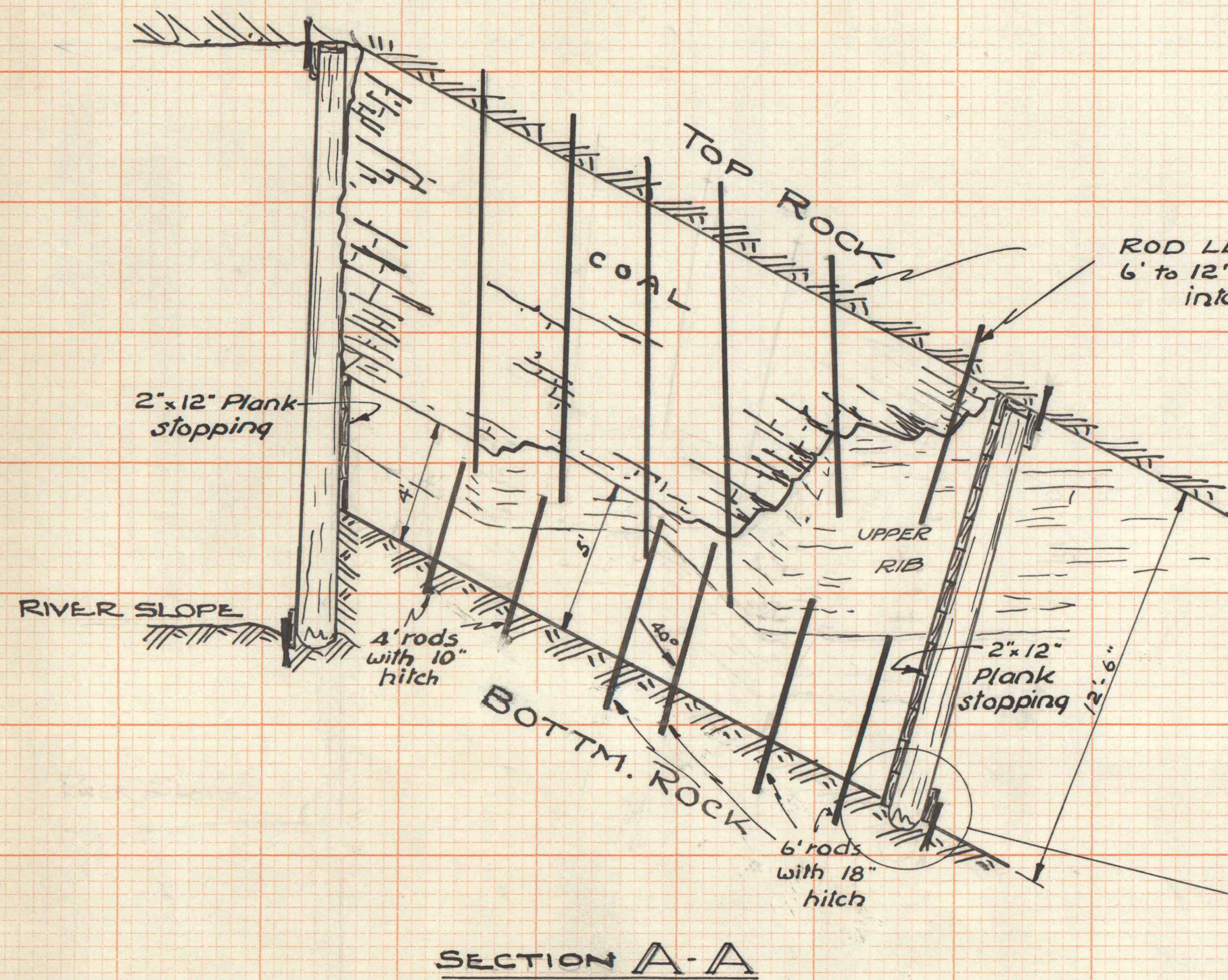
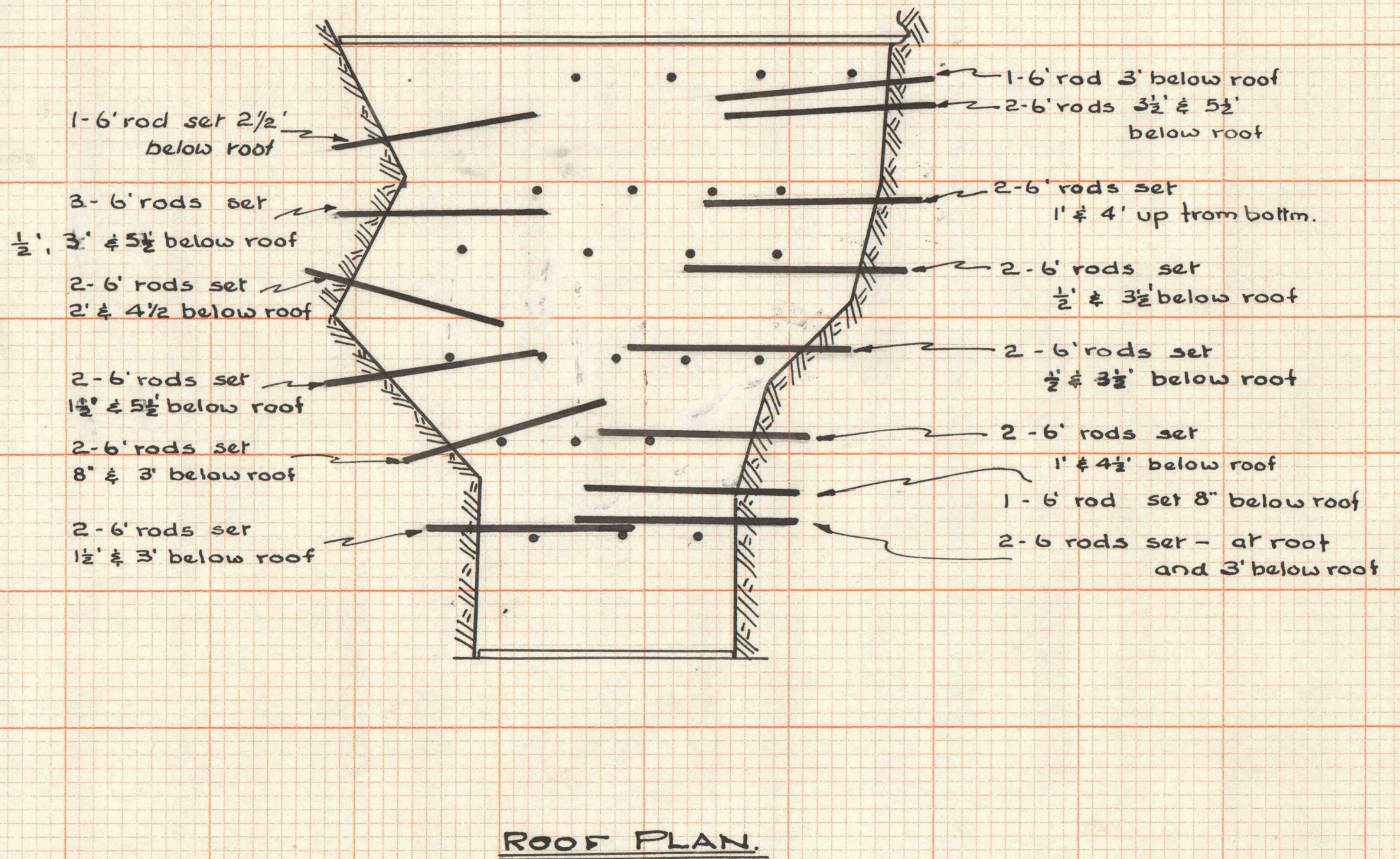
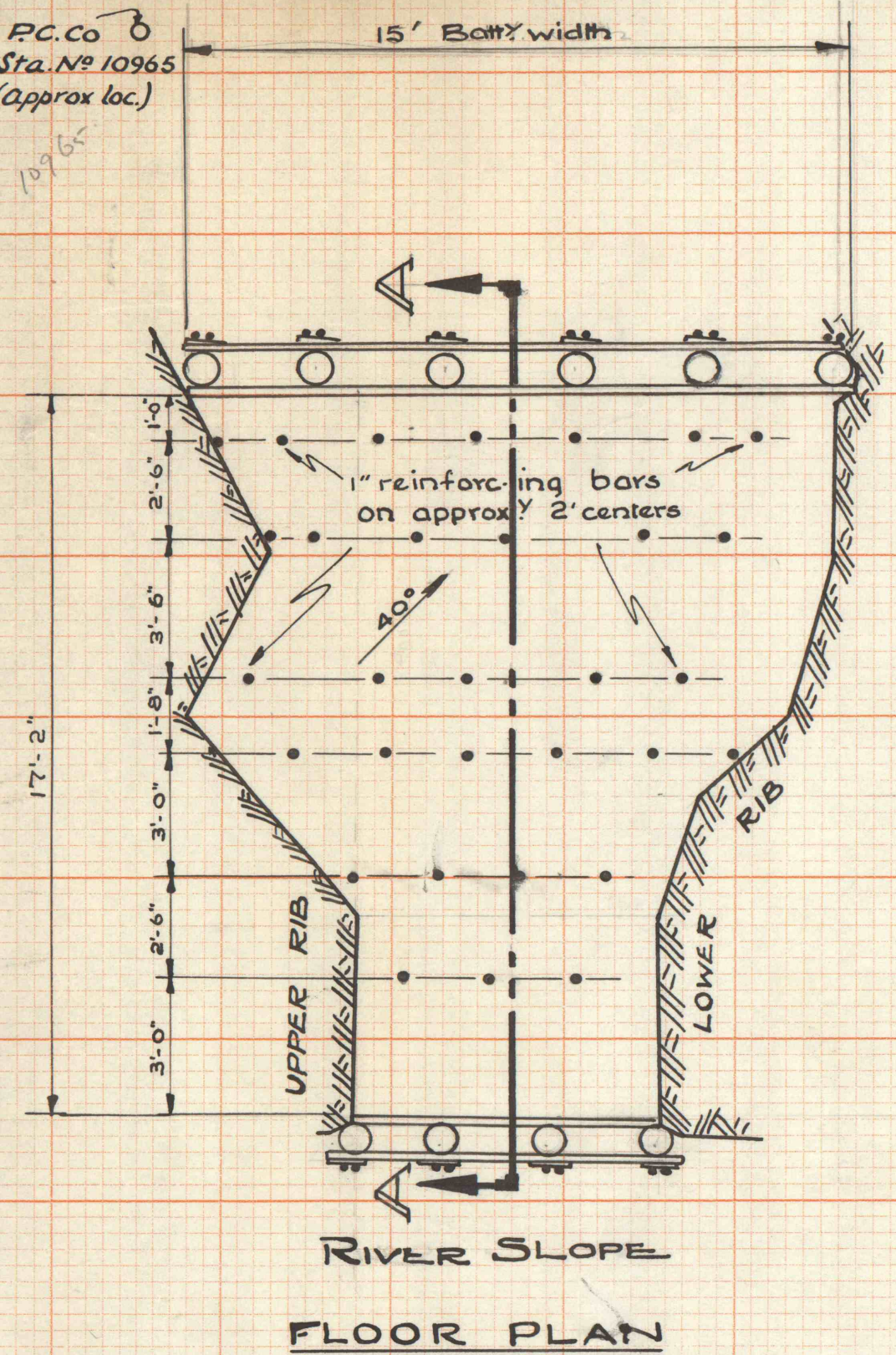

ROD LENGTHS
6' to 12' hitched 18"
into top rock

Note: Reinforcing bars will be interlaced with and securely fastened to 1/2" steel rope

Split wedge pins to be placed as near opposite center of props as possible

ESTIMATED CONC. REQ'D = 54 cu. yds.
(AMOUNT CONC. USED = 45 cu. yds.)

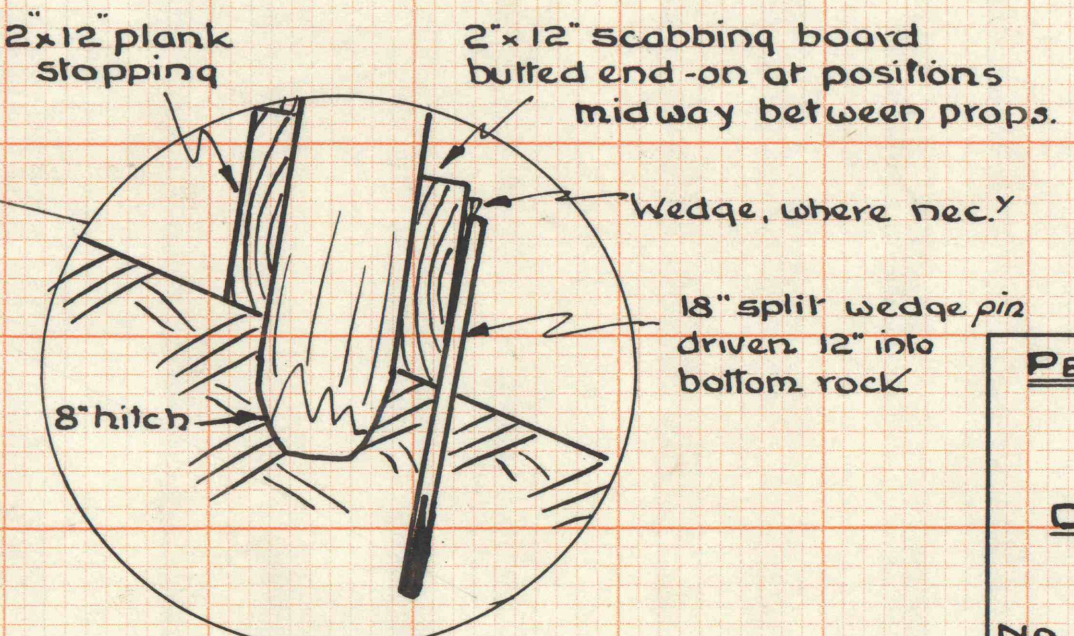

PENNSYLVANIA DEPT OF MINES
AND MINERAL INDS.

**DETAILS OF REINFORCED
CONCRETE DAM.**

No. 1 CROSSCUT LEFT, RIVER SLOPE
PITTSBURGH V. PORT GRIFFITH, PA.
PENNSYLVANIA COAL CO.

8-10-59
Dr. V.U.

Scale 1" = 4 ft