

LR 40116 A10
Luz Co.

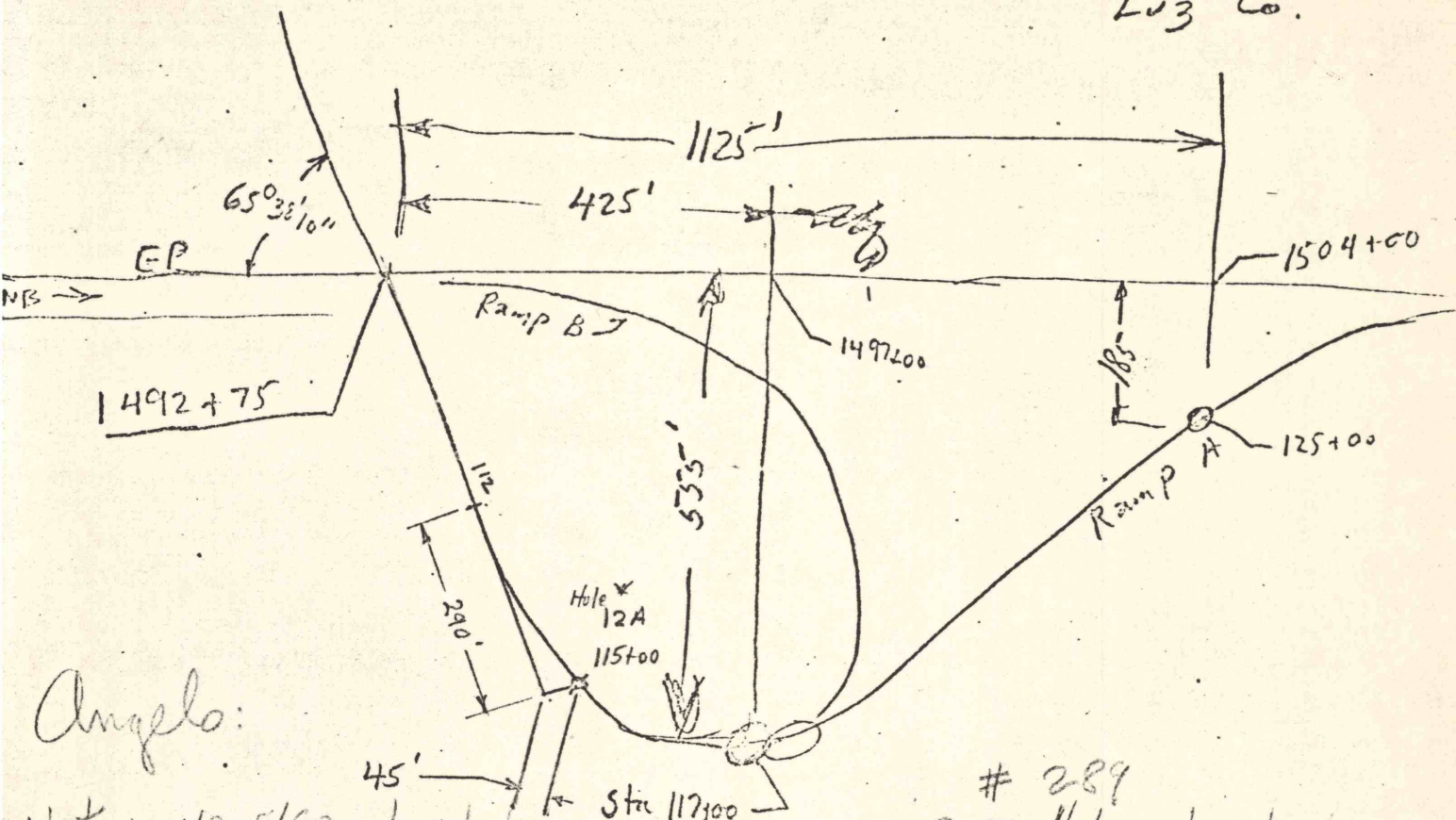

Angelo:

Note: 11/25/80 - Located AN OLD MINE BORE Hole located
72.90 FT Lt "A" LINE POST 112+85.15. Elev Top B/H = 897.56 -
GROUND Elev. 896.7 FT Old PAUL LOCKS WANTS THIS INFO Sta
Locate Bore Hole at approx 112

Set Sta 114+90 on Sub Tang

New Bore Hole

RT \approx 45'

Note: 11/29/80

#15

Angelo:

The driller were already drilling when we started
to s/o as requested above. However, we located the actual
drill hole as follows: 70 FT Lt Post "A" LINE 115+30
Elev 932.4 FT