

PENNSYLVANIA

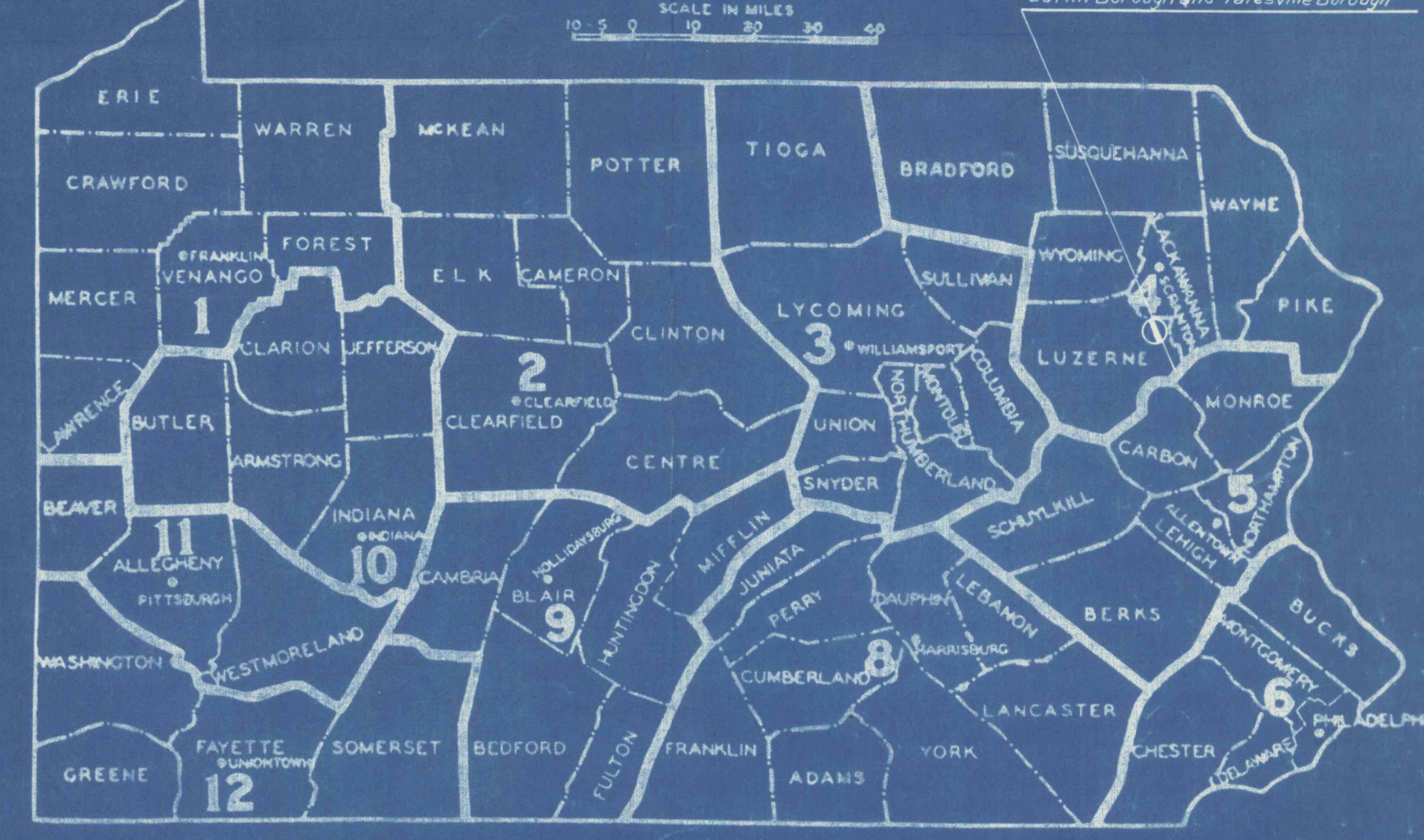

4 - DISTRICT
• - DISTRICT OFFICES

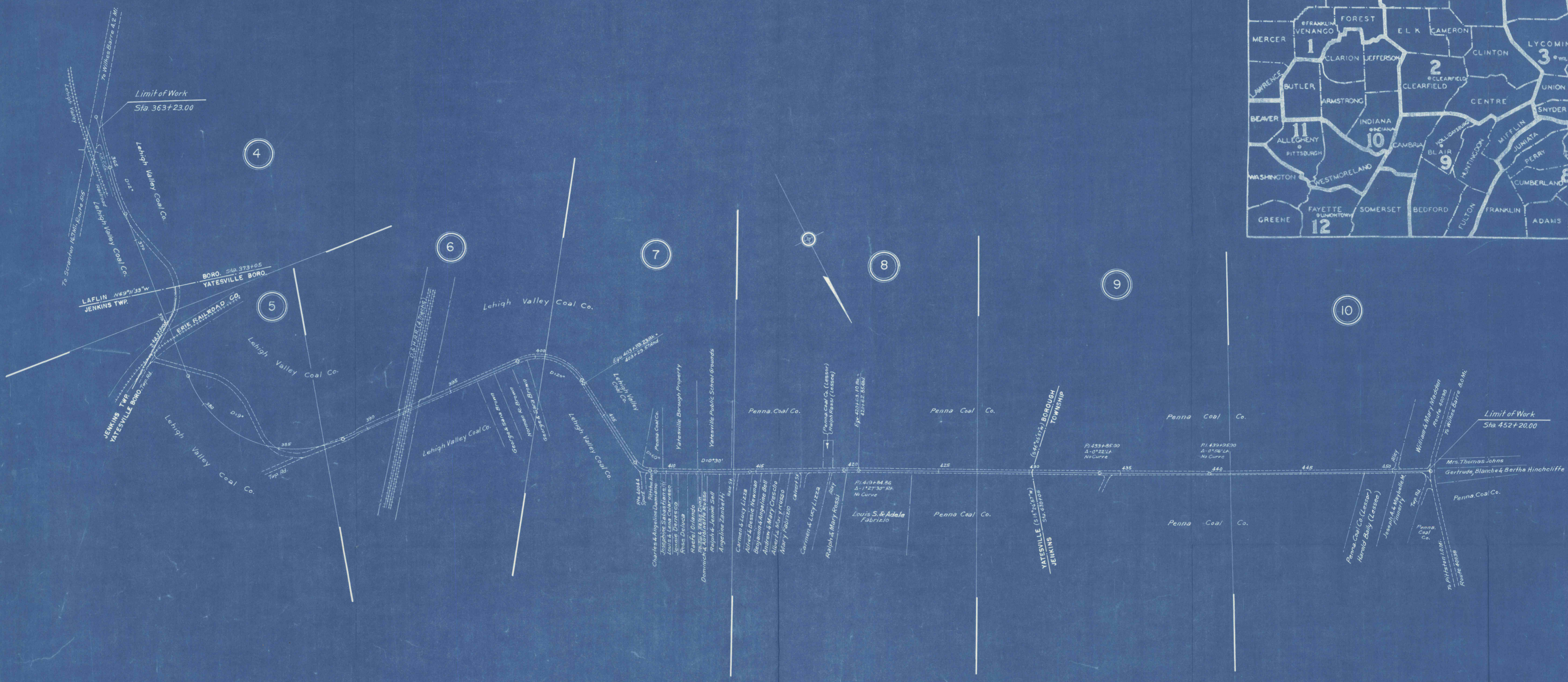

RECORD OF STATIONS OF EXISTING ROAD TYPES

Adjacent to Sta. 363 + 23	Concrete - 20' Wide and 12' Bit Conc. Surf. on Nat. Stone Base Rt. & Lt.
Sta. 363+23 to Sta. 368+00	Pen. Surf. Nat. Stone Base 14' Wide
Sta. 368+00 to Sta. 389+00	Relocation
Sta. 389+00 to Sta. 431+84	Pen. Surf. Native Stone Base 14' Wide
Sta. 431+84 to Sta. 452+20	Surf. Treated Native Stone Base 14' Wide
Adjacent to Sta. 452+20	Macadam 20' Wide