

DISTRICT	COUNTY	ROUTE	SEC.	SHEET
4-0	LUZERNE	4003	4	8 of 11

Pittston Township

**REQUIRED LIST**

- 609 Sta. 411+20 to Sta. 417+10 Lt. 580 L.F. 6" Pipe Fdn. Udrain, Type A Type II Bfill.
- 9 18 L.F. 6" Pipe Udrain Outlets
- 342 Sta. 413+50 to Sta. 417+40 Rt. 320 L.F. 6" Pipe Fdn. Udrain, Type A Type II Bfill.
- 15 70 L.F. 6" Pipe Udrain Outlets
- Sta. 416+22.20 to Sta. 420+22.20 Lt. Acceleration Lane
- ✓ 333 S.Y. 2 1/2" Bit Surf Crse. ID-2
- ✓ 333 S.Y. 12" Cr. Aggr. Base Crse. Type AP
- Sta. 417+82.23 to Sta. 420+32.23 Rt. Deceleration Lane
- ✓ 167 S.Y. 2 1/2" Bit Surf Crse. ID-2
- ✓ 167 S.Y. 12" Cr. Aggr. Base Crse. Type AP
- 69 Sta. 421+07.90 to Sta. 422+82.90 Rt. Escape Lane
- 69 70 S.Y. 2 1/2" Bit Surf Crse. ID-2
- 69 70 S.Y. 12" Cr. Aggr. Base Crse. Type AP
- RAMP A**
- 1429 Sta. 0+00.00 to Sta. 6+29.53
- 1471 ~~150~~ S.Y. 2 1/2" Bit Surf Crse. ID-2
- 2036 ~~130~~ S.Y. 12" Cr. Aggr. Base Crse. Type AP
- 2036 ~~207~~ S.Y. 6" Special Subgrade
- 285 500 L.F. Stabilized Shoulders
- RAMP B**
- 1810 Sta. 0+00.00 to Sta. 8+67.93
- 1908 ~~150~~ S.Y. 2 1/2" Bit Surf Crse. ID-2
- 2866 ~~170~~ S.Y. 12" Cr. Aggr. Base Crse. Type AP
- 2866 ~~250~~ S.Y. 6" Special Subgrade
- 766 500 L.F. Stabilized Shoulders

See P. Spitt for Book.  
 + Section 5 per 417 to 420 for mining Dept.

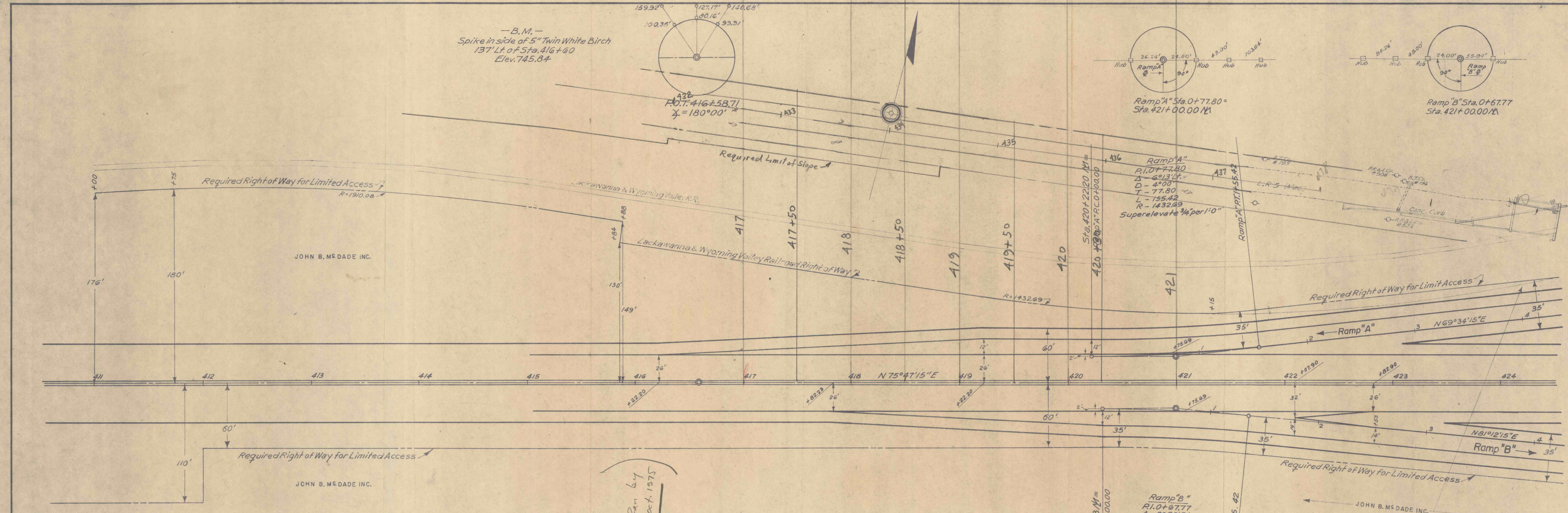

**NOTE**  
 Section lines run by 566 Survey Corps 27 Oct. 1975

