

DISTRICT	COUNTY	ROUTE	SECTION	SHEET
4-0	LUZERNE	40036		6 of 13
ASHLEY BOROUGH				
ALTERNATE 1 - EXISTING ALIGNMENT				

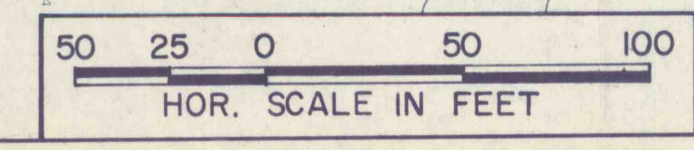
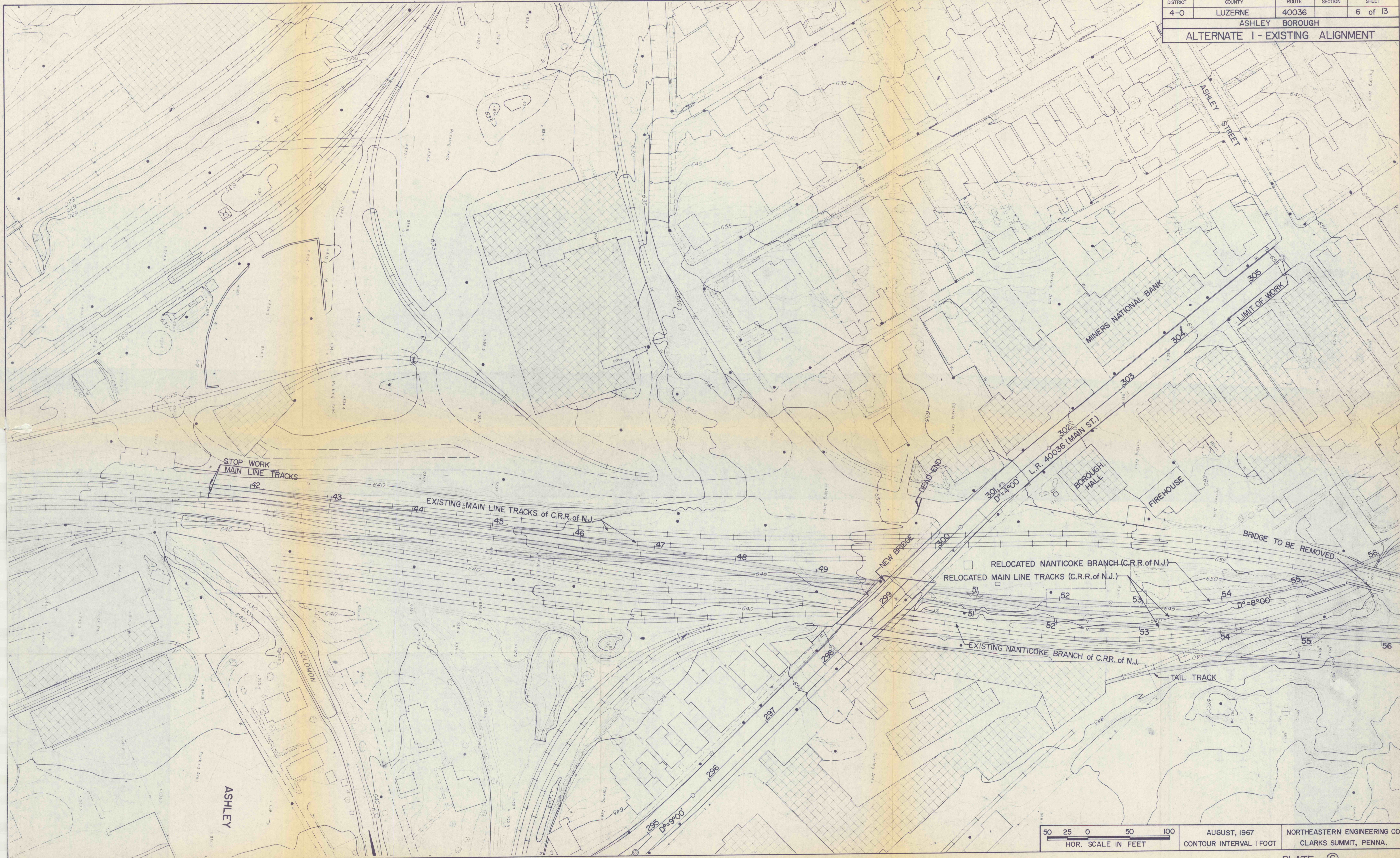

AUGUST, 1967
 CONTOUR INTERVAL 1 FOOT
 NORTHEASTERN ENGINEERING CO.
 CLARKS SUMMIT, PENNA.