

B.M. #11B Elev. 707.51
R.R. Spike in Power Pole
293' Lt. of Sta. 138+05, L.R. 786

B.M. #12 Elev. 713.79
R.R. Spike in 12" Maple
290' Lt. of Sta. 138+38, L.R. 786

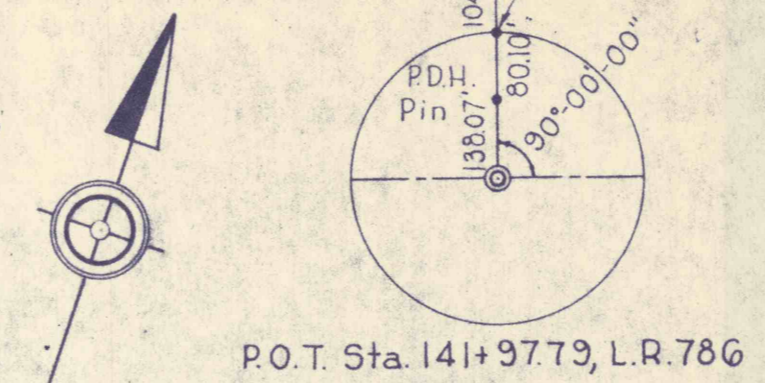

PI. Sta.	Δ (No Curve)	Bearing
16+53.00	30° 00' 00" Rt.	S. 14° 42' 23" E.
16+81.00	15° 00' 00" Rt.	S. 15° 17' 37" W.
18+84.00	15° 00' 00" Lt.	S. 30° 17' 37" W.
19+71.00	15° 00' 00" Lt.	S. 15° 17' 37" W.
19+96.00	15° 00' 00" Lt.	S. 0° 17' 37" W.
20+21.00	15° 00' 00" Lt.	S. 14° 42' 23" E.
20+46.00	15° 00' 00" Lt.	S. 29° 42' 23" E.
20+71.00	15° 00' 00" Lt.	S. 44° 42' 23" E.
20+96.00	15° 00' 00" Lt.	S. 59° 42' 23" E.
21+21.00	15° 00' 00" Rt.	S. 74° 42' 23" E.
21+46.00	15° 00' 00" Rt.	S. 44° 42' 23" E.

REQUIRED LIST

- L. R. 786**
- Sta. 138+00
 - 76 L.F. 18" R.C.C. Pipe, Cl. III
 - 1 Type 4 ft. Inlet (Median)
 - 1 Type H Inlet (Rt.)
 - 24 C.Y. Crse. Aggr. for Pipe Trench B'fill
 - 42 C.Y. Cl. 2 Exc. (Pipe) (Cl. C Bedding)
 - Sta. 141+00
 - 114 L.F. 18" R.C.C. Pipe, Cl. III
 - 1 Type 4 ft. Inlet (Median)
 - 34 C.Y. Crse. Aggr. for Pipe Trench B'fill
 - 86 C.Y. Cl. 2 Exc. (Pipe) (Cl. C Bedding)
 - 2 C.Y. Cl. 2 Exc. (Outlet Ditch, Lt., 18" Bottom)
 - Sta. 144+00
 - 48 L.F. 18" R.C.C. Pipe, Cl. III
 - 60 L.F. 18" B.C.C.G.M. Pipe, Cl. I-B (2 3/4" x 1/2" Corrg.) 16 Ga.
 - 1 Type 4 ft. Inlet (Median)
 - 16 C.Y. Crse. Aggr. for Pipe Trench B'fill
 - 40 C.Y. Cl. 2 Exc. (Pipe) (Cl. C Bedding)
 - 2 C.Y. Cl. 2 Exc. (Outlet Ditch, Lt., 18" Bottom)
 - Sta. 146+36.50 (Sta. 16+31 to Sta. 22+50)
 - Channel Change (10 ft. Bottom)
 - 635 C.Y. Cl. 1 Exc.
 - Sta. 147+00
 - 48 L.F. 18" R.C.C. Pipe, Cl. III
 - 130 L.F. 18" B.C.C.G.M. Pipe, Cl. I-B (2 3/4" x 1/2" Corrg.) 16 Ga.
 - 1 Type 4 ft. Inlet (Median)
 - 16 C.Y. Crse. Aggr. for Pipe Trench B'fill
 - 63 C.Y. Cl. 2 Exc. (Pipe) (Cl. C Bedding)
 - 25 C.Y. Cl. 2 Exc. (Outlet Ditch, Lt., 18" Bottom)
 - Sta. 135+75 to Sta. 143+46, Rt.
 - 113 C.Y. Topsoil Furnished & Placed
 - Sta. 148+75 to Sta. 149+50
 - Bench Cut, Lt.
 - 431 C.Y. Cl. 1 Exc.
 - 431 C.Y. Emb. (B'fill)
 - 75 L.F. 6" Pipe Fdn. U'drain, Type B, Type II B'fill
 - 35 L.F. 6" Pipe U'drain Outlets
 - 0.1 C.Y. Cl. B Cem. Conc. (Outlet Edw.)
 - See Detail Sheet No. 7
 - Sta. 146+36.50
 - R.C. Box Culvert, 545'-9" Long
 - Span 10'-0" Min. Clear 10'-0"
 - Skew: Varies
 - 304 C.Y. Cl. 1 Exc.
 - 570 C.Y. Cl. 2 Exc.
 - 1419 C.Y. Cl. A Cem. Conc.
 - 77 C.Y. Cl. B Cem. Conc.
 - 248,060 Lbs. Reinforcement Bars
 - 1,045 C.Y. Selected Borrow Exc. Struct. B'fill

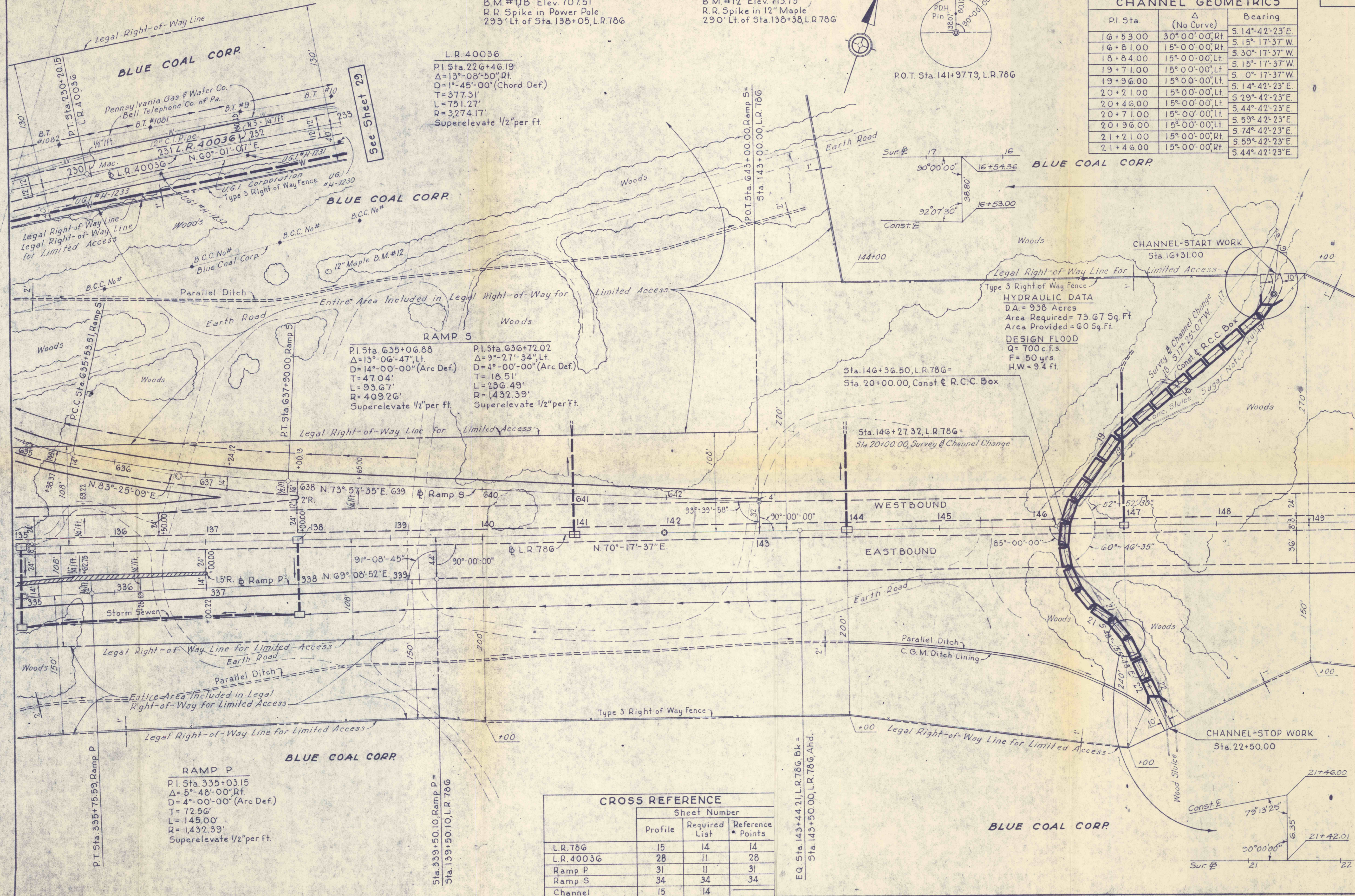

See Sheet 29

L.R. 40036
P.I. Sta. 226+46.19
Δ = 13°-08'-50" Rt.
D = 1°-45'-00" (Chord Def.)
T = 377.31'
L = 751.27'
R = 3,274.17'
Superelevate 1/2" per ft.

RAMP S
P.I. Sta. 635+06.88
Δ = 13°-06'-47" Lt.
D = 14°-00'-00" (Arc Def.)
T = 47.04'
L = 93.67'
R = 409.26'
Superelevate 1/2" per ft.

P.I. Sta. 636+72.02
Δ = 9°-27'-34" Lt.
D = 4°-00'-00" (Arc Def.)
T = 118.51'
L = 236.49'
R = 1,432.39'
Superelevate 1/2" per ft.

RAMP P
P.I. Sta. 335+03.15
Δ = 5°-48'-00" Rt.
D = 4°-00'-00" (Arc Def.)
T = 72.56'
L = 145.00'
R = 1,432.39'
Superelevate 1/2" per ft.

Profile	CROSS REFERENCE	
	Sheet Number	Reference Points
L.R. 786	15	14
L.R. 40036	28	11
Ramp P	31	11
Ramp S	34	34
Channel	15	14

Align. Book No. 22647, 22656, 23365 & 23367
Topo. Book No. 22632 & 23367