

036

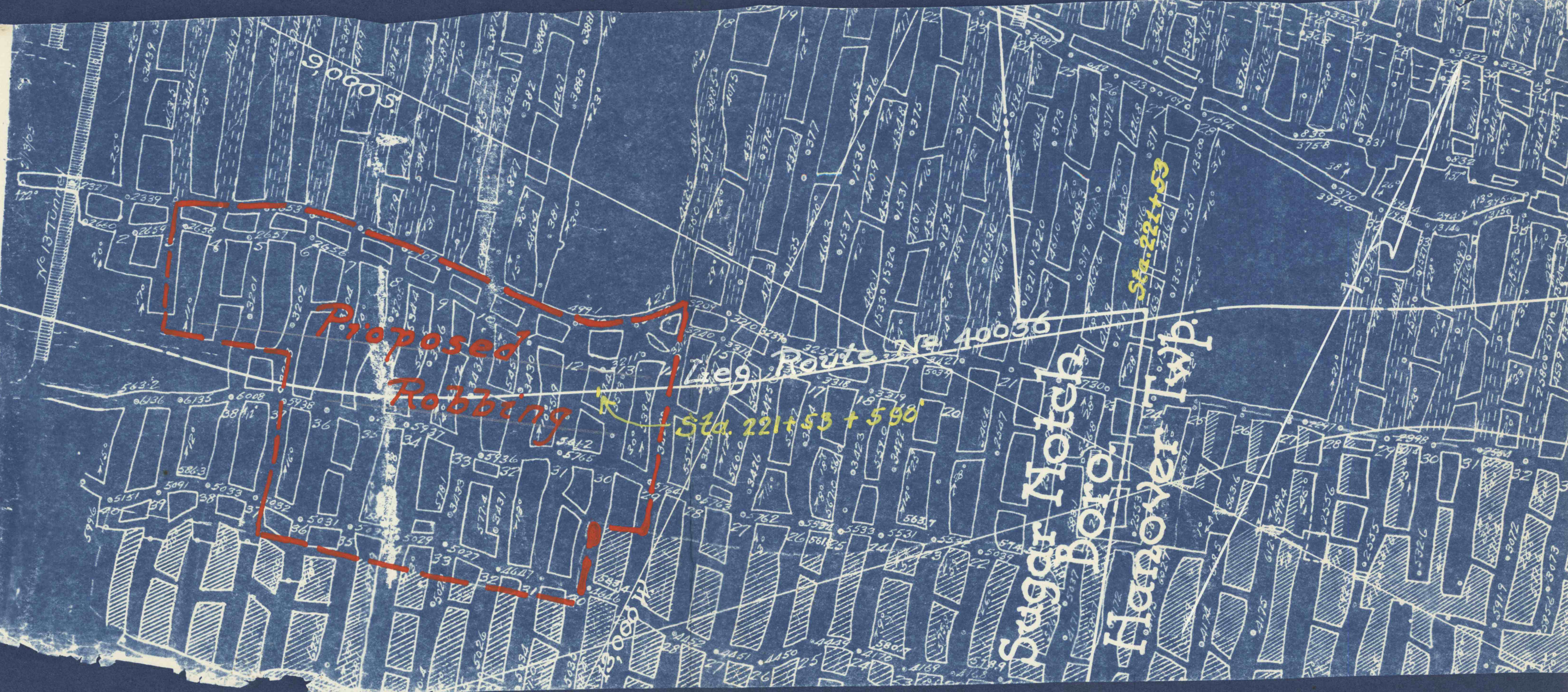

Top Baltimore vein Sugar Notch Colliery
 Glen Alder Corporation Wilkes Barre, Pa. Operator
 Mr. E. T. Powell Mining Eng'r
 Mr. J. J. Zimmerman Supt Sugar Notch Colliery
 Supt. Colliery
 Scale 1"=100' Date Jan. 30, 1956