

CENTRAL RAILROAD  
B.M. 7342  
SURF. ELEV. 1660.8

LEHIGH VALLEY  
RAILROAD  
+664.0

CHESTNUT ST.  
W.D. & W.B. R.W.Y.  
+693.0

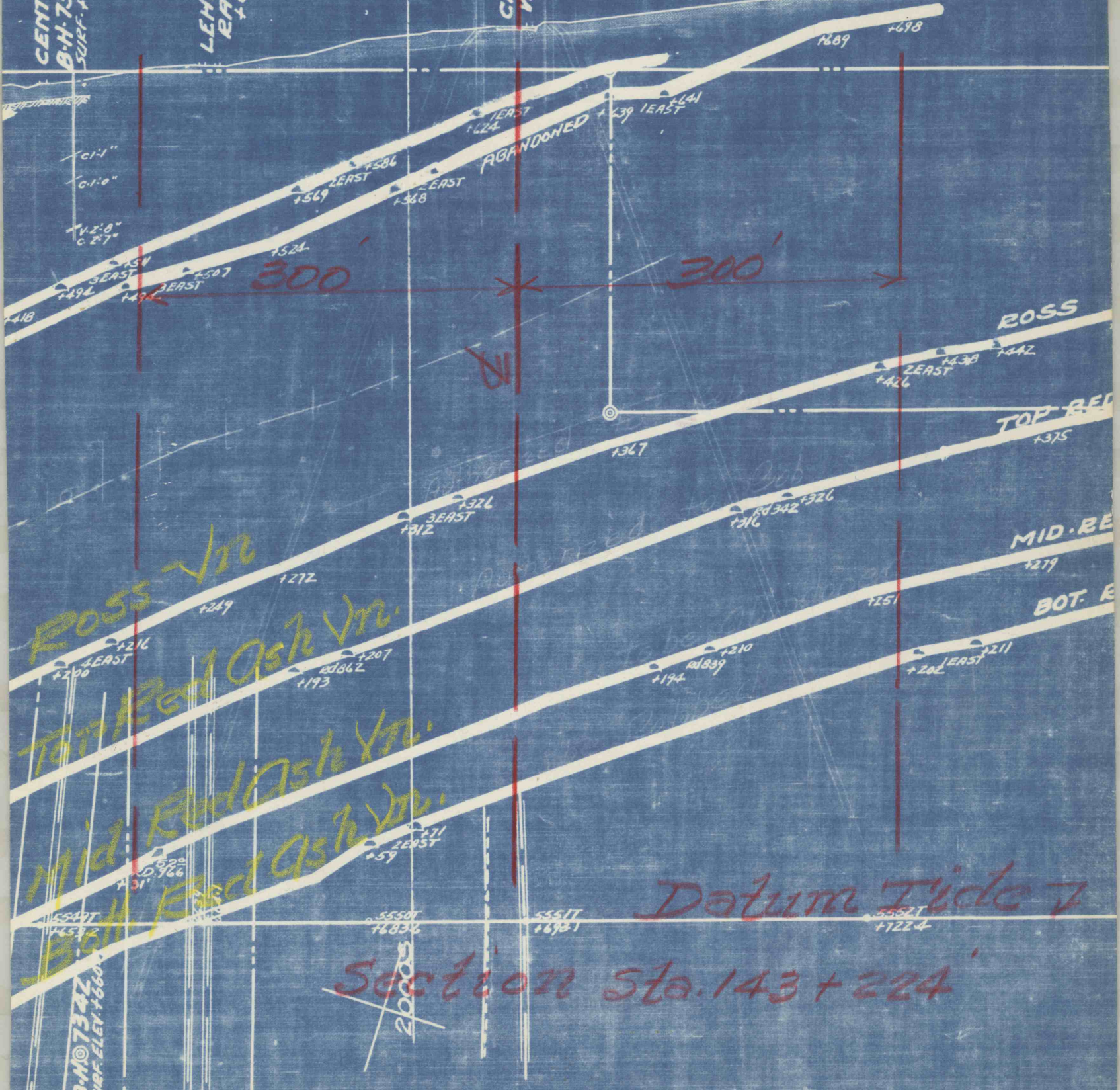

ROSS ~ 1/2 in.  
 TOP BED ~ 1/2 in.  
 MID. BED ~ 1/2 in.  
 BOT. BED ~ 1/2 in.

Datum Tide 7

Section Sta. 143 + 224'

B.M. 7342  
SURF. ELEV. 1660.8

2000