

Depth-730'

← Pillars in this area to be removed

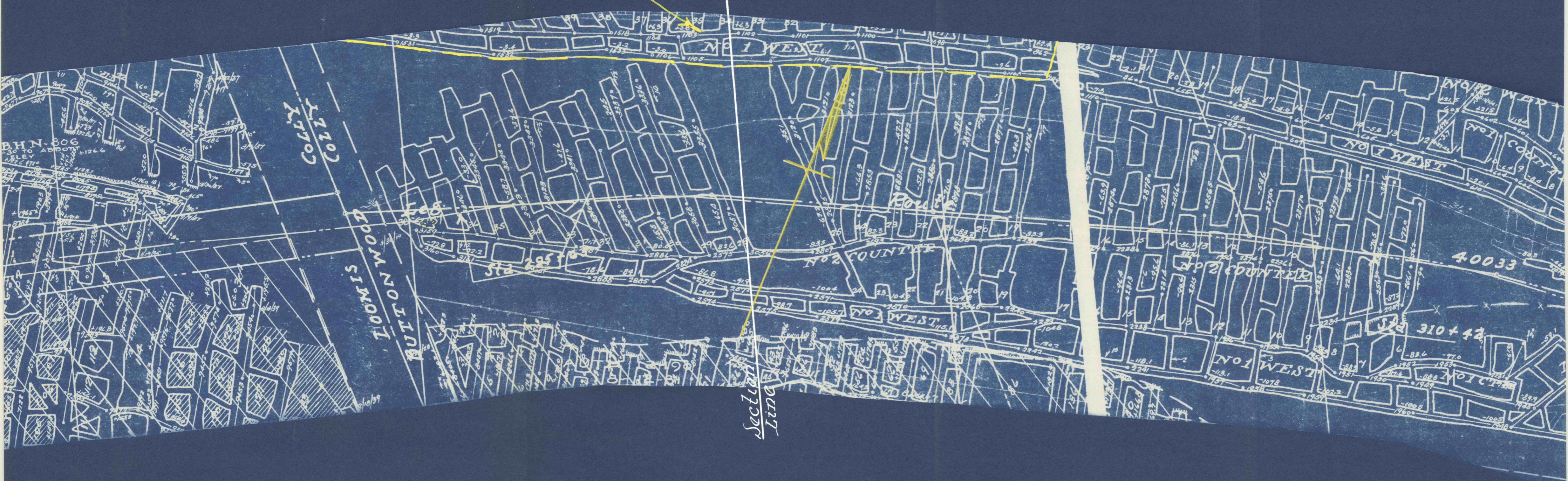

*Kidney* Vein *Buttonwood* Colliery  
Glen Alden Coal Co., Scranton, Pa., Operator  
*A.H. Lewis* Mining Engr., Southern Division  
*H.Goulston* Supt. *Buttonwood* Colliery  
Supt. \_\_\_\_\_ Colliery  
Scale 1" = 100' Date *Jan. 1943*