

-B.M.-
Spike in Base of 16" Apple
39' Lt. of Sta. 45+70
Elev. 1015.00

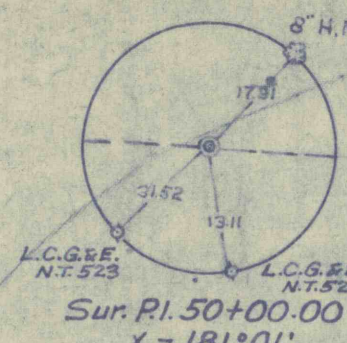

-B.M.-
Spike in Base of 10" Apple
35' Lt. of Sta. 56+55
Elev. 976.67

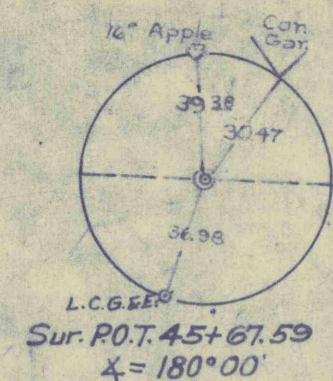
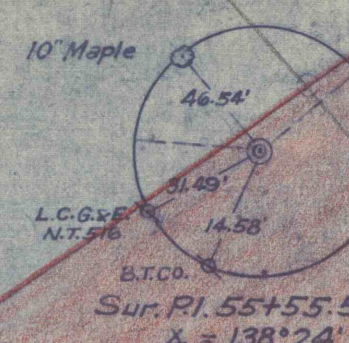

Newport Twp.

REQUIRED LIST

- STATE PORTION
- Sta. 54+65 to Sta. 55+70 Rt.
115 L.F. Reset Curb
See Sketch on Sheet #2
 - Sta. 54+65 to Sta. 56+65 Lt.
180 L.F. Reset Curb
See Sketch on Sheet #2
 - Sta. 54+65 Lt.
1 C.Y. Emb. Block Exist. Inlet
 - Sta. 54+65 to Sta. 57+85
100 C.Y. C.I. Exc. Old Pave Removal
 - Sta. 54+65 to Sta. 56+65 Intersection
792 S.Y. 2 1/2" Bit Surf Crse. 1D-2
 - 792 S.Y. 10" Cr. Aggr. Base Crse. "B"
 - Sta. 54+65 to Sta. 56+65
High Point in Crown to be Shifted Left
See Cross Sections
 - Sta. 55+28 Lt.
1-Type "F" Inlet
 - Sta. 55+42
40 L.F. 12" C.I. Pipe
9 C.Y. C.I. 2 Exc. (Pipe)
(Connect Between New Inlets)
 - Sta. 55+50 Rt.
1-Type "F" Inlet
 - Sta. 55+65 to Sta. 57+20 Rt.
165 L.F. Reset Curb
See Sketch on Sheet #2
 - Sta. 55+75 Intersection Rt.
Either 7 Tons Bit Surf Crse. 1D-2 (Stone Aggr.)
or 6 Tons Bit Surf Crse. 1D-2 (Slag Aggr.)
8 C.Y. Cr. Aggr. Base Crse. "A"
5 C.Y. Emb.
See Sketch on Sheet #2
 - Sta. 56+25 Lt.
5 C.Y. C.I. Exc. (Drive)
 - Sta. 56+50 Lt.
10 C.Y. C.I. Exc. (Drive)
 - Sta. 56+65 to Sta. 64+12 Lt.
477 S.Y. Pl. Cam. Conc. Curb Gutter
Type "B" (5.0" Water Table)
112 C.Y. C.I. Exc.
 - Sta. 56+51 to Sta. 57+85 Inter. Rt.
175 S.Y. 2 1/2" Bit Surf Crse. 1D-2
 - 175 S.Y. 10" Cr. Aggr. Base Crse. "B"
76 C.Y. C.I. Exc.
3 C.Y. Emb.
 - Sta. 57+80 to Sta. 58+00 Rt.
32 L.F. Reset Curb
See Sketch on Sheet #2
 - Sta. 58+00 to Sta. 63+67 Rt.
363 S.Y. Pl. Cam. Conc. Curb Gutter
Type "B" (5.0" Water Table)
93 C.Y. C.I. Exc.
- ~ENTIRE PROJECT~
Sta. 54+65.00 to Sta. 75+81.75
500 L.F. 6" Udrain Type II Backfill
50 L.F. 6" Udrain Outlets
500 L.F. Subgrade Drains
2 Tons Calcium Chloride (For Dust Laying)
- "As Directed"

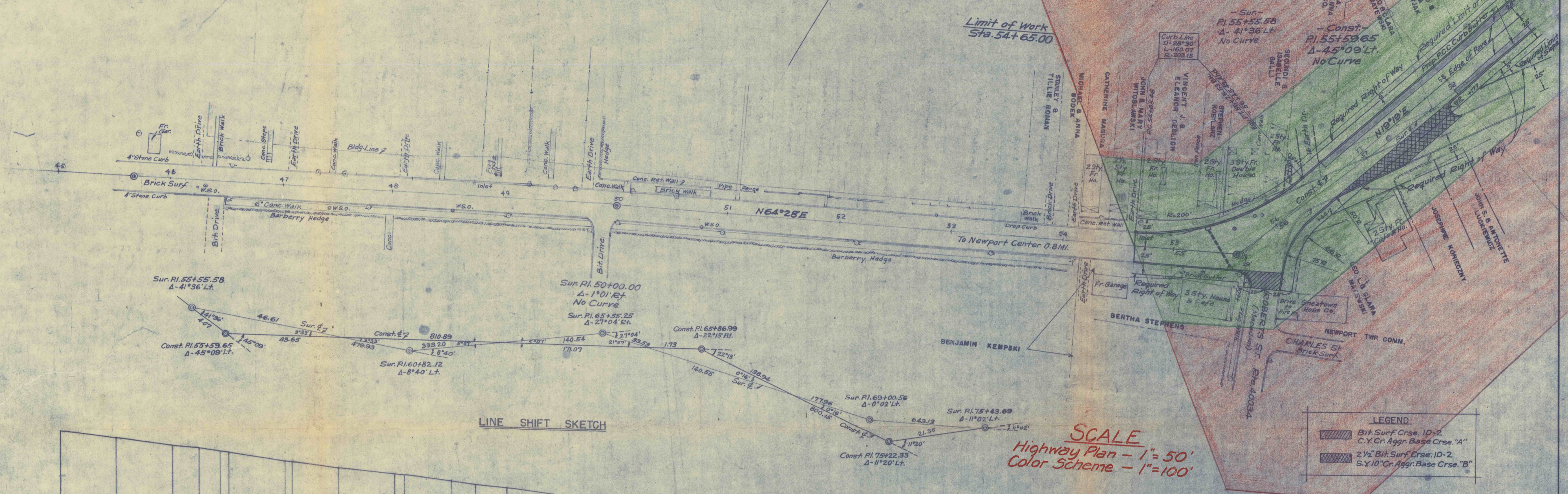

LINE SHIFT SKETCH

SCALE
Highway Plan - 1" = 50'
Color Scheme - 1" = 100'

LEGEND

- Bit Surf Crse. 1D-2
- C.Y. Cr. Aggr. Base Crse. "A"
- 2 1/2" Bit Surf Crse. 1D-2
- 5-Y. 10" Cr. Aggr. Base Crse. "B"

LEGEND

- Denotes Area Necessary for Local Road Support for Voids Within 300 Feet of Surface
- Denotes Area Necessary for Local Road Partial Support for All Voids

DATUM = 920

45	46	47	48	49	50	51	52	53	54	55	56	57	58	59	60	61	62	63	64	65	66	67	68	69	70	71	72	73	74	75																																																																																																																																																																																																																																																																																																																																																																																																																																																																																																																																																	
1014.36	1013.12	1011.67	1011.20	1010.71	1010.54	1010.17	1008.38	1007.86	1006.61	1006.37	1005.38	1004.27	1004.05	1002.71	1002.06	1001.60	1001.13	999.21	998.16	995.12	993.22	991.31	989.48	987.43	985.37	983.33	981.29	979.25	977.21	975.17	973.13	971.09	969.05	967.01	964.97	962.93	960.89	958.85	956.81	954.77	952.73	950.69	948.65	946.61	944.57	942.53	940.49	938.45	936.41	934.37	932.33	930.29	928.25	926.21	924.17	922.13	920.09	918.05	916.01	913.97	911.93	909.89	907.85	905.81	903.77	901.73	899.69	897.65	895.61	893.57	891.53	889.49	887.45	885.41	883.37	881.33	879.29	877.25	875.21	873.17	871.13	869.09	867.05	865.01	862.97	860.93	858.89	856.85	854.81	852.77	850.73	848.69	846.65	844.61	842.57	840.53	838.49	836.45	834.41	832.37	830.33	828.29	826.25	824.21	822.17	820.13	818.09	816.05	814.01	811.97	809.93	807.89	805.85	803.81	801.77	799.73	797.69	795.65	793.61	791.57	789.53	787.49	785.45	783.41	781.37	779.33	777.29	775.25	773.21	771.17	769.13	767.09	765.05	763.01	760.97	758.93	756.89	754.85	752.81	750.77	748.73	746.69	744.65	742.61	740.57	738.53	736.49	734.45	732.41	730.37	728.33	726.29	724.25	722.21	720.17	718.13	716.09	714.05	712.01	709.97	707.93	705.89	703.85	701.81	699.77	697.73	695.69	693.65	691.61	689.57	687.53	685.49	683.45	681.41	679.37	677.33	675.29	673.25	671.21	669.17	667.13	665.09	663.05	661.01	658.97	656.93	654.89	652.85	650.81	648.77	646.73	644.69	642.65	640.61	638.57	636.53	634.49	632.45	630.41	628.37	626.33	624.29	622.25	620.21	618.17	616.13	614.09	612.05	610.01	607.97	605.93	603.89	601.85	599.81	597.77	595.73	593.69	591.65	589.61	587.57	585.53	583.49	581.45	579.41	577.37	575.33	573.29	571.25	569.21	567.17	565.13	563.09	561.05	559.01	556.97	554.93	552.89	550.85	548.81	546.77	544.73	542.69	540.65	538.61	536.57	534.53	532.49	530.45	528.41	526.37	524.33	522.29	520.25	518.21	516.17	514.13	512.09	510.05	508.01	505.97	503.93	501.89	499.85	497.81	495.77	493.73	491.69	489.65	487.61	485.57	483.53	481.49	479.45	477.41	475.37	473.33	471.29	469.25	467.21	465.17	463.13	461.09	459.05	457.01	454.97	452.93	450.89	448.85	446.81	444.77	442.73	440.69	438.65	436.61	434.57	432.53	430.49	428.45	426.41	424.37	422.33	420.29	418.25	416.21	414.17	412.13	410.09	408.05	406.01	403.97	401.93	399.89	397.85	395.81	393.77	391.73	389.69	387.65	385.61	383.57	381.53	379.49	377.45	375.41	373.37	371.33	369.29	367.25	365.21	363.17	361.13	359.09	357.05	355.01	352.97	350.93	348.89	346.85	344.81	342.77	340.73	338.69	336.65	334.61	332.57	330.53	328.49	326.45	324.41	322.37	320.33	318.29	316.25	314.21	312.17	310.13	308.09	306.05	304.01	301.97	299.93	297.89	295.85	293.81	291.77	289.73	287.69	285.65	283.61	281.57	279.53	277.49	275.45	273.41	271.37	269.33	267.29	265.25	263.21	261.17	259.13	257.09	255.05	253.01	250.97	248.93	246.89	244.85	242.81	240.77	238.73	236.69	234.65	232.61	230.57	228.53	226.49	224.45	222.41	220.37	218.33	216.29	214.25	212.21	210.17	208.13	206.09	204.05	202.01	199.97	197.93	195.89	193.85	191.81	189.77	187.73	185.69	183.65	181.61	179.57	177.53	175.49	173.45	171.41	169.37	167.33	165.29	163.25	161.21	159.17	157.13	155.09	153.05	151.01	148.97	146.93	144.89	142.85	140.81	138.77	136.73	134.69	132.65	130.61	128.57	126.53	124.49	122.45	120.41	118.37	116.33	114.29	112.25	110.21	108.17	106.13	104.09	102.05	100.01	97.97	95.93	93.89	91.85	89.81	87.77	85.73	83.69	81.65	79.61	77.57	75.53	73.49	71.45	69.41	67.37	65.33	63.29	61.25	59.21	57.17	55.13	53.09	51.05	49.01	46.97	44.93	42.89	40.85	38.81	36.77	34.73	32.69	30.65	28.61	26.57	24.53	22.49	20.45	18.41	16.37	14.33	12.29	10.25	8.21	6.17	4.13	2.09	0.05	-1.99	-3.96	-5.92	-7.88	-9.84	-11.80	-13.76	-15.72	-17.68	-19.64	-21.60	-23.56	-25.52	-27.48	-29.44	-31.40	-33.36	-35.32	-37.28	-39.24	-41.20	-43.16	-45.12	-47.08	-49.04	-51.00	-52.96	-54.92	-56.88	-58.84	-60.80	-62.76	-64.72	-66.68	-68.64	-70.60	-72.56	-74.52	-76.48	-78.44	-80.40	-82.36	-84.32	-86.28	-88.24	-90.20	-92.16	-94.12	-96.08	-98.04	-100.00