

M.A. HANNA CO.
Wooded

SURVEY & Right of Way DATA
P.I. Sta. 70+49.08
 $\Delta = 9^{\circ} 23' 00''$ Rt.
 $D = 1^{\circ} 30'$
 $T = 313.47'$
 $L = 625.56'$
 $R = 3,819.83'$
S.E. = $1/4$ per ft.

P.I. Sta. 70+49.08
 $\Delta = 189^{\circ} 23' 00''$

P.T. Sta. 73+61.16
 $\Delta = 180^{\circ} 00'$

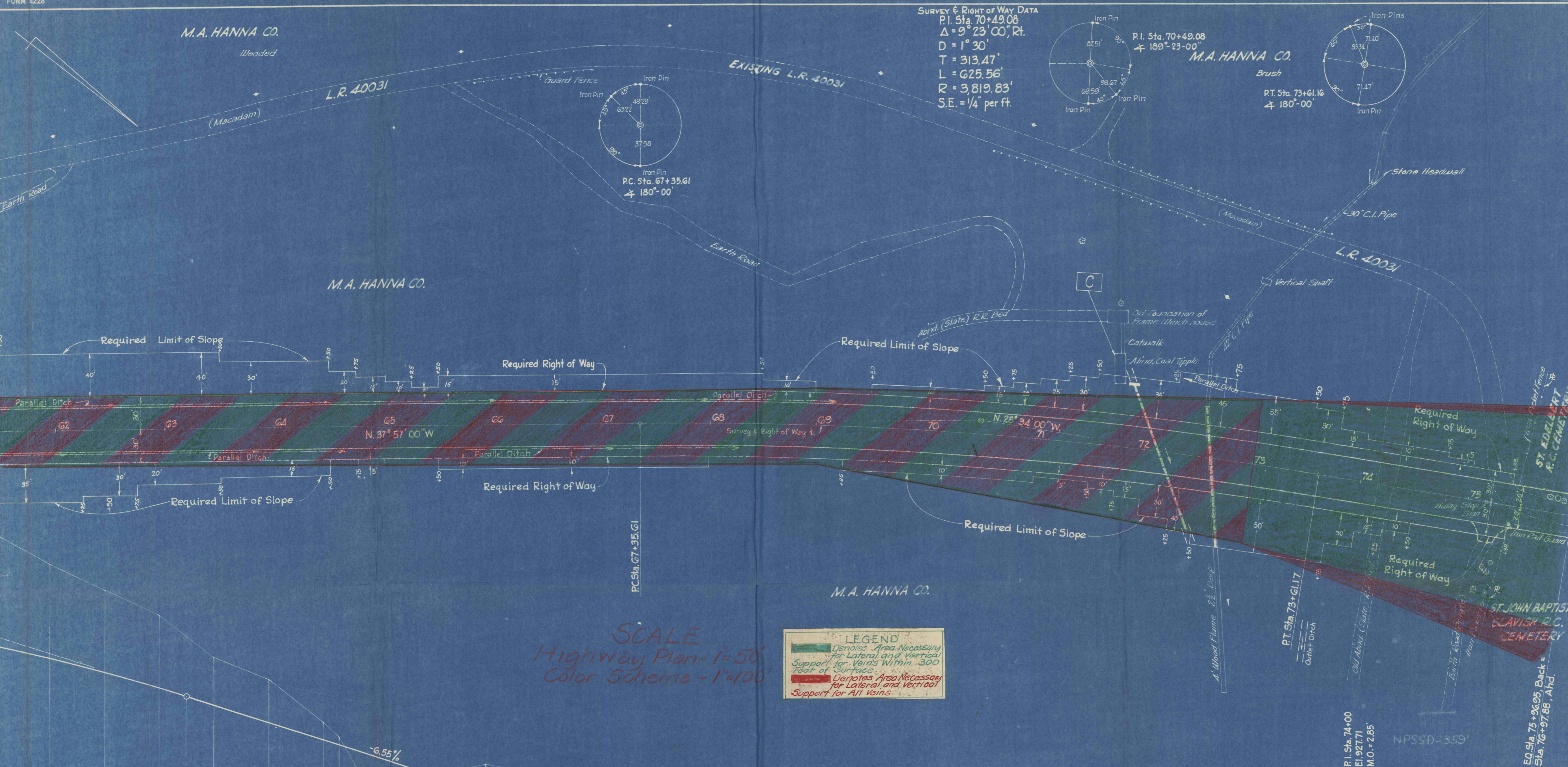

SCALE
Highway Plan - 1"=50'
Color Scheme - 1"=100'

LEGEND

- Denotes Area Necessary for Lateral and Vertical Support for Voids Within 300 Feet of Surface.
- Denotes Area Necessary for Lateral and Vertical Support for All Voids.

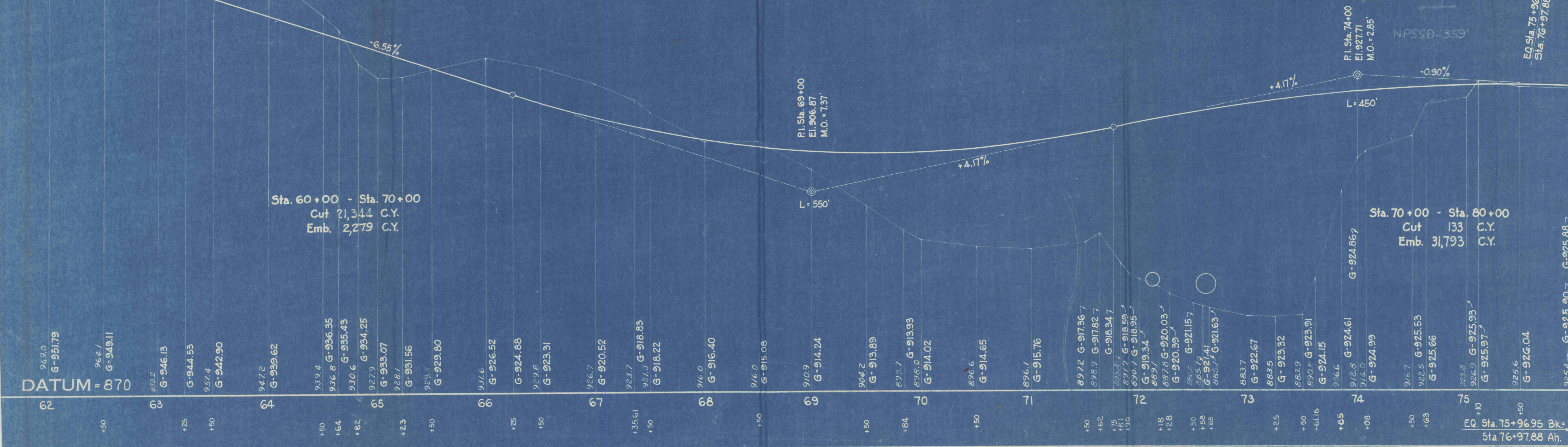

Sta. 60+00 - Sta. 70+00
Cut 21,344 C.Y.
Emb. 2,279 C.Y.

Sta. 70+00 - Sta. 80+00
Cut 133 C.Y.
Emb. 31,793 C.Y.

DISTRICT	COUNTY	ROUTE	SEC.	SHEET
4	LUZERNE	40031	5	7 of 15

REQUIRED LIST

- Sta. 72+G1 10 Gauge - Elongated
126 L.F. 42" A.C.C.M. Pipe Fully Coated
3.0 C.Y. Cl. B Conc. (Connections)
160 C.Y. Cl. 2 Exc.
See Special Requirement in Proposal
Max. Fill over Pipe +30'
- Sta. 73+75, Rt.
15 C.Y. Cl. 2 Exc. (Outlet Ditch, 150' Rt.)
- Sta. 72+12
146 L.F. 30" A.C.C.M. Pipe Fully Coated
#12 Gauge
1.0 C.Y. Cl. B Conc. Type D Edw. Lt.
100 C.Y. Cl. 2 Exc. (Pipe & Edws.)
20 C.Y. Cl. 2 Exc. Inlet Ditch Lt.
30 C.Y. Cl. 2 Exc. Outlet Ditch Rt.
- Sta. 72+28 to Sta. 72+65, Lt.
13 C.Y. Cl. 2 Exc. (Par. Ditch) W=18"
- Sta. 75+22, Road, Rt.
11 C.Y. Cl. 1 Exc.
- Sta. 75+50 to Sta. 82+85, Lt.
734 L.F. G" U'drain, Type II Backfill
15 L.F. G" U'drain Outlet
- Sta. 75+50 to Sta. 83+75, Rt.
824 L.F. G" U'drain, Type II Backfill
20 L.F. G" U'drain Outlet
- Sta. 65+75 to Sta. 68+24, Rt.
52 C.Y. Cl. 2 Exc. (Parallel Ditch) W=18"
- Sta. 65+80 to Sta. 67+90, Rt.
171 C.Y. Cl. 1 Exc. (Widened Cut)
- Sta. 68+10 to Sta. 68+20, Rt.
1 C.Y. Cl. 1 Exc. (Widened Cut)

E.O. Sta. 75+96.95 Bk.
Sta. 76+97.88 Ah.